



Adjustable Form Designed for Children Ages 6-10

Box Contains:

- 1 Adjustable Body
- 1 Pole/Floor Base
- 1 Hem Marker
- 3 Legs
- 3 Plastic Caps
- Instructions



Assembling Form

1

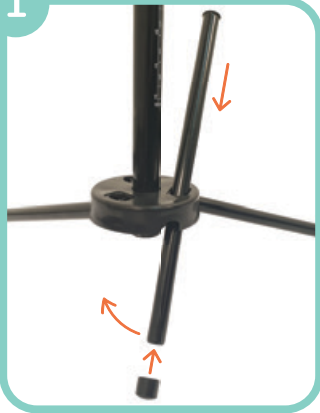

Stand

Insert rounded end of leg into base until flared end is flush with base.
Rotate leg into base slot to lock. Repeat for remaining legs.
Place protective caps on ends of legs.

2

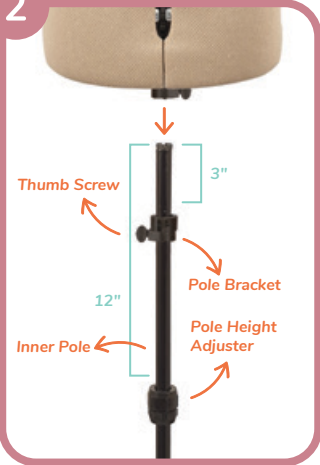

Extending Pole & Attaching Form to Stand

Turn top section of pole height adjuster counter clockwise to loosen.
Extend inner pole 12"; turn adjuster clockwise to tighten.
Loosen thumb screw on pole bracket and slide bracket to 3" from top of pole; tighten screw.
Place form on inner pole.

Adjusting Form to Body Measurements

Important Notes:

- Do not adjust wheels to final measurement all at once.
- All wheels at chest, waist and hips should be adjusted gradually around form to avoid tension that may make a wheel difficult to adjust.
- If you are unable to adjust a wheel, increase adjustments immediately above and/or below wheel releasing tension. Continue making small adjustments to all wheels until all are set to desired measurements.
- Always check measurements with a tape measure.

3

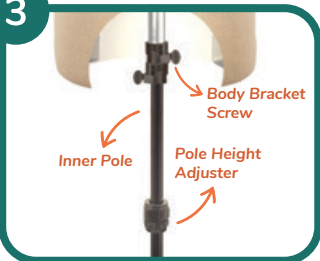

Adjusting Form Height & Securing to Stand

Using pole height adjuster, adjust inner pole to height that matches full body length measurement; tighten adjuster.
Turn body bracket thumb screw to secure to stand and prevent rotation.

4



Adjusting Chest, Waist & Hips

There are 4 adjustment wheels at chest, waist and hips.
Roll wheel down to increase size, and up to decrease. Numbers on right side are inches and left are centimeters. Using body measurements, adjust all 4 wheels to match chest, waist and hip measurements. **Adjust all wheels gradually around and between main areas of form.**

Note: Measurements on wheels should only be used as a guide. Check size with tape measure after adjusting to make fine adjustments as necessary.

5



Adjusting Neck

To enlarge, turn pin cushion knob counter clockwise half a turn.
Gently pull four neck sections away from neck cap until it matches desired neck measurement; tighten knob.
Use knob as pin cushion.

6

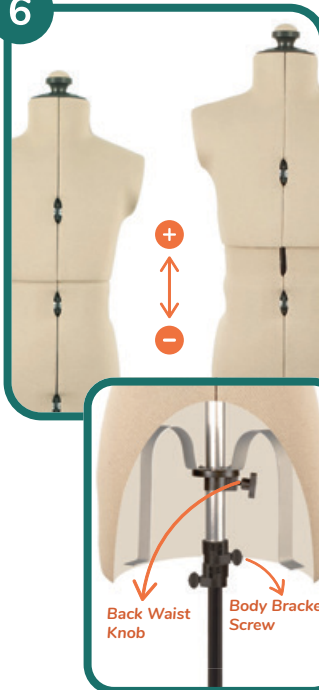

Adjusting Back Waist Length

Loosen thumb screw on body bracket; remove form from pole.
To lengthen, reach into base of form and loosen back waist knob.
On outside, carefully slide apart chest and hip sections of form until base of neck, and natural waistline match back waist length measurement.
Tighten knob. Place form back on pole; tighten body bracket thumb screw.

7

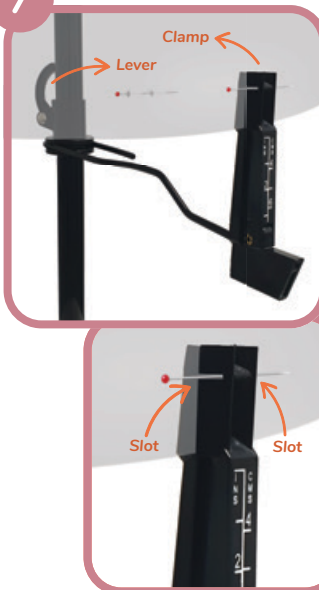

Using Pin Hem Marker

Slide arm of clamp until clamp is aligned with edge of fabric.
Measuring from Waist:
Pull lever down and slide hem marker up or down pole until pin slot falls at desired hem length. Move lever back up; lock into place.
Open clamp; place fabric between clamps and close. Holding clamp, insert straight pin through slot near top of clamp. Open clamp; rotate form and continue to mark every 2". Using row of pins, turn fabric to inside to create hem.
Measuring from Floor:
Numbers on bottom of pole can be used to determine hem height from floor.
Pull lever down and slide hem marker up or down pole until top edge of marker matches desired height from floor; lock into place.

Open clamp; place fabric between clamps and close. Holding clamp, insert straight pin through slot near top of clamp. Open clamp; rotate form and continue to mark every 2". Using rows of pins, turn fabric to inside to create hem.

Taking Body Measurements

Child should wear type of shoes and undergarments they would normally wear. Using a tape measure that does not stretch, pull tape snugly, but not too tight, around fullest part of each body area. Record child's measurements below.

Neck: _____

Measure around base of neck.

Waist: _____

Measure around natural waistline.

Back Waist Length: _____

Measure from prominent bone at base of neck down to natural waistline tied with a cord.

Establish base of child's neck on form by wrapping a cord around it; mark at center back with chalk or pin. This mark corresponds with prominent bone at back of neck and should be about 2" below underside of neck cap.

Chest: _____

Measure straight across widest part of back, under arms and across fullest part of chest.

Note: Select shirt, dress, and jacket or coat pattern size according to chest measurement.

Hips: _____

Measure around fullest part (usually 7" – 9" below waist). Make a note of distance between waist and fullest part of hips.

Note: Select skirt or pants pattern size according to hip measurement.

Full Body Length: _____

At center back, measure from natural waistline to floor, then add Back Waist Length measurement.



Using Form

The form has been designed to accommodate as many varied adjustment needs as possible. There may be occasions when form has been adjusted as closely as possible to match body measurements, but may require additional reshaping.

Padding Form

Determine where padding is needed.

Use foam, fiberfill, batting, or shoulder pads to fill in areas on shoulder, chest, waist, hips, and back that may need adjustments.

Cover padded areas with fabric.

Filling in Section Openings

Making measurement adjustments to form will create openings. Fill in gaps to allow for easier pinning and fitting of pattern and garment.

Apply double-faced tape along lengthwise edges of ribbon or tape; attach strip to fill in openings.

Covering Form

Use a t-shirt or make a cover with stretchy tricot fabric to hide any padding and alterations and create a smooth surface.



As an ongoing policy of development, we reserve the right to make product changes and improvements without notice.

MADE IN ENGLAND FOR
©2019 PRYM CONSUMER USA INC.
950 BRISACK RD.,
SPARTANBURG, SC 29303 USA DRITZ.COM

©2019 IE2000INB