

Tiny Love®

For more developmental information and tips for activities to suit your baby's age and stage, please visit:
www.tinylove.com



©2024 Tiny Love LTD.
www.djgusa.com | (800) 544-1108
www.tinylove.com
Made in CHINA.
Styles and colors may vary.
Dorel Juvenile Group, Inc., 2525 State St.,
Columbus, IN 47201-7494

E2097IS658 0C

Tiny Love®

Garden of Adventures

Luxe Developmental Gymini®

Model Number:
120970E001, TO169HFZ



0-36m

E2097IS658 0C

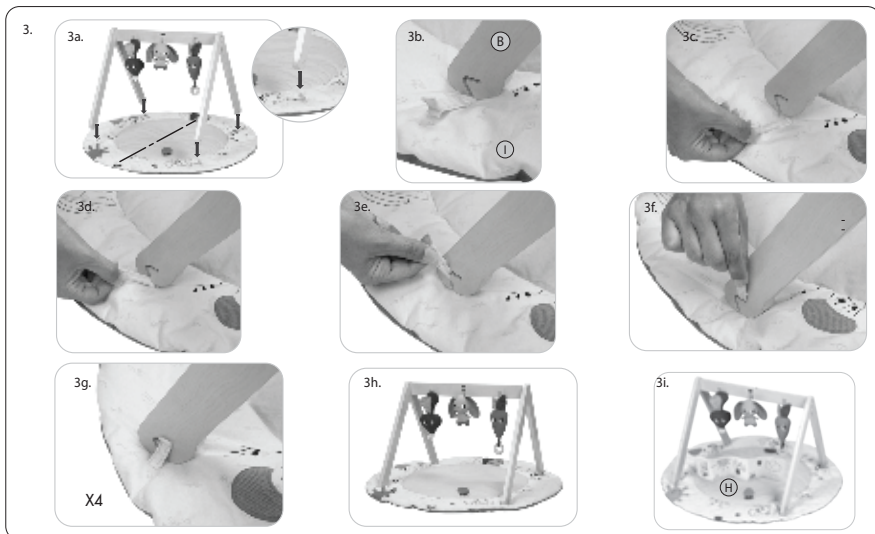
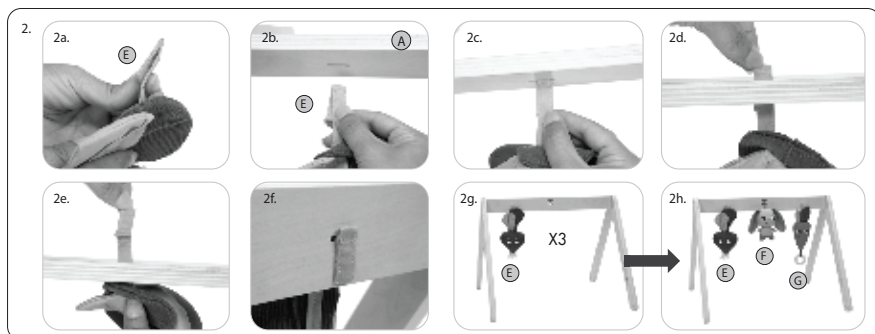
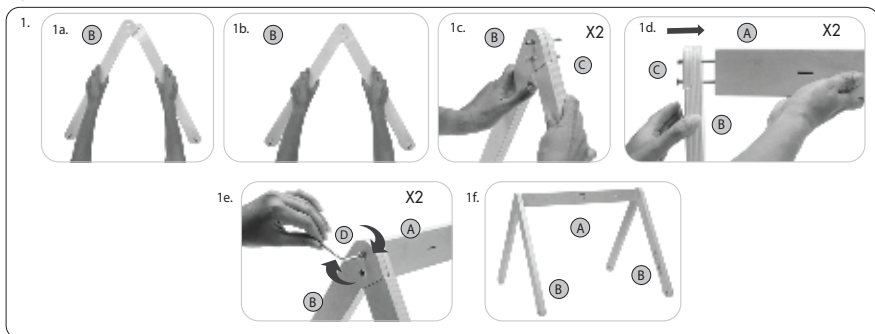
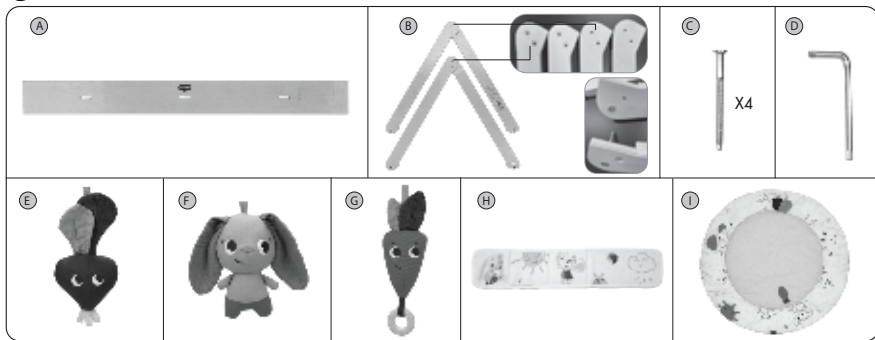

Garden of Adventures Luxe Developmental Gymini®

USER GUIDE

READ THESE INSTRUCTIONS BEFORE USE.
KEEP INSTRUCTIONS FOR FUTURE REFERENCE.

⚠ CAUTION

- Adult assembly required. Hex/Allen key required for assembly (included).
- Never assemble/dismantle while baby is on mat. Always perform these actions away from the baby.
- Do not modify or alter this product in any way.
- Do not allow baby to play with the arches when they are not attached to the mat.
- Stay near and watch baby during use. This product is not safe for sleep or unsupervised use. If baby falls asleep, remove baby as soon as possible and place baby on a firm, flat sleep surface such as a crib or bassinet.
- Remove and discard packaging components before use.
- Do not use this product if it damaged or broken.

Care:

1. Toys: Wipe with a damp cloth.
2. Padded mat: The mat is machine-washable (cold) on gentle cycle. Do not bleach. Do not tumble dry. Line dry only. Do not iron. Do not dry clean. Do not submerge other parts of the product in water.
3. Keep Hex/Allen key for future use. Store out of child's reach.

Do not lean/climb on the bar



⚠ WARNING

USING THIS PRODUCT FOR SLEEP OR NAPS CAN KILL.

Babies can turn over or roll out without warning and CAN SUFFOCATE in only a few minutes.

- **Use on the floor with baby on back, face-up.** Put baby on back after Tummy Time.
- **Stay near and watch baby during use.**
- **Do not use on soft surfaces or in sleep products** like cribs or bassinets. Keep blankets and other soft items out of and away from product.
- If baby falls asleep, move baby to infant sleep product, such as a crib or bassinet.

Babies have been injured from FALLS.

- Do not use on beds, sofas, or other raised surfaces.
- Never carry or move product with baby in it.