

**EVERY
THING
YOU NEED
TO KNOW
ABOUT YOUR**



XOG36PANTRY

36" Sealed Pantry

I worked really hard
on this manual -
so please read it...



IMPORTANT SAFETY INSTRUCTIONS

Do not remove any permanently affixed labels, warnings or plates from this product. Doing so may void warranty.

To the consumer, please make this information available to the people installing the product. Doing so can assist in speeding installation and reducing costs.

To the installer(s), leave these instructions with the customer for future reference and for use by local inspectors.

Improper installation may invalidate warranty or liability claims and prevent proper operation of the pantry.

Any service to the appliance should be performed by qualified personnel using only factory original replacement parts.

The cavity where the appliance is to be installed must be square, level and plumb and free of any obstructions such as support members, wiring or plumbing.

Never store or use gasoline or other flammable vapors or liquids either inside or in the vicinity of this or any other appliance.

Do not store LP cylinders either inside or in the vicinity of this appliance.

WARNING - CUT HAZARD!

PANEL EDGES MAY BE SHARP - FAILURE TO USE CAUTION MAY RESULT IN INJURY OR CUTS.

WARNING - HEAVY TEAM LIFT!

USE TWO OR MORE PEOPLE TO LIFT, MOVE OR POSITION THE UNIT TO HELP AVOID INJURY.

THESE ARE THE MODELS COVERED IN THIS BOOK

XOG36PANTRY

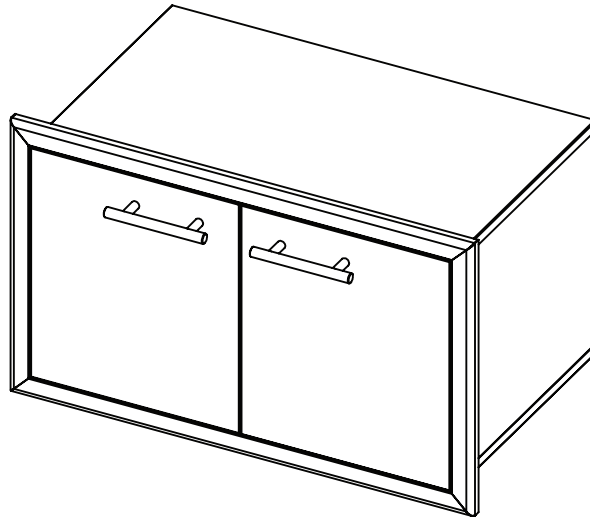

You will need these tools:

- Drill + Bits
- Phillips head screwdriver (#1 or 2)
- Work gloves
- Safety glasses
- Pencil
- Saw
- Tape measure
- Carpenters level
- Framing square
- Hammer
- Fasteners (for framing)

UNPACKING | DOOR HANDLE ASSEMBLY

AFTER YOUR UNIT ARRIVES, CAREFULLY UNPACK THE UNIT AND INSPECT FOR ANY DAMAGE THAT MAY HAVE RESULTED IN TRANSIT.

REMEMBER TEAM LIFT

PLEASE DISPOSE OF ALL PACKING MATERIALS RESPONSIBLY.

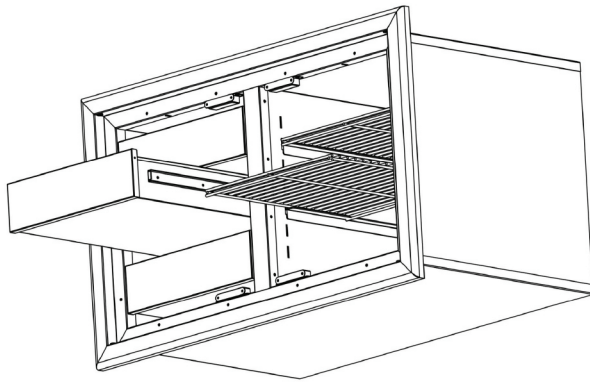

SHOWN WITH DOORS REMOVED
TO REVEAL ADJUSTABLE SHELVES
& THREE SOFT CLOSE DRAWERS

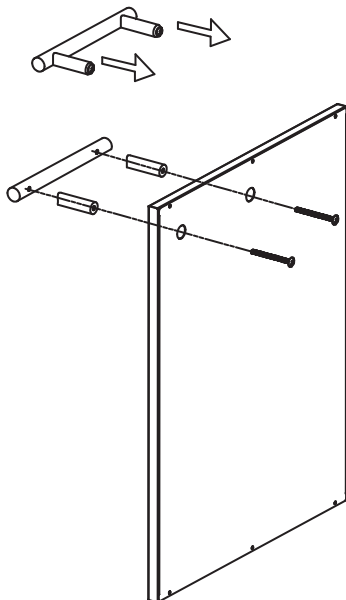

USING THE SCREWS PROVIDED,
ATTACH THE DOOR HANDLES TO
THE TWO PANTRY DOORS.

PRODUCT DIMENSIONS

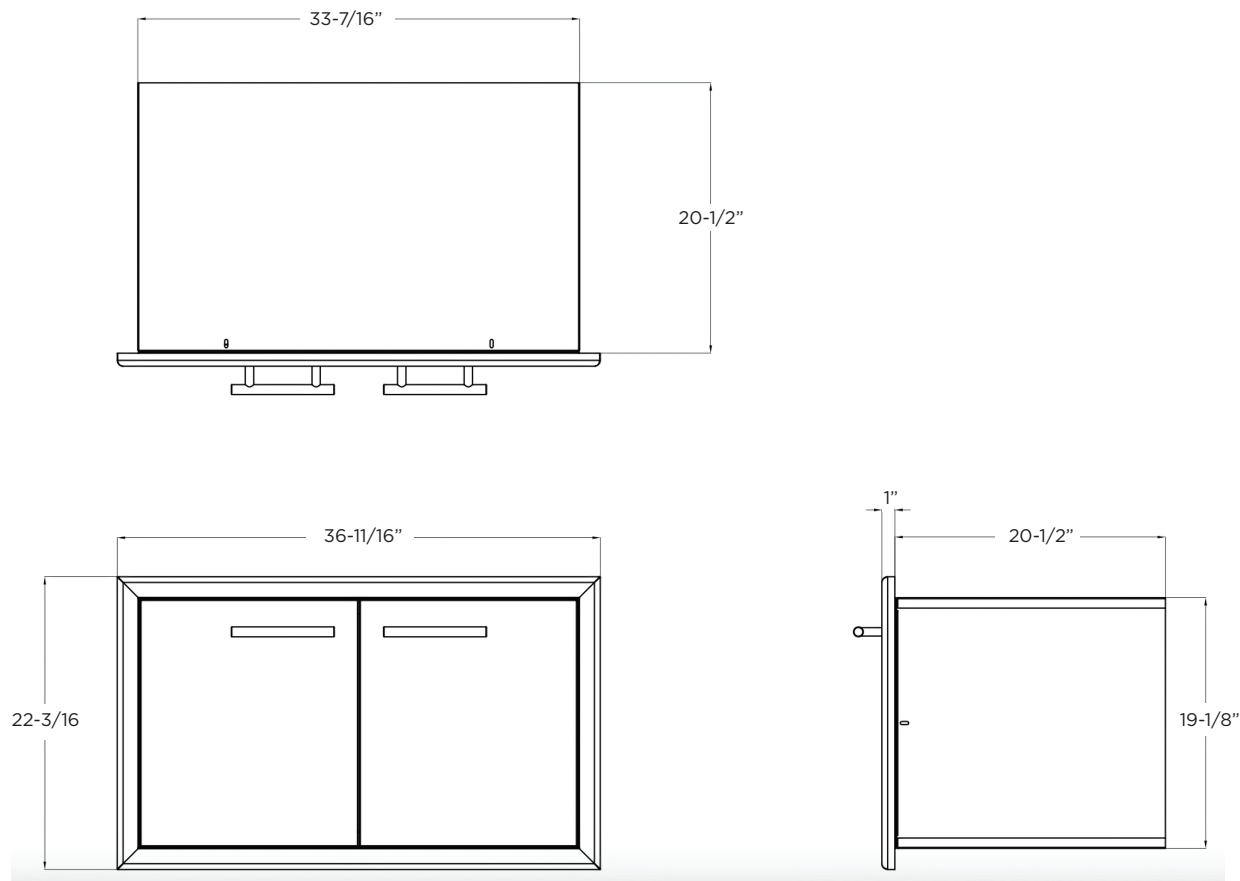

CUT OUT DIMENSIONS

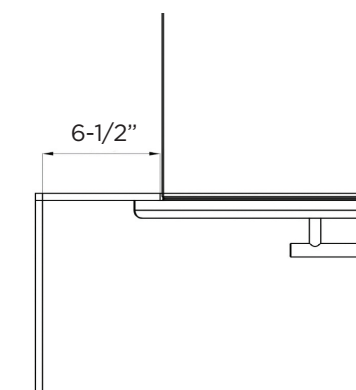

If installing in a corner- leave $6\frac{1}{2}"$ to the turn to avoid interference with other appliances.

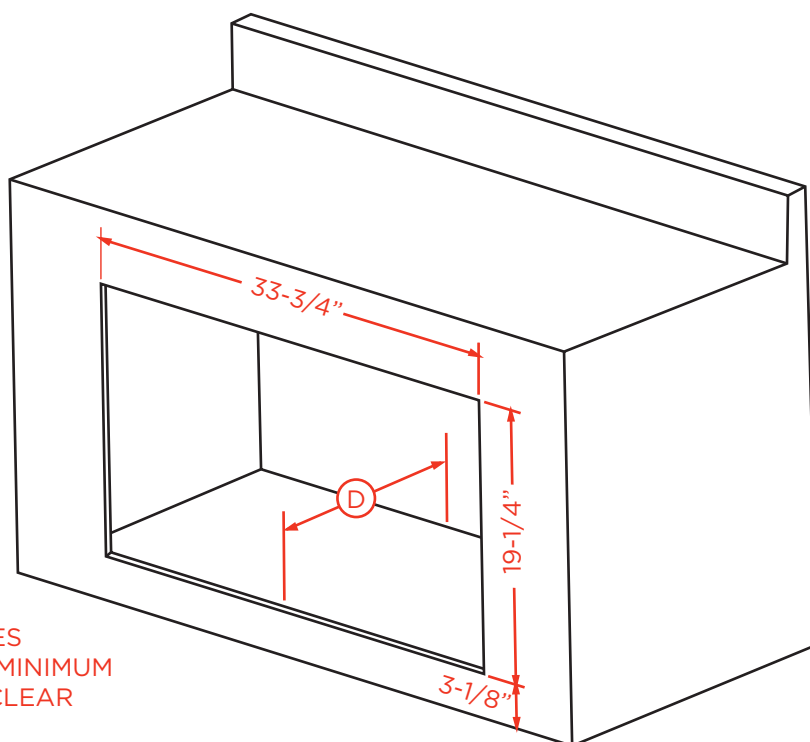

D REQUIRES $20\frac{5}{8}"$ MINIMUM DEPTH CLEAR

PARTS

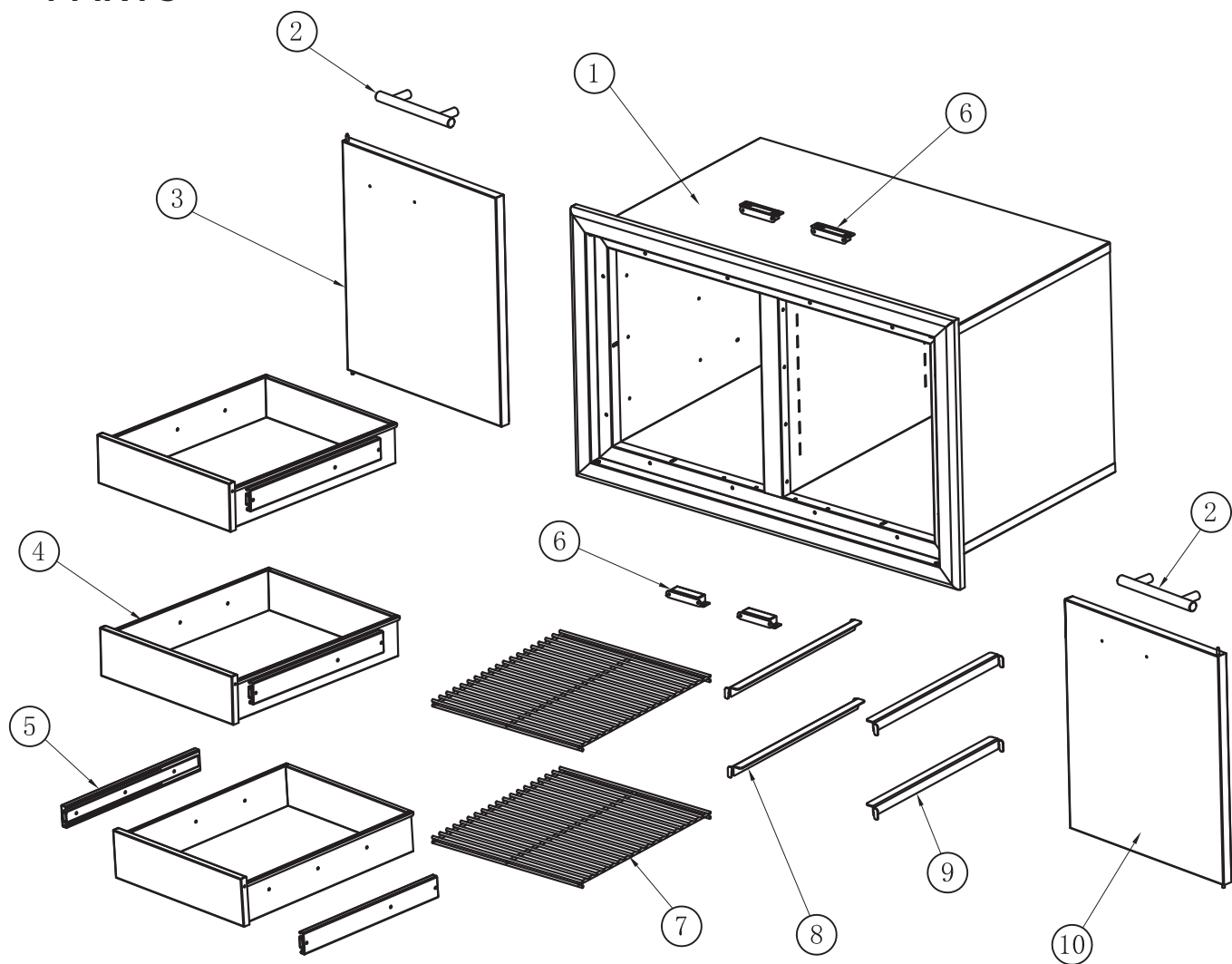

XOG36PANTRY

Item #	Description	Part #	Qty
1	Cabinet Body	XOPG241	1
2	Handle	XOPG009	2
3	Left Door	XOPG242	1
4	Drawer	XOPG243	3
5	Slide Rail	XOPG244	3 Pairs
6	Door Magnet	XOPG152	4
7	Rack	XOPG245	2
8	Left Bracket	XOPG246	2
9	Right Bracket	XOPG247	2
10	Right Door	XOPG248	1

SITE PREPARATION | INSTALLATION

The cabinet must be plumb, level and square. Sleepers must support pantry weight fully loaded.

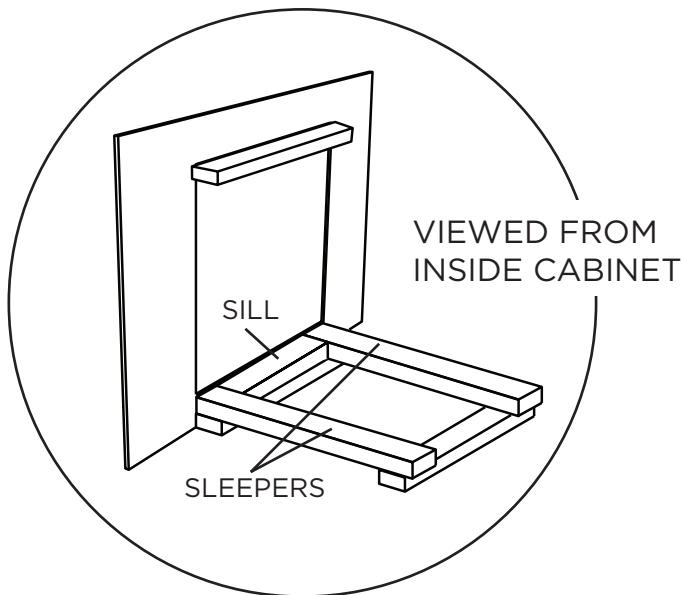

ATTACH SLEEPER
ABOVE CUTOUT

SET & LEVEL
TWO SLEEPERS
& FRONT SILL
EVEN WITH
THE CUT OUT

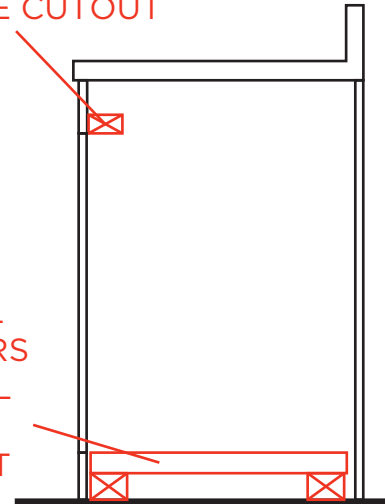

WITH TWO PEOPLE ALIGN THE PANTRY
WITH THE OPENING AND SLIDE INTO
PLACE.

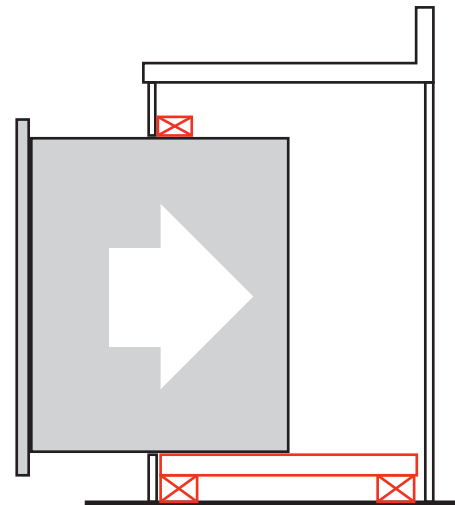

ONCE FIT IS ASSURED
PUSH ALL THE WAY INTO THE OPENING
UNTIL FLANGE IS SEATED.

DO NOT USE SILCON OR OTHER SEALANT
IN CASE UNIT MUST BE REMOVED LATER.

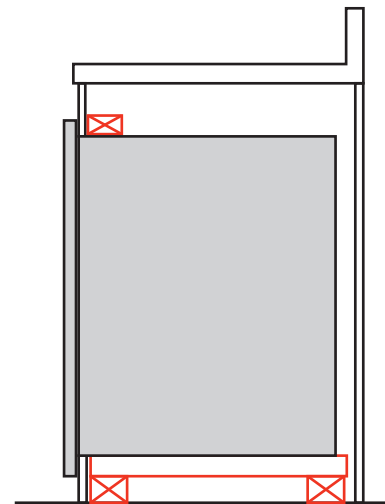

SECURING THE PANTRY

Remove the shelves and drawers to provide access to the attachment screw holes.

To remove a drawer, extend it fully.

On either side of the slides are plastic triangular levers.

At the same time:

While holding the right side lever up and the left side lever down - Pull the drawer out.

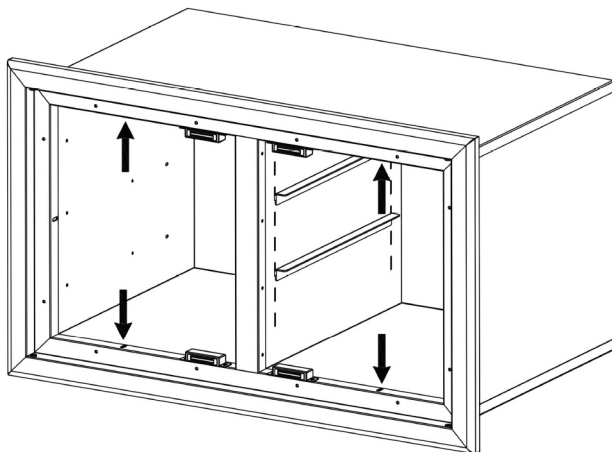
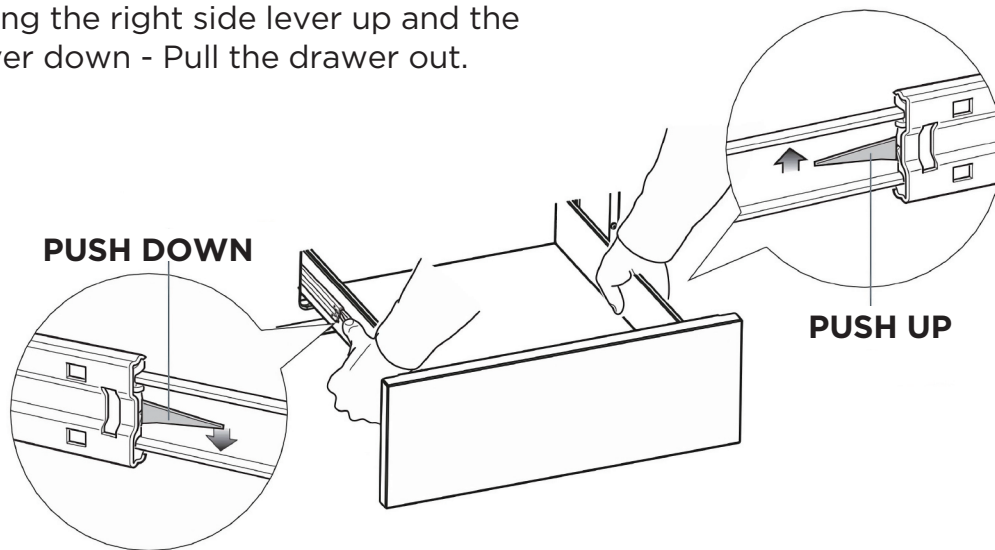

With the drawers and shelves removed, after the pantry has been inserted into the cut out, attach to the upper and lower sleepers using 4 screws in the locations shown.

After the pantry is secured in place reinstall the drawers and you are done.