





SAVANT

Savant® Touch 5.5 Inch Control Screen [ITP-E5500V2x] Quick Reference Guide

Box Contents

- (1) Touch 5.5 Inch Control Screen (ITP-E5500V2x-xx)
- (1) Installation Kit (075-0190-xx0)
 - (1) Mounting Bracket (For standard 1-gang electrical box)
 - (2) Mounting Bracket Screws (6-32 x 1 in.)
- (1) Regulatory Statement (009-1950-xx)

Specifications

Environmental				
Temperature	32° to 104°F (0° to 40°C)			
Humidity	10% to 90% Relative Humidity (non-condensing)			
Dimensions and Weights				
	Device	Shipping		
Height	5.84 in (14.84 cm)	7.25 in (18.41 cm)		
Width	3.44 in (8.74 cm)	4.50 in (11.43 cm)		
Depth	1.33 in (3.38 cm)	2.75 in (6.98 cm)		
	w/ Mounting Bracket	2.33 in (5.91 cm)		
Weight	0.35 lbs (0.16 kg)	0.75 lbs (0.34 kg)		
Power				
Power over Ethernet (PoE)	802.3af compliant			
Power Consumption	Average: 4.6 W Maximum: 5.5 W			
Compliance				
Safety and Emissions	FCC Part 15 	CE 	UKCA 	WEEE 
RoHS	Compliant			
Supported Release				
Savant OS	da Vinci 9.4.5, 10.0.1, and higher			

Network Requirements

For more information, see the [Savant Device Networking Guidelines](#) on the Savant Customer Community.

Device

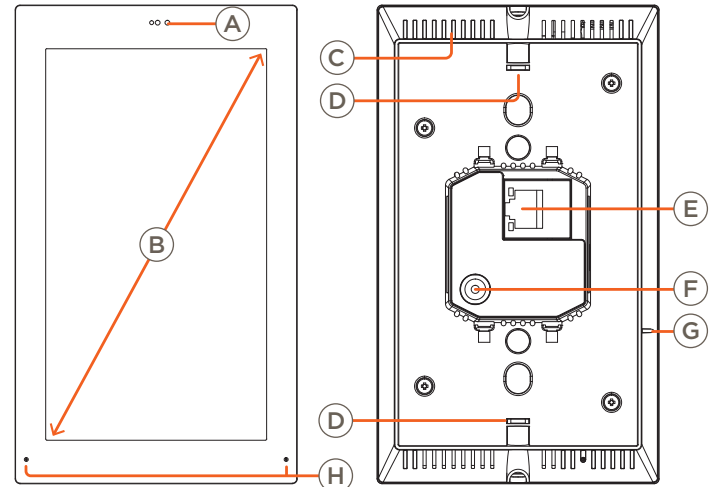

(A) Proximity Sensor	Sensor (proximity) mounted in front panel will wake up the display when movement is detected in front of display. Sensor operating at 940 nm, affective range about 3.28 ft (1 m).
(B) Display	Screen Size: 5.5 in (13.77 cm) Resolution: 1920 x 1080 16.7 M colors
(C) Embedded Speaker	For audio output.
(D) Mounting Slots	Slots for mounting touch panel to mounting bracket. Insert tabs from the mounting bracket into these slots. Once inserted, secure the touch panel to the bracket using the two captive screws.
(E) Ethernet	8-pin RJ-45 port: 10/100/1000 Base-T auto-negotiation port with link and activity LEDs. Link LED Orange - Link is established. Off - No link established Link Activity LED Green Blinking - Indicates data activity. Off - No Activity
(F) Alternate Power Input	Not Used.
(G) Reset Button	Using a paperclip or similar, press and release Reset button to reset the display.
(H) Embedded Microphone	For voice input.

Installation

The Savant 5.5 inch Touch Control Screen is designed to be installed in a single gang configuration.

⚠ IMPORTANT! Box should be oriented using the portrait format (screw holes oriented at top and bottom).

Mount the Bracket

The Savant Touch Control Screen is designed to be mounted using either a standard 1-gang electrical box or low voltage 1-gang bracket.

1. Mount a 1-gang standard electrical box or low voltage bracket to an existing wall. Recommended height to center of box is between 57 and 65 inches (145 - 165 cm) above a finished floor.

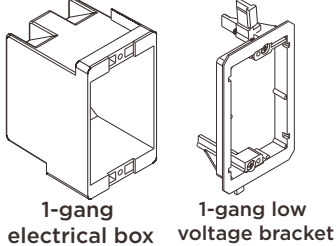

2. Secure the mounting bracket to the electrical box/bracket using the two 6-32 x 1 inch screws provided. Position the touch panel mounting tabs facing outward. See image below.

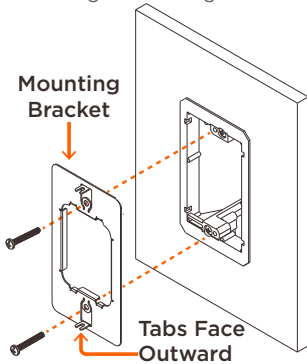

Make Connections

Connect a Cat 5e/6/7 Ethernet cable (T568A, T568B) to the RJ-45 LAN/PoE port on rear of touch panel. See image below.

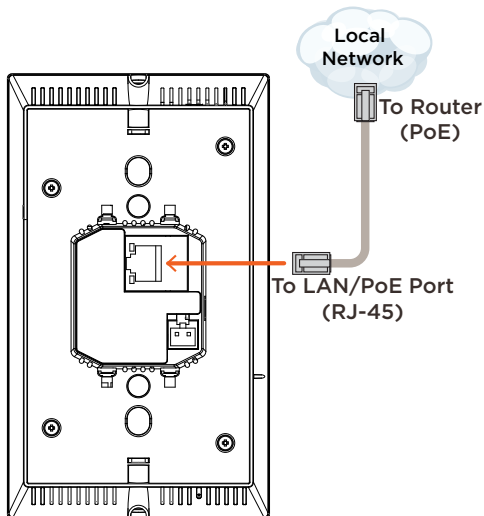

IMPORTANT INFO!

- The touch screen is powered through the Ethernet cable. An 802.3af compliant PoE network router is required to power the display.
- If a PoE network router is not available, a PoE network injector can be used.

Secure Panel to Bracket

Once cables are connected to rear of touch panel, the panel can be secured to the mounting bracket installed earlier.

1. Loosen the captive screws on the top and bottom of the touch panel a few turns to allow the panel to slide into the mounting bracket.
2. Insert the touch panel into the mounting bracket. Ensure the tabs on the mounting bracket are inserted into the appropriate slots in the touch panel.
3. Tighten the two captive screws to secure the touch panel to the mounting bracket.

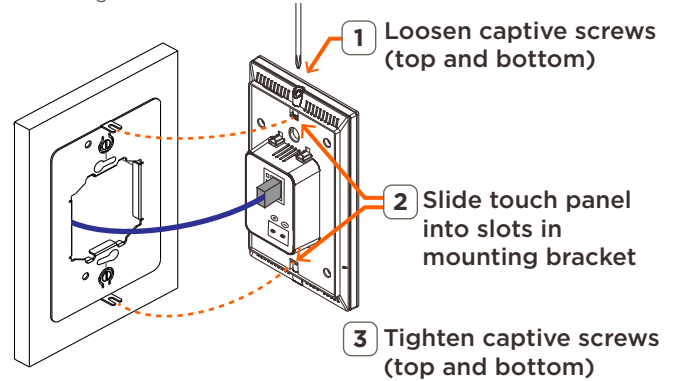

💡 TIP! When installing, the proximity sensor located on the front of the display should be positioned towards the top.

Apply Power

The ITP-E5500V2 touch panel is powered using PoE via Cat 5e/6/7 Ethernet cable. Connect one end of the Ethernet cable to a PoE enabled network switch or router, and the other end to the data connection on the back of the ITP. Once the connection is made, the ITP will be powered on, and an IP address will be automatically assigned via DHCP.

Once the ITP is powered and an IP address has been assigned, the touch panel can be added to a RacePoint Blueprint® configuration. For details, refer to the [Savant Touch Control Screen Deployment Guide \(009-1475-xx\)](#), available on the [Savant Customer Community](#).