

# HYDAPIPE®

## Surface Mounted Shower System

- ☐ **1-902S-FSB:** Through wall piping configuration with soap dish
- ☐ **1-902-FSB:** Through wall piping configuration less soap dish

Pressure Balancing mixing valve with screw driver service stops and adjustable stop screw to limit handle turn. Fre-Flo, all brass, vandal resistant head with ball joint on institutional type head bracket. Levertrol lever diverter with volume control. Wall/hand shower with flexible 5' metal hose with in-line vacuum breaker, wall connection and flange. 30" slide bar for hand shower mounting. Attached soap dish and sloped metal top cap. Stainless steel covering to be 18 gauge with #4 brush finish.

### Modifications:

#### Valve:

- ☐ **Suffix 21:** Single supply, manual shut off, 4 arm handle
- ☐ **Suffix 22:** Single supply, manual shut off, lever handle
- ☐ **Suffix 60:** Single supply, metering shut off (not ADA compliant)

#### Shower head:

- ☐ **Suffix 270:** Fre-Flo, all brass, ball joint, adjustable spray with volume control
- ☐ **Suffix 131:** Super, ball joint, adjustable spray head
- ☐ **Suffix 121:** Super, ball joint, adjustable spray head with volume control
- ☐ **Suffix 285:** Fre-Flo, all brass, fixed spray (no ball joint)
- ☐ **Suffix OWBJ:** One way ball joint
- ☐ **Suffix DSH:** Additional shower head in lieu of hand spray unit

#### Soap dish:

- ☐ **Suffix CWM:** Wall mounted cake soap dish
- ☐ **Suffix RS:** Recessed soap dish <sup>(1)</sup>

#### Hand spray accessories:

- ☐ **Suffix ADAHS:** ADA hand shower wand (white)
- ☐ **Suffix FS:** Hand spray, hose and wall hook (in lieu of Suffix FSB)
- ☐ **Suffix QD:** Quick disconnect for hand spray units
- ☐ **Suffix R:** White vinyl hose in lieu of metal hose
- ☐ **Suffix T36:** 36" slide bar/grab bar with ADA hand shower (white)

#### Seat and Grab bars <sup>(2)</sup>

- ☐ **Suffix HC1:** Slat seat and two wall grab bar (right hand)
- ☐ **Suffix HC2:** Slat seat and two wall grab bar (left hand)
- ☐ **Suffix HC3:** Padded seat and two wall grab bar (right hand)
- ☐ **Suffix HC4:** Padded seat and two wall grab bar (left hand)

#### Notes:

(1) ADA requirements for location of grab bar may obstruct access to recessed soap dish. Wall mounted cake soap dish (CWM) alternative is available.

(2) ADA requirements state that the seat shall be located opposite the controls. This will require the construction of a partial wall, or use of a reinforced partition for mounting the folding seat. Construction of a partial wall or reinforced partition to be provided by others.

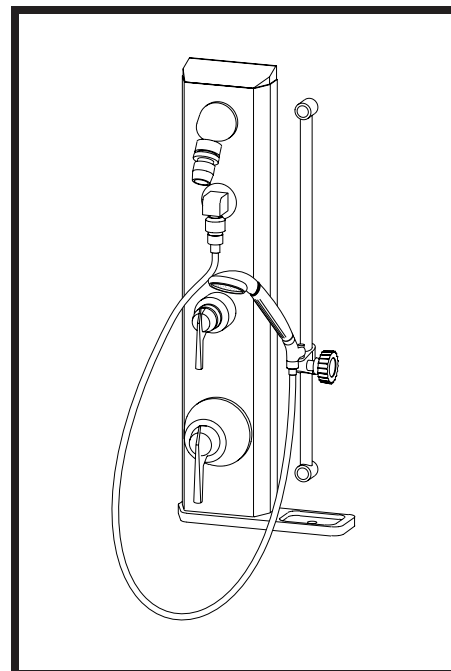

SYMMONS PRODUCTS MEET  
ASME A112.18.1/CSA B125.1  
and flow rate requirements.  
Shower Heads and Hand Showers  
2.5 GPM (9.5 L/min)



#### Job/Location

.....  
.....

#### Engineer

.....  
.....

#### Contractor

.....  
.....

## Dimensions *Hydapipe Shower System with hand shower, 1-902S-FSB*

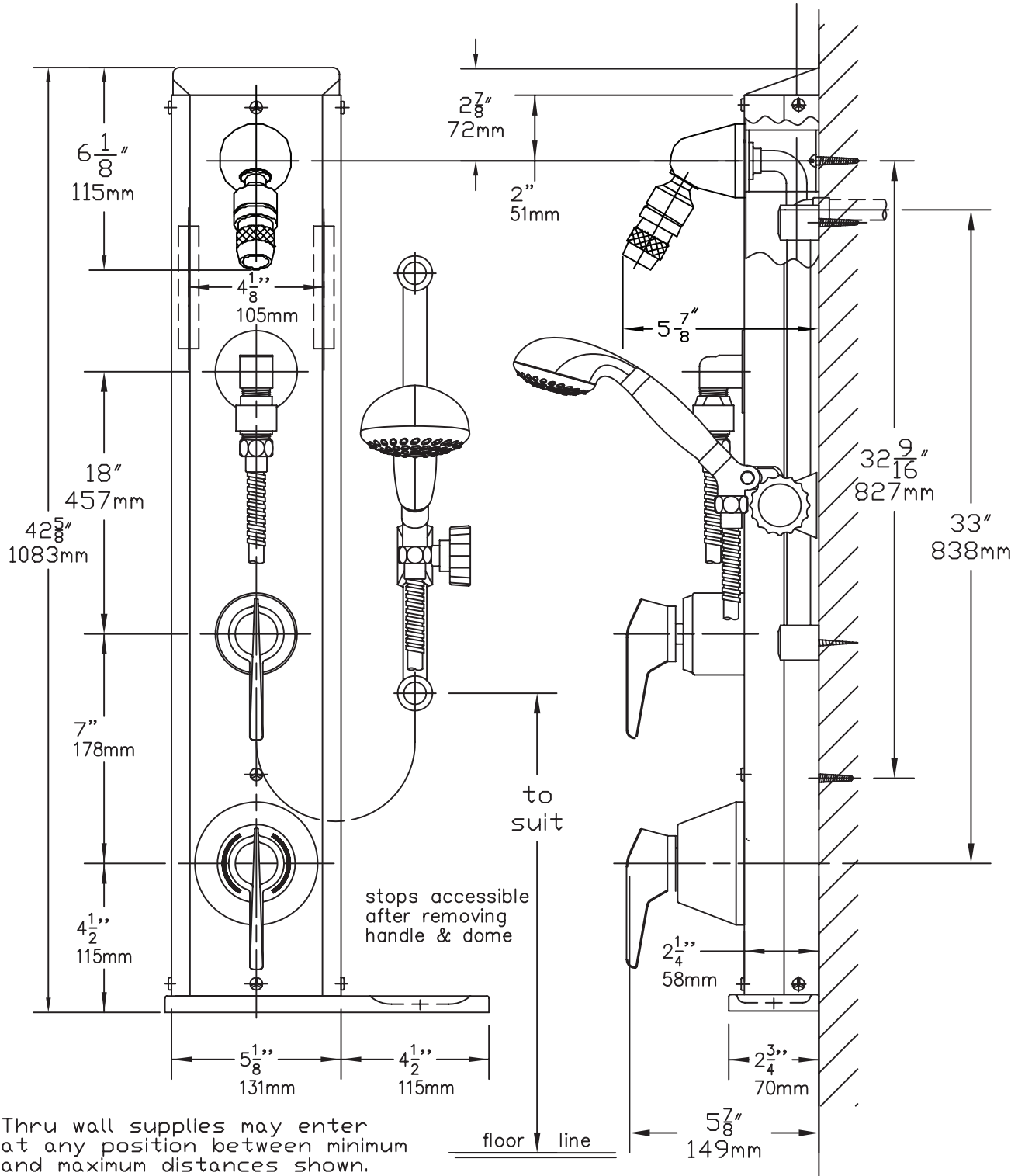

**Note:** Dimensions subject to change without notice.