

# FLEXSTEEL®

## Chair

### IMPORTANT NOTE

Read these instructions carefully and familiarize yourself with each procedure before assembling the furniture. Check that you have all the component parts and familiarize yourself with each part before proceeding.

Take all the fittings out of the plastic bag and separate them into groups. Ensure you have enough space to lay out all the parts before assembly. To prevent damage to the parts, we recommend that you assemble the unit on a soft, level surface.

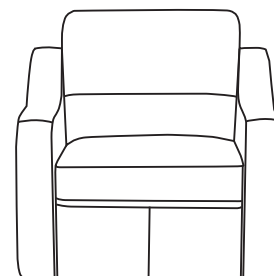

### Part List

A. Back Cushion  
1 piece

B. Seat  
1 piece

C. Leg  
4 pieces

D. Bolt 5/16" - 18 UNC\*50 mm  
8 pieces

E. Flat Washer  $\Phi 18^* \Phi 8$  mm\*1 mm  
8 pieces

F. Allen Wrench M5\*80 mm  
1 piece

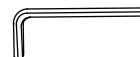
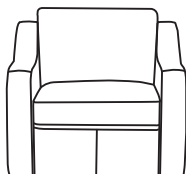
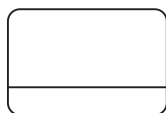

### Assembly Instructions

#### STEP 1

Detach the Legs (C) and Hardware (D E F) from the bottom of the Seat (B). (See Figure 1.)

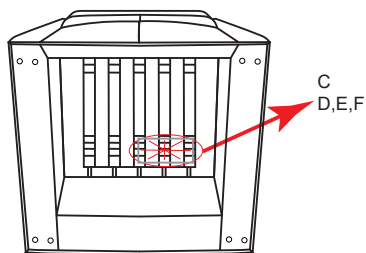

Figure 1

#### STEP 2

Attach the Legs (C) to Seat (B) by placing the Flat Washer (E) onto the Bolt (D). Then use the Allen Wrench (F) to tighten the Bolt (D) until the Legs (C) are tight. (See Figure 2.)

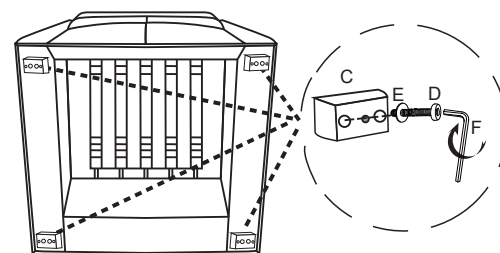

Figure 2

#### STEP 3

Zip the fabric on the Back Cushion (A) with the back of the Seat (B). (See Figure 3.)

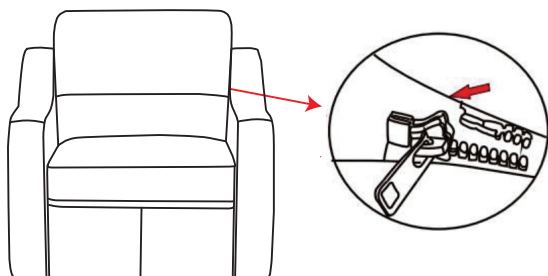

Figure 3

### IMPORTANT NOTE

- To avoid any risk of suffocation to children or pets, dispose of all plastic bags immediately.
- To ensure proper performance, occasionally check for loose hardware and tighten as needed.