



MAIDSTONE

www.MaidstoneSupply.com

Straight Supply Lines with Cross Handle Supply Stops

Part No: 123ST1-S

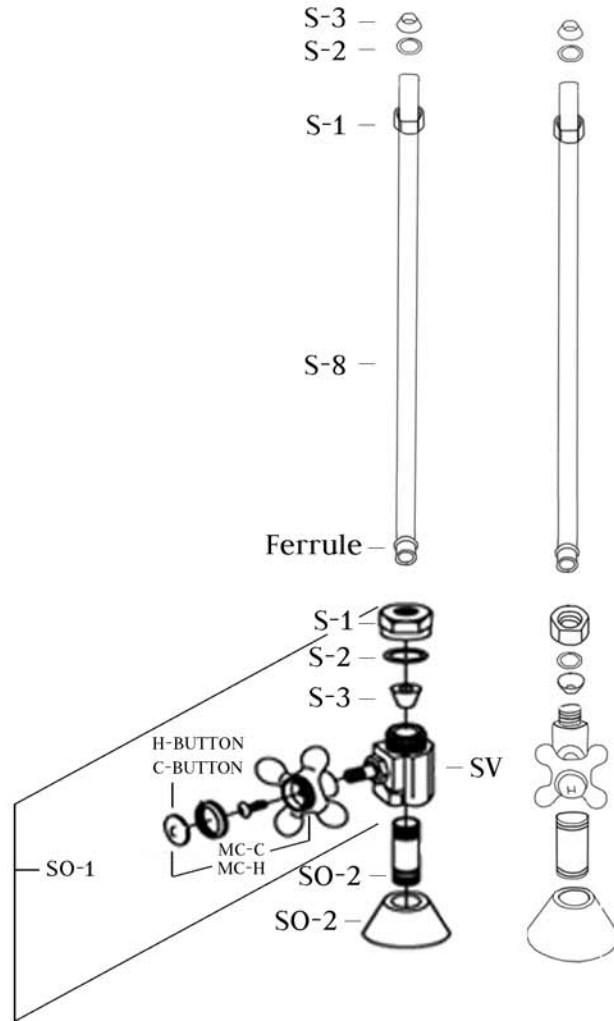

Unpack and check all the parts, and read the instructions.

PART NO.	DESCRIPTION	QTY	NOTES
SO-1	CROSS HANDLE COLD	1	MC-C
	CROSS HANDLE HOT	1	MC-H
	COLD CERAMIC BUTTON	1	C-BUTTON
	HOT CERAMIC BUTTON	1	H-BUTTON
	CONE WASHER	2	S-3
	BRASS WASHER	2	S-2
	NUT	2	S-1
	STRAIGHT VALVE	2	SV
SO-2	1/2" NPT x 3" NIPPLE	2	
SO-3	BELL FLANGE	2	
S-1	1/2" SLIP NUT	2	
S-2	BRASS FRICTION RING	2	
S-3	SMALL CONE WASHER	2	
S-8	STRAIGHT TUBE	2	

Contact Maidstone for additional information and specifications. For complete warranty information and a list of dealers visit www.MaidstoneSupply.com. All products and specifications are subject to change without notice. Maidstone is not responsible for typographical and/or dimensional errors. Typographical errors are subject to correction.

Note: Rough-in dimensions may vary +/- 1/2" and are subject to change. No responsibility is assumed by Maidstone.