

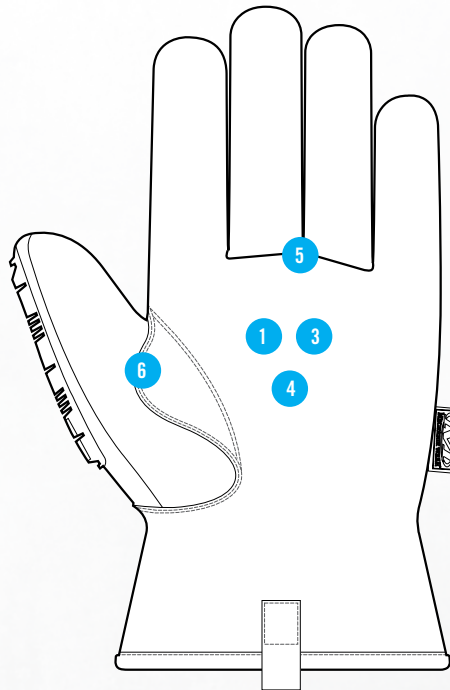

COLDWORK™ LEATHER M-PACT® DRIVER E5-360

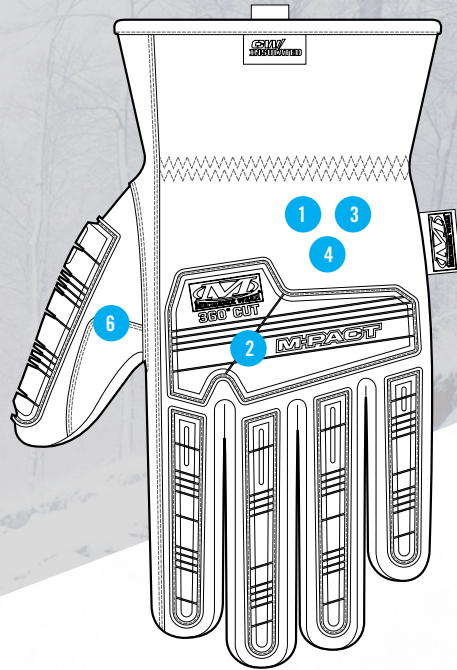

COLD WEATHER HAND PROTECTION

The ColdWork Leather M-Pact Driver glove is built to handle the day-in-day-out hazards found working with heavy equipment in frigid temperatures. Durahide Leather Technology wraps the entire hand creating the initial barrier of extreme abrasion resistance. An ANSI Level 2 rated TPR knuckle design protects the back of hand from impacts and abrasion, while an inner liner provides 360° of additional ANSI A5 level cut resistance. The final layer of protection is 40g 3M™ Thinsulate™ Insulation that locks in warmth, allowing you continue to work in freezing temperatures.

FEATURES

- 1 40g 3M™ Thinsulate™ Insulation traps warm air to help regulate your body temperature.
- 2 Anatomical TPR impact protection meets ANSI Level 2 impact standard.
- 3 High-tensile strength cut liners provide 360° ANSI A5 blade-cut resistance.
- 4 Durahide Leather Technology protects your hands with extreme abrasion resistance exceeding an ANSI Level 5 abrasion rating.
- 5 Gunn Cut glove design reduces seam usage in the palm for heavy material handling.
- 6 Comfortable keystone thumb design gives you better control.

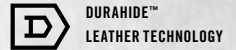

INTENDED USES

- Cold Storage
- Snow Removal
- Maintenance & Repair
- Construction
- Towing & Transportation

CERTIFICATIONS

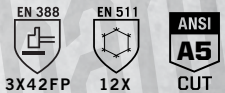

SIZE	S-008	M-009	L-010	XL-011	XXL-012
------	-------	-------	-------	--------	---------

COLOR	CWKLDP-X75 BROWN
-------	------------------

Product is Imported

COLDWORK™ LEATHER M-PACT® DRIVER E5-360

USA
(800) 222-4296
Spain
+34 93 628 22 00
Canada
(877) 278-5822
Australia
1 300-731 336
Japan
03 4590 0066

MECHANIX WEAR LLC
www.mechanix.com