

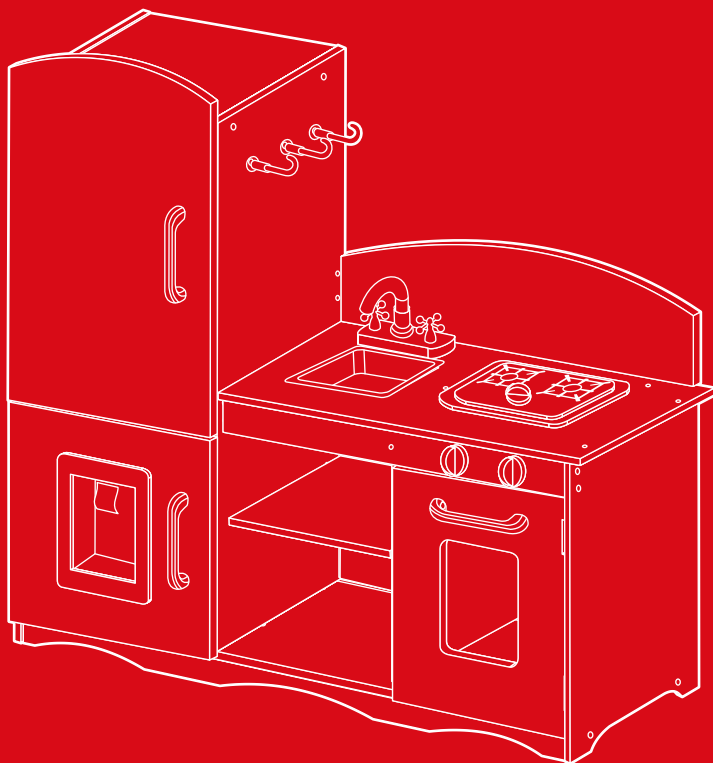

bestchoiceproducts



INSTRUCTION MANUAL

Kids Kitchen Playset



bestchoiceproducts

As shoppers, we're always trying to find the perfect balance between quality & value. At BCP, we believe we've achieved that. Our diverse catalog of everyday essentials is tailored especially to our customers & guaranteed to hit that sweet spot of high quality & low price.

— Always. —

! NOTICE

Please retain these instructions for future reference.

⚠ WARNING

ADULT ASSEMBLY REQUIRED

- Do not stand on or use any part of this item as a step ladder.
- Firmly secure all bolts, screws and knobs before use.
- Reconfirm that all bolts, screws, and knobs are secure every 90 days.
- Do not use or store this item in the proximity of open flame or flammable/combustible chemicals.
- If any parts are missing, broken, damaged, or worn, stop using this item until repairs are made and/or factory replacement parts are installed.
- Do not use this item in a way inconsistent with the manufacturer's instructions as this could void the product warranty.
- To wipe down item, use a damp cloth. Then, wipe it down once more with a dry cloth.

AGE RANGE: 3 years old and up

WARNINGS REGARDING BATTERIES

- Do not mix alkaline, standard (carbon zinc) and rechargeable (nickel hydride) batteries.
- Do not mix old and new batteries.
- Non-rechargeable batteries should not be charged.
- Rechargeable batteries should be charged under adult supervision only.
- Exhausted batteries should be removed.
- The supply terminals should not be short-circuited.
- Do not put batteries next to or in a heat source (fire, electronic heating device, etc.).
- Do not hit batteries against hard objects.
- Do not submerge batteries in water.
- Batteries should be inserted with the correct polarity.

TOOLS REQUIRED



HARDWARE

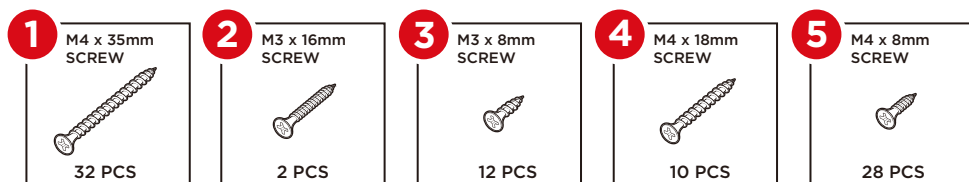

HARDWARE

6

HINGE



6 PCS

7

DOOR INSERT



3 PCS

8

DOOR CATCH



3 PCS

9

HANDLE



3 PCS

10

HOOK

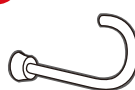

3 PCS

11

DOWEL



6 PCS

12

M4 x 16mm
SCREW



2 PCS

13

M3 x 20mm
SCREW



3 PCS

PARTS

A

PANTRY LEFT



1 PC

B

PANTRY RIGHT



1 PC

C

PANTRY TOP

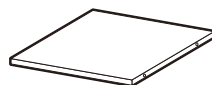

1 PC

D

PANTRY DIVIDER



1 PC

E

BACKSPLASH



1 PC

F

COUNTERTOP

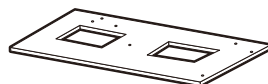

1 PC

PARTS

G

PANTRY BACK

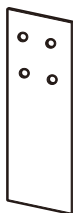

1 PC

H

BASE

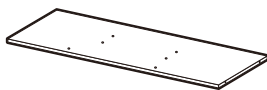

1 PC

I

SINK SHELF

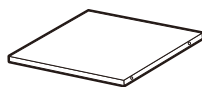

1 PC

J

OVEN BACK

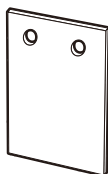

1 PC

K

SKIRT



1 PC

L

SINK/OVEN DIVIDER

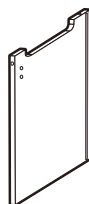

1 PC

M

OVEN DOOR

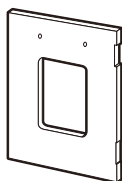

1 PC

N

OVEN SIDE



1 PC

O

PANTRY DOOR

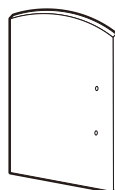

1 PC

P

REFRIGERATOR DOOR

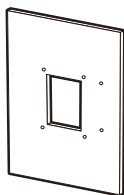

1 PC

Q

COUNTER PANEL

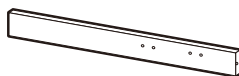

1 PC

R

SINK

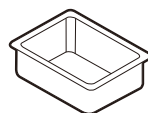

1 PC

PARTS

S

FAUCET

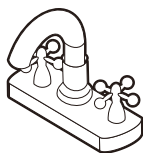

1 PC

T

KNOB



2 PCS

U

PHONE RECEIVER

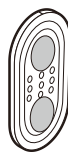

1 PC

V

PHONE



1 PC

W

ICE DISPENSER

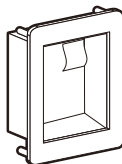

1 PC

X

STOVETOP

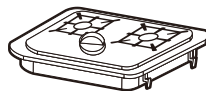

1 PC

Y

SINK BACK



1 PC

PRODUCT ASSEMBLY

1

Attach three part 8 door catches to the part B pantry right panel and part L divider with six part 3 screws, two screws per door catch.

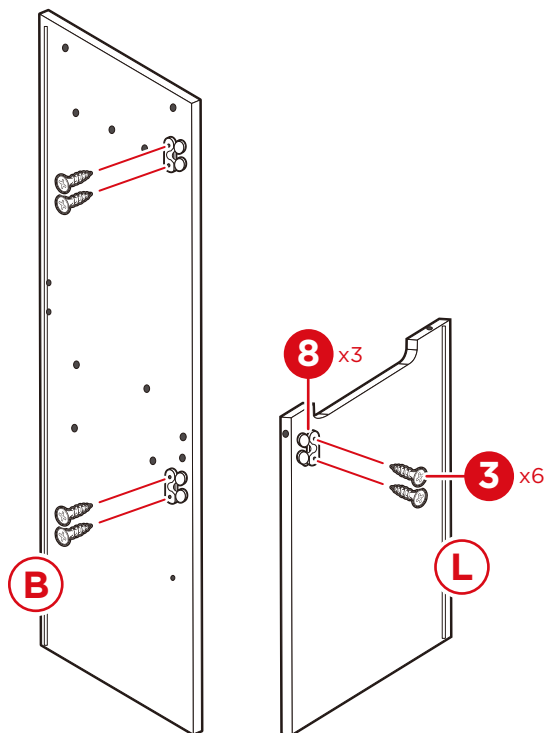

2

Attach two part T knobs to the part Q counter panel with four part 4 screws.

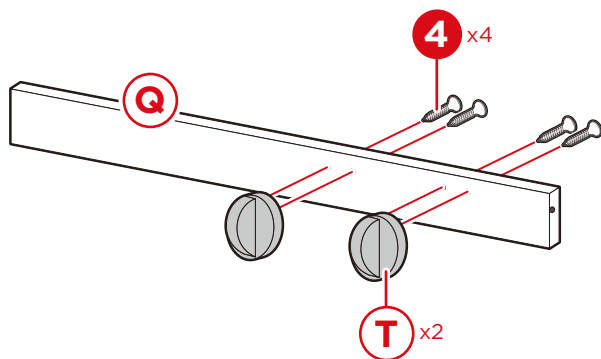

PRODUCT ASSEMBLY

3

Attach the part K skirt to the part H base with two part 1 screws.

Attach the part I sink shelf to the part B pantry right with two part 11 dowels.

Attach the pantry right to the base with two part 1 screws.

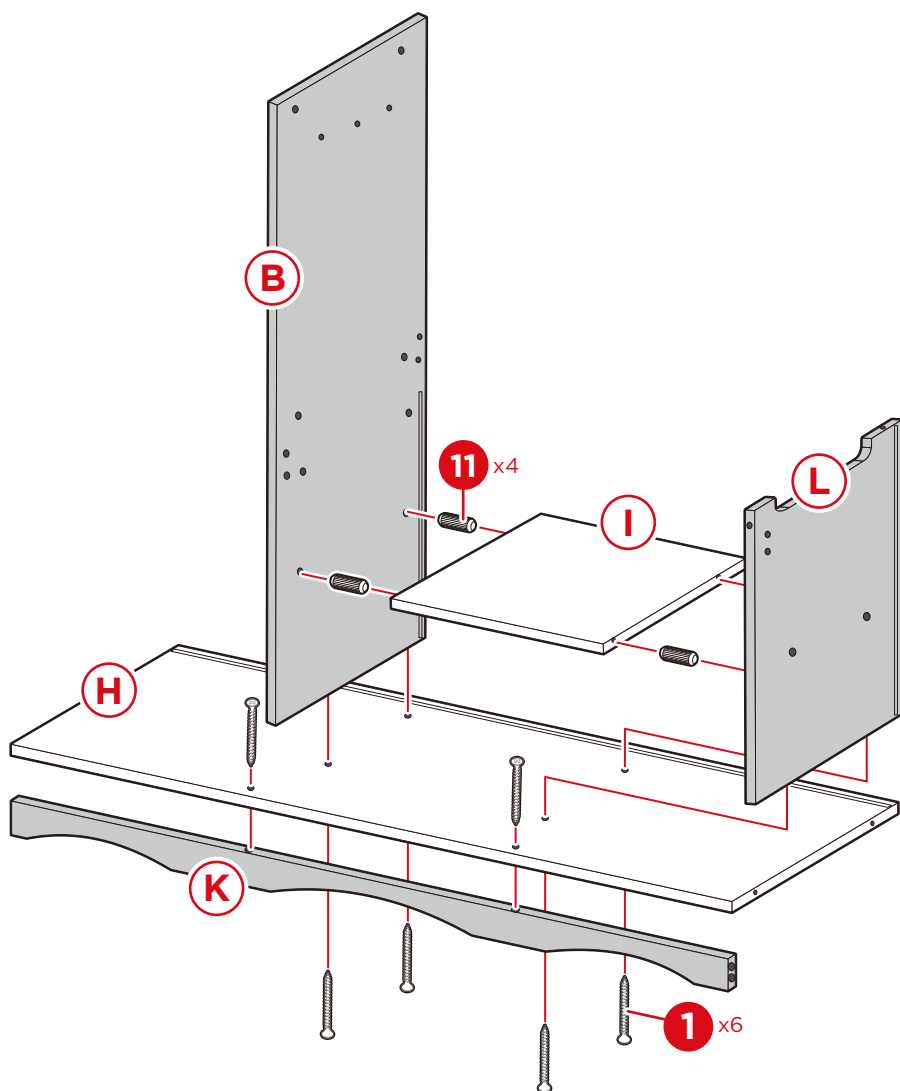

Attach the part L sink/oven divider to the part I shelf with two part 11 dowels.

Attach the part L divider to the base with two part 1 screws.

PRODUCT ASSEMBLY

4

Locate the part A pantry left and attach it to the base with one part 11 dowel and two part 1 screws.

Insert the part D pantry divider and secure with four part 1 screws.

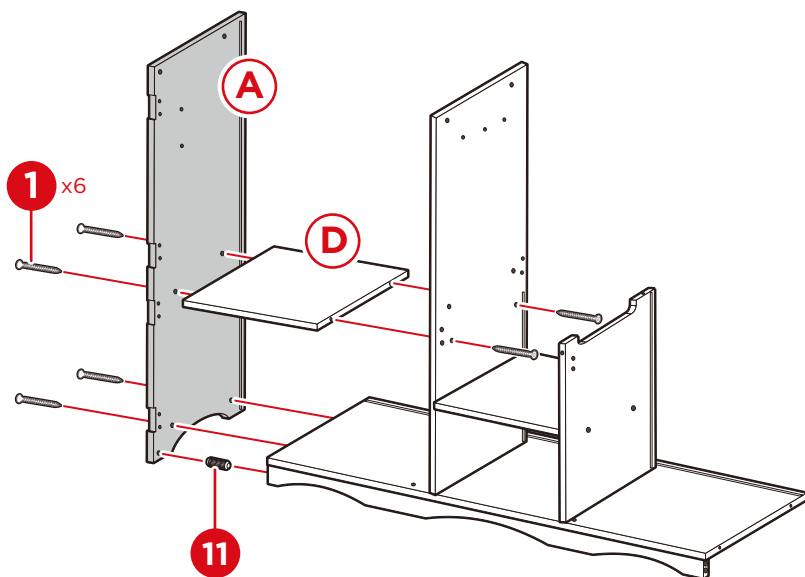

5

Locate the part N oven side and attach it to the base with one part 11 dowel and two part 1 screws.

Attach the part Q counter panel to the part B pantry right and the part N oven side with four part 1 screws.

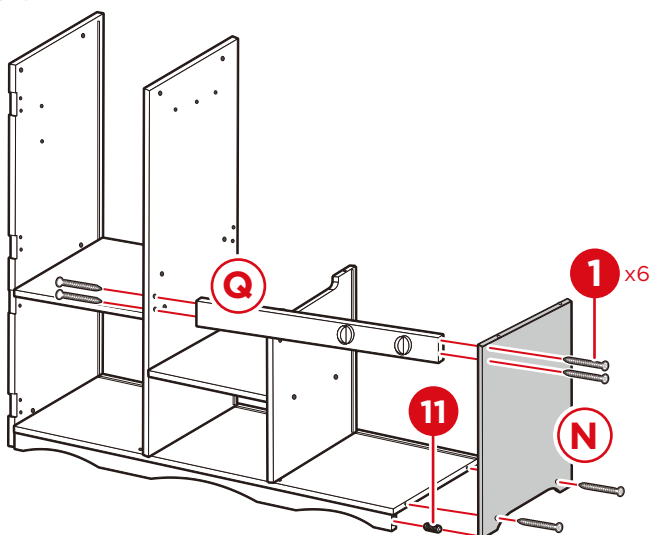

PRODUCT ASSEMBLY

6

Insert the part G pantry back between the pantry left and right.

Insert the part Y sink back between the part B pantry right and the part L divider.

Insert the part J oven back between the part L divider and the part N oven side.

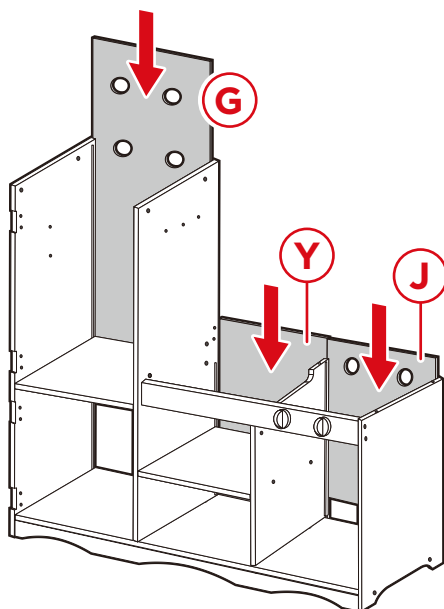

7

Locate the part C pantry top and attach it to the part A&B pantry left and right with four part 1 screws.

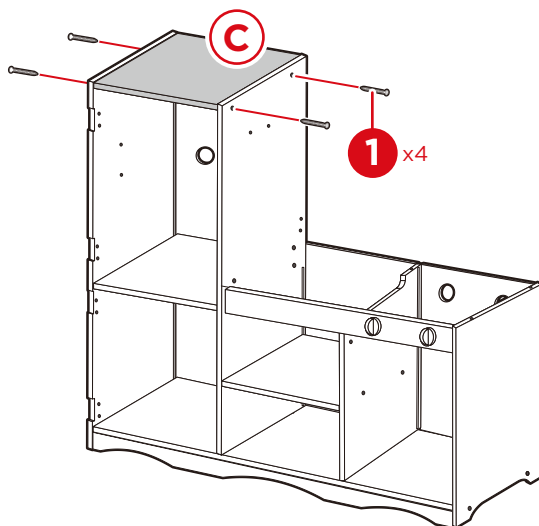

PRODUCT ASSEMBLY

8

Attach the part E backsplash to the part F countertop with two part 1 screws.
Insert the part S faucet and secure with two part 2 screws.

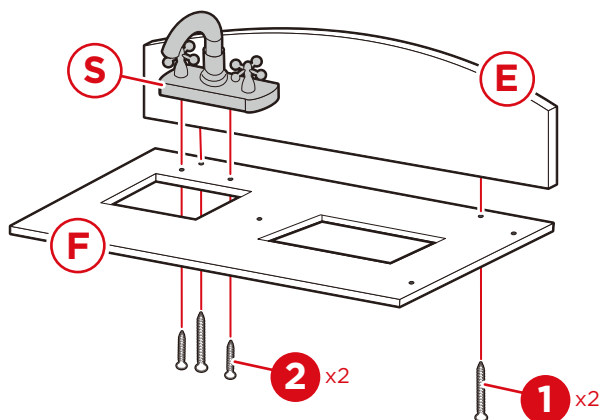

9

Attach the countertop assembly with seven part 1 screws.
Attach three part 10 hooks to the part B pantry right with three part 13 screws.

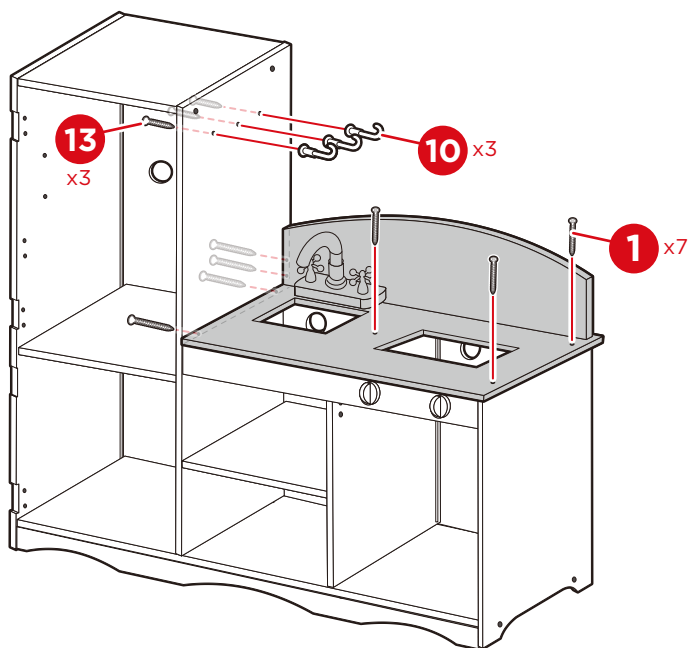

PRODUCT ASSEMBLY

10

Insert the part U phone receiver into the part A pantry left and secure with two part 12 screws.
Attach the part V phone to the part U phone receiver.
Install two AAA batteries in the part X stove top, then insert into the part F countertop.
Insert the part R sink into the part F countertop.

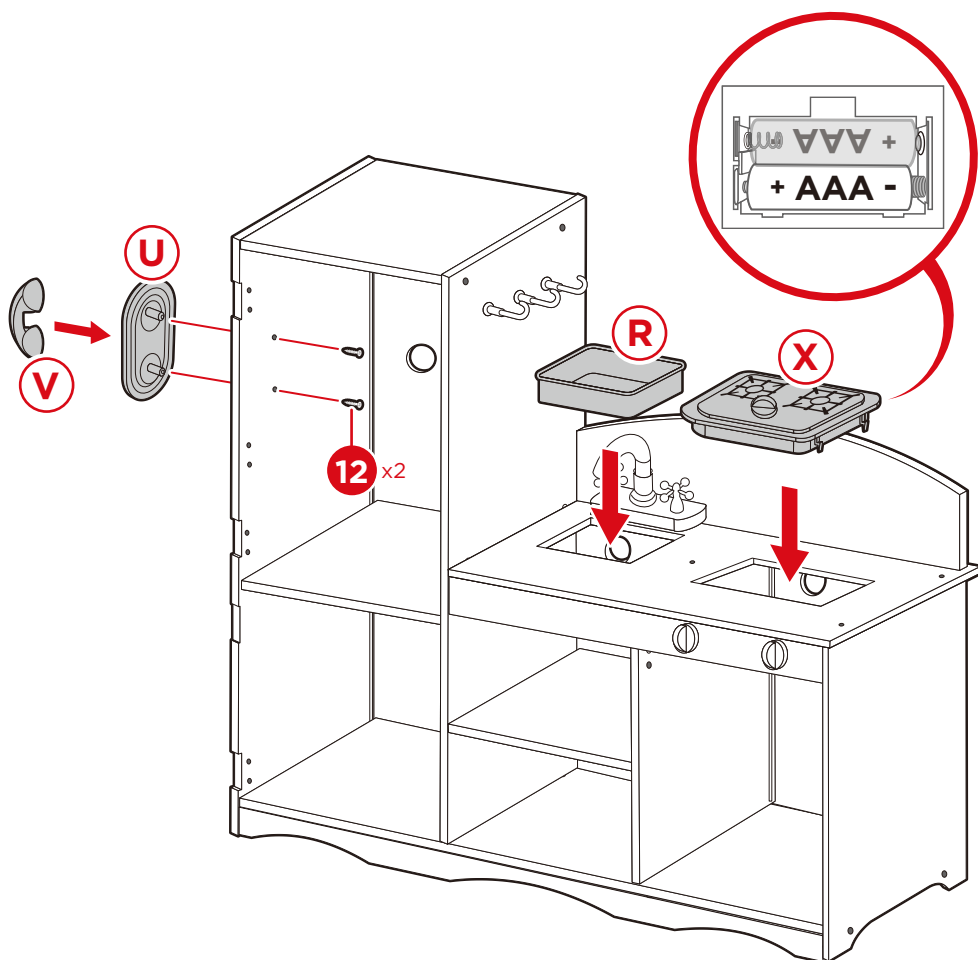

PRODUCT ASSEMBLY

11

Attach one part 7 door insert to the part P refrigerator door with two part 3 screws.
Attach one part 9 handle with two part 4 screws and set aside.

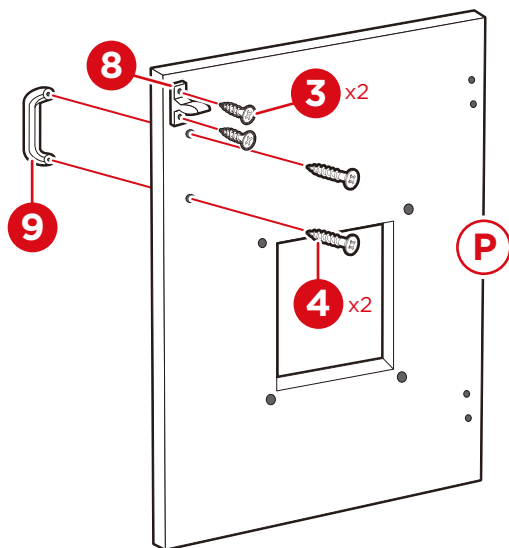

12

Attach the part W ice dispenser to the part P refrigerator door with four part 5 screws.

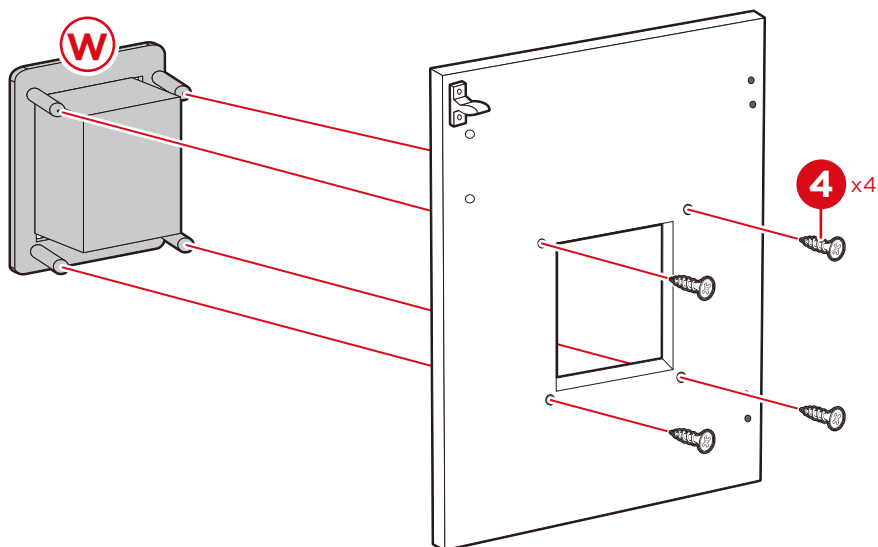

PRODUCT ASSEMBLY

13

Attach one part 7 door insert to the part O pantry door with two part 3 screws.
Attach one part 9 handle with two part 4 screws and set aside.

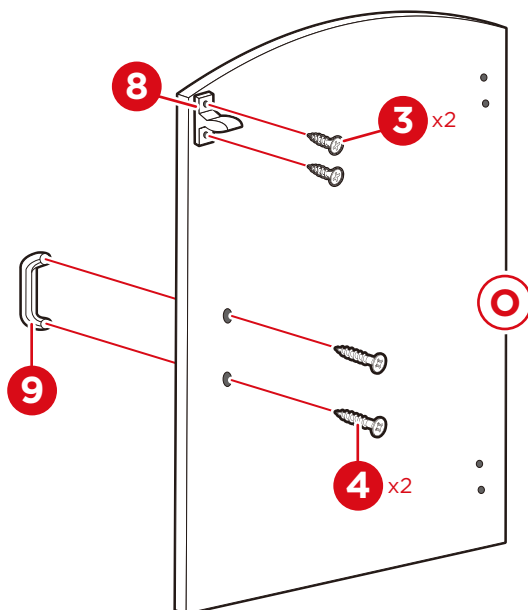

14

Attach one part 7 door insert to the part M oven door with two part 3 screws.
Attach one part 9 handle with two part 4 screws and set aside.

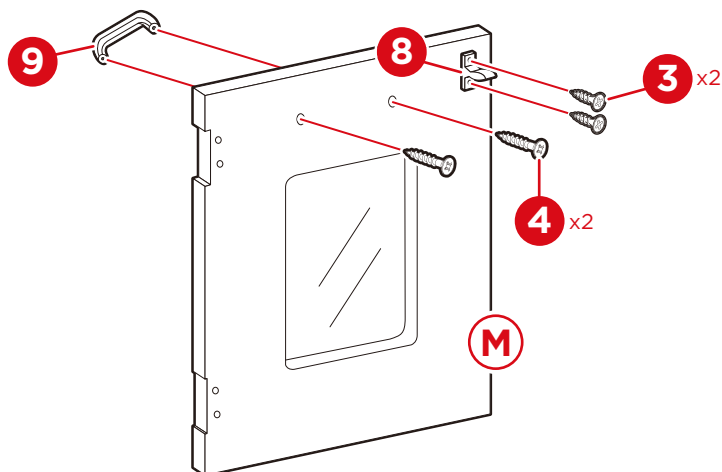

PRODUCT ASSEMBLY

15

Attach part O pantry door, part P refrigerator door, and part M oven door with twenty-four part 5 screws and six part 8 hinges, four screws per hinge.

Install two AAA batteries in the ice dispenser.

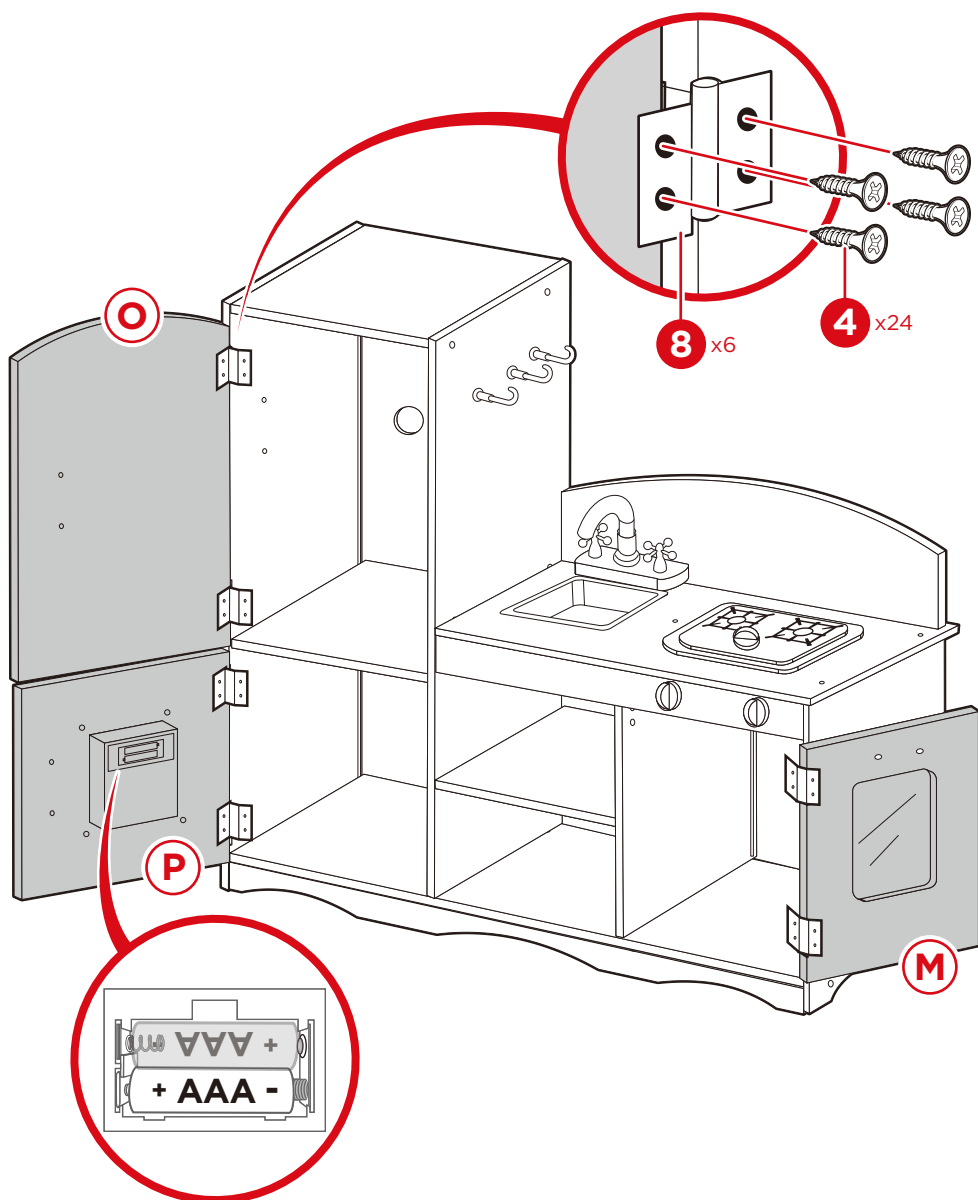



HELP CENTER



Question about your product? We're here to help. Visit us at:

help.bestchoiceproducts.com



Chat Support



Product Inquiry



Orders FAQ



Product Assembly



Returns & Refunds

PRODUCT WARRANTY INFORMATION

All items can be returned for any reason within 60 days of the receipt and will receive a full refund as long as the item is returned in its original product packaging and all accessories from its original shipment are included. All returned items will receive a full refund back to the original payment method. All returned items will not be charged a re-stocking fee.

All returned items require an RA (Return Authorization) number, which can only be provided by a Best Choice Products Customer Service Representative when the return request is submitted. Items received without an RA may not be accepted or may increase your return processing time. Once an item has been received by Best Choice Products, refunds or replacements will be processed within 5 business days.

All returns must be shipped back to the Best Choice Products Return Center at the customer's expense. If the reason for return is a result of an error by Best Choice Products then Best Choice Products will provide a pre-paid shipping label via email. Boxes for return shipping will not be provided by Best Choice Products, and is the customer's responsibility to either use the original shipping boxes or purchase new boxes.

Pictures may be required for some returns to ensure an item is not damaged prior to its return. Items returned are not considered undamaged until they are received by Best Choice Products and verified as such. All damages to items are the customer's responsibility until the item has been received by and acknowledge by Best Choice Products as undamaged.



WARNING

Manufacturer and seller expressly disclaim any and all liability for personal injury, property damage or loss, whether direct, indirect, or incidental, resulting from the incorrect attachment, improper use, inadequate maintenance, unapproved modification, or neglect of this product.