

# ASSEMBLY INSTRUCTION

## VANITY WITH FLIP MIRROR & POWER STRIP & STOOL

**A** Vanity Top Frame

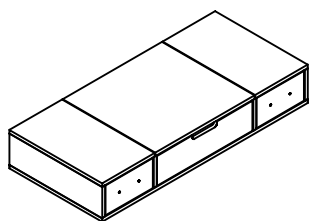

1PC

**B** Left Leg Frame-Vanity

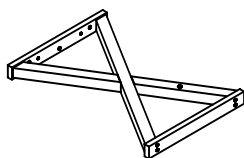

1PC

**C** Right Leg Frame-Vanity

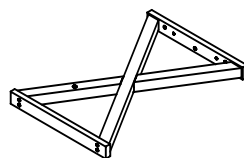

1PC

**D** Crossbar

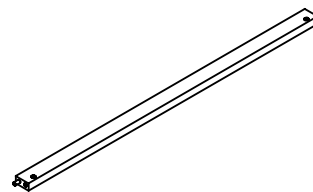

1PC

**E** Cushion Seat

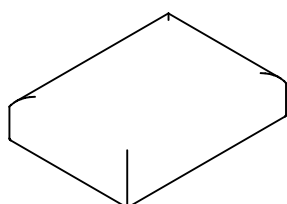

1PC

**F** Leg Frame-Stool

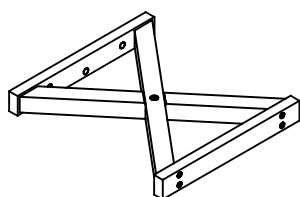

2PCS

**G** Stool Crossbar

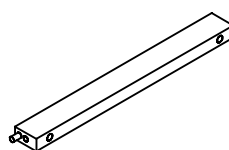

1PC

**H** Partition

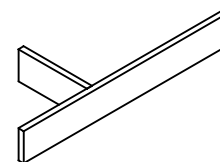

1PC

**I** Long Bolt  
1/4"x70mm



4PCS

**J** Short Bolt  
1/4"x35mm



12PCS

**K** Barrel Nut  
1/4"



4PCS

**L** Spring Washer  
1/4"



12PCS

**M** Flat Washer  
1/4"x19mm

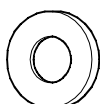

12PCS

**N** Allen Wrench  
4x59mm



1PC

**O** Phillips Screwdriver  
(Not supplied)



1PC

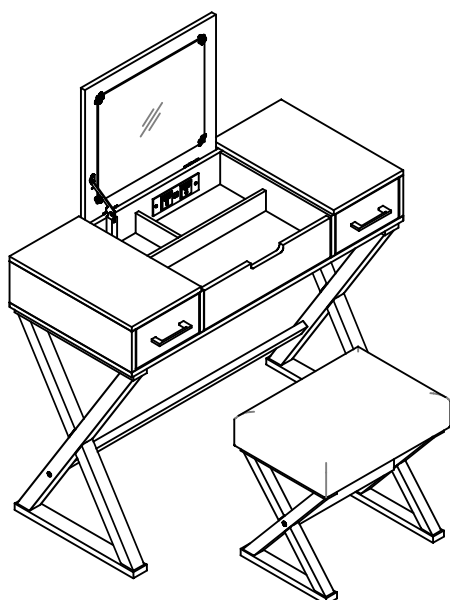

This page lists all the contents included in the box. Please take the time to identify the hardware as well as the individual components to this product. As you unpack and prepare for assembly, place the contents on the carpeted or padded area to protect them from damage.

- 1 Lift up the stopper to take drawer out of the box.

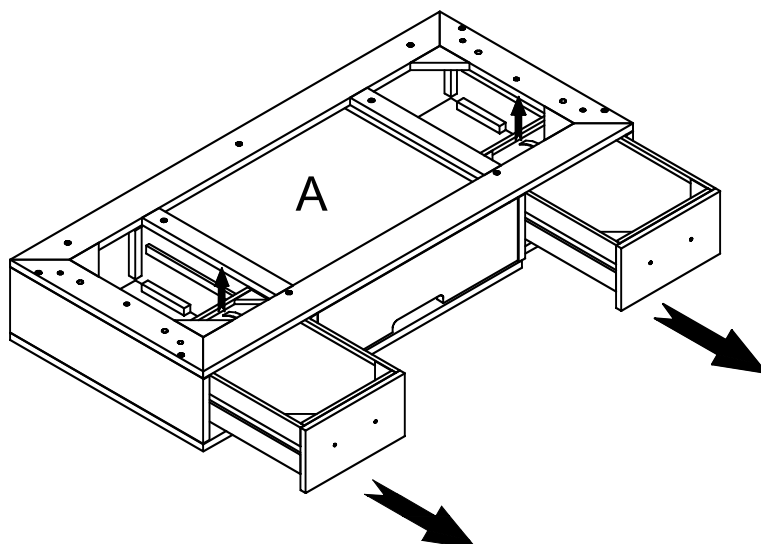

- 2 Place table upside down on a non-abrasive surface such as carpet (bottom of table top should be facing up). Attach right leg frame-vanity (C) to vanity top frame (A) using short bolt (J), spring washer (L), flatwasher (M). Insert crossbar (D) into right leg frame-vanity (C) by using phillips screwdriver (O) to insert the barrel nut (K) and then insert the long bolt (I). Then tighten all bolts with allen wrench (N).

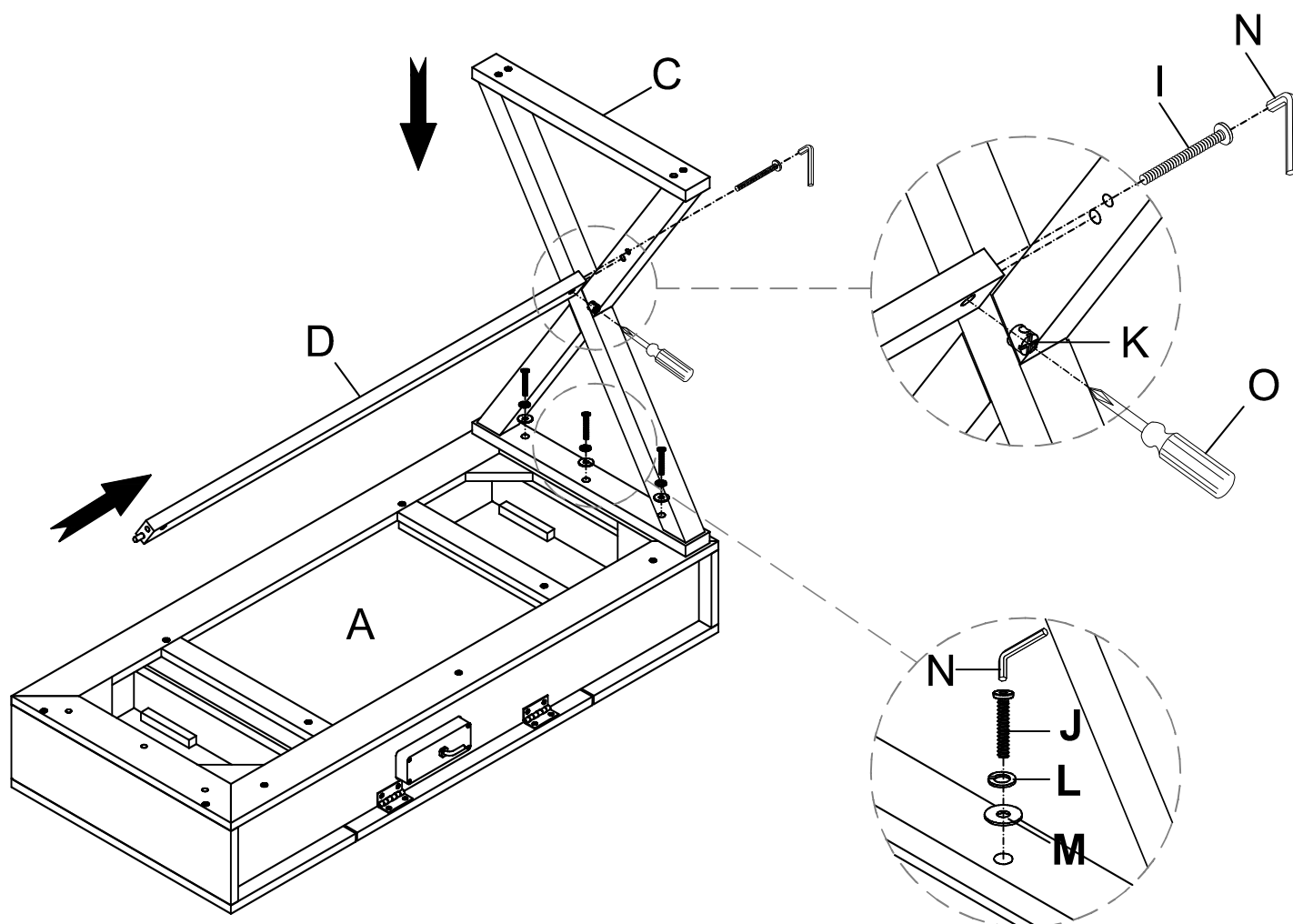

3

Attach left leg frame-vanity (B) to vanity top frame (A) and crossbar (D). Tighten left leg frame-vanity (B) with short bolt (J), spring washer (L), flat washer (M). Insert crossbar (D) into left leg frame-vanity (B) by using phillips screwdriver (O) to insert the barrel nut (K) and then insert the long bolt (I). Tighten all bolts completely using allen wrench (N).

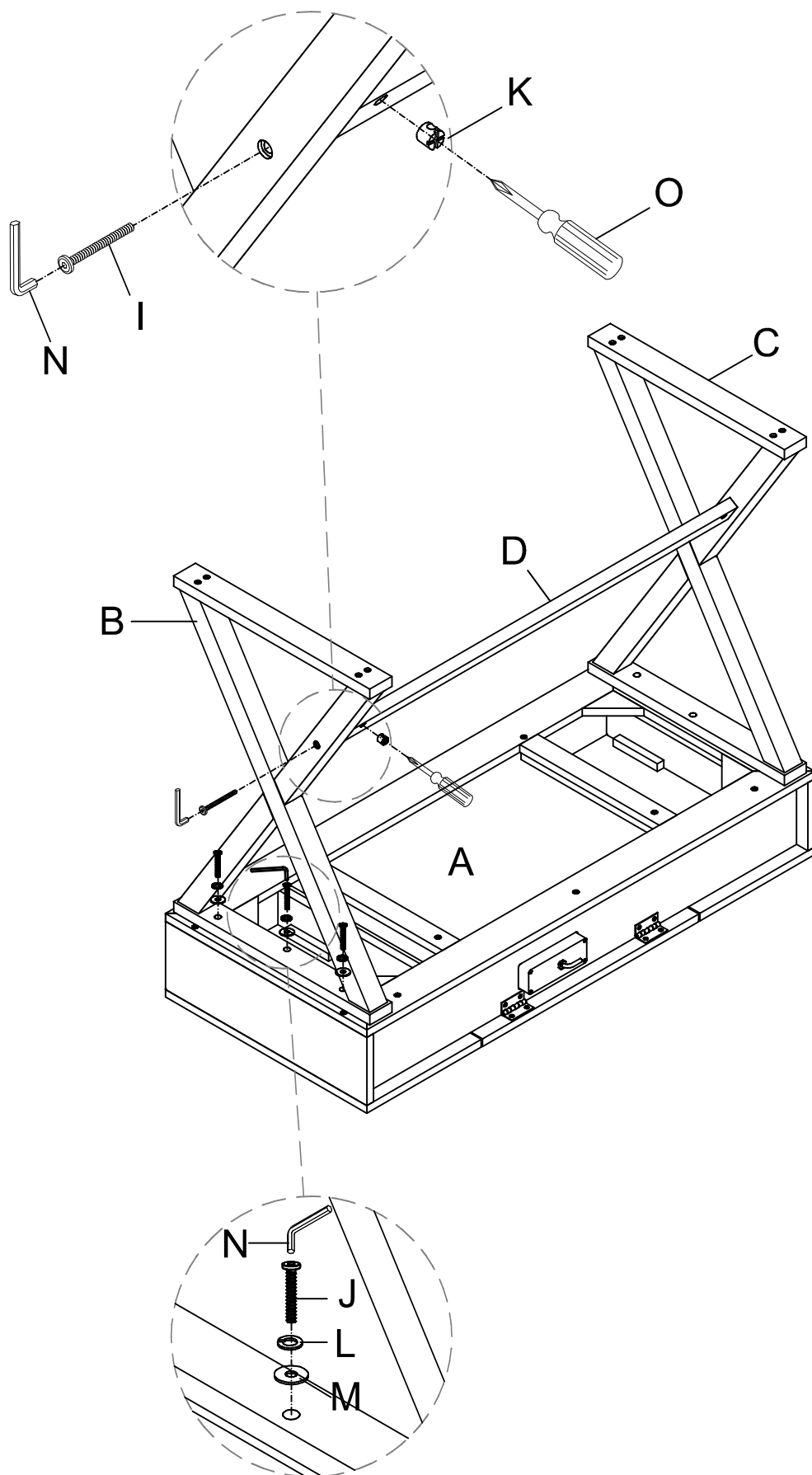

- 4 Attach the handle to drawer front panels with handle screws by phillips screwdriver (O).

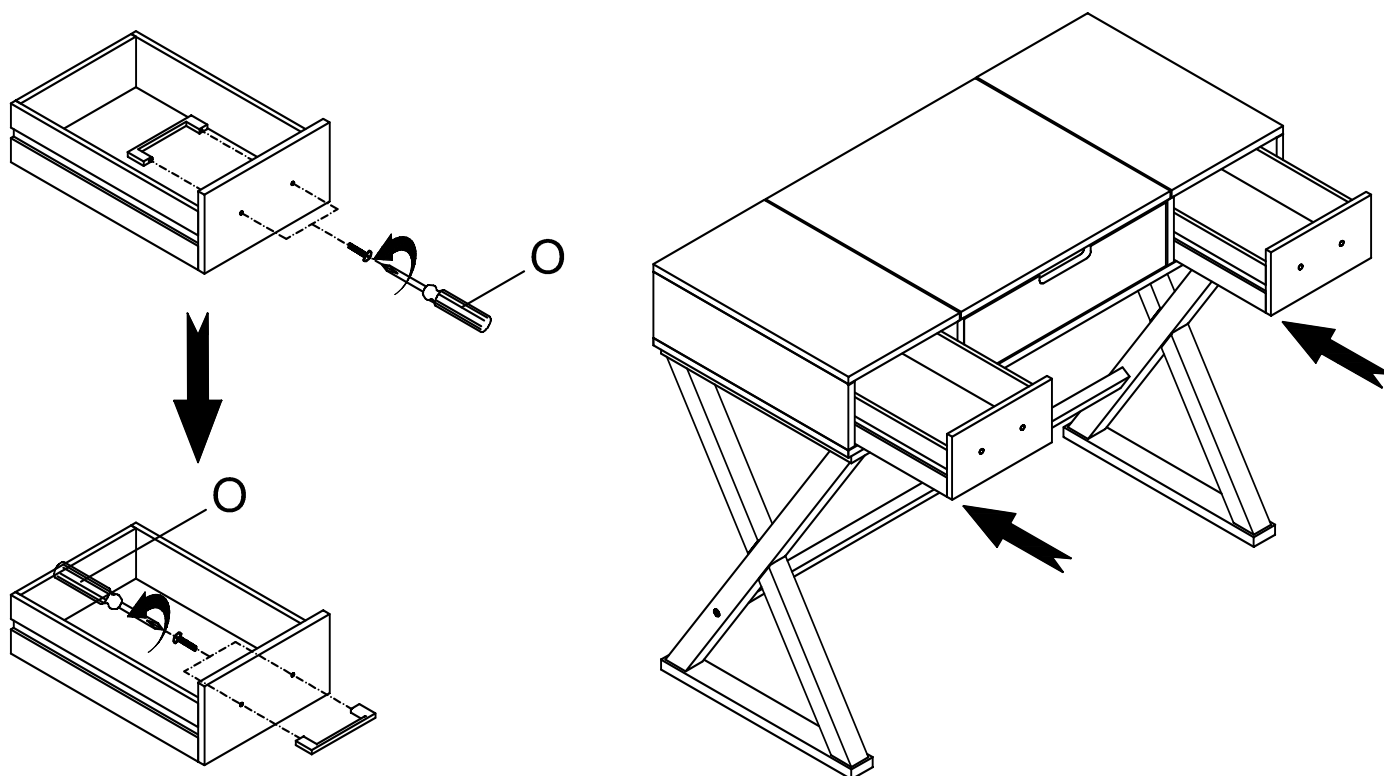

- 5 Then put the partition (H) down onto the table.

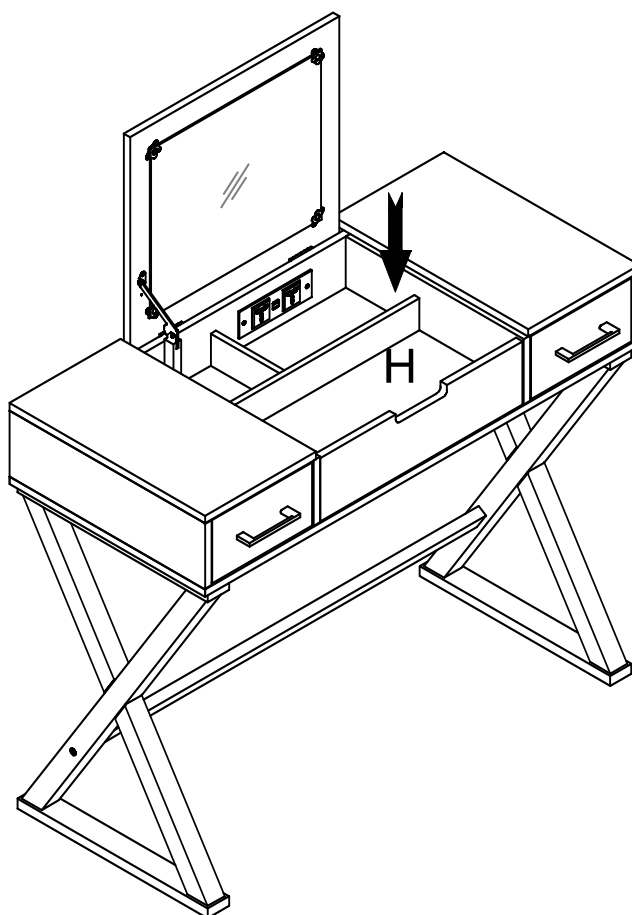

- 6** Place cushion seat (E) upside down on a non-abrasive surface such as carpet (bottom of stool top should be facing up). Attach leg frame-stool (F) to cushion seat (E) using short bolt (J), spring washer (L), flat washer (M). Insert stool crossbar (G) into leg frame-stool (F) by using phillips screwdriver (O) to insert the barrel nut (K) and then insert the long bolt (I). Then tighten all bolts with allen wrench (N).

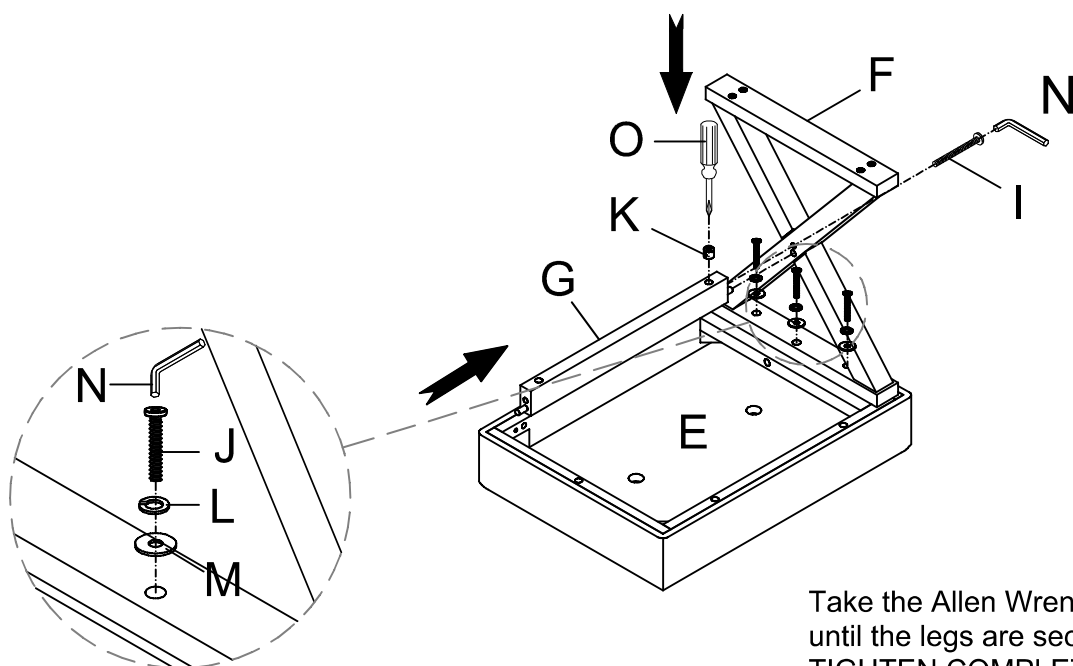

Take the Allen Wrench, and turn the bolts until the legs are secured. **DO NOT TIGHTEN COMPLETELY.** Stop when you feel you are adding force to tighten the bolt.

- 7** Attach leg frame-stool (F) to cushion seat (E). Tighten leg frame with short bolt (J), spring washer (L), flat washer (M). Insert stool crossbar (G) into leg frame-stool (F) by using phillips screwdriver (O) to insert the barrel nut (K) and then insert the long bolt (I). Then tighten all bolts with allen wrench (N).

Stand stool up on an even surface and check that it is balanced. If there is a slight wobble, apply downward pressure in the corner where a leg is uneven. Keeping pressure in that corner, tighten all bolts. If balanced, apply downward pressure evenly in the center and tighten all bolts. Do not over-tighten beyond hole depth.

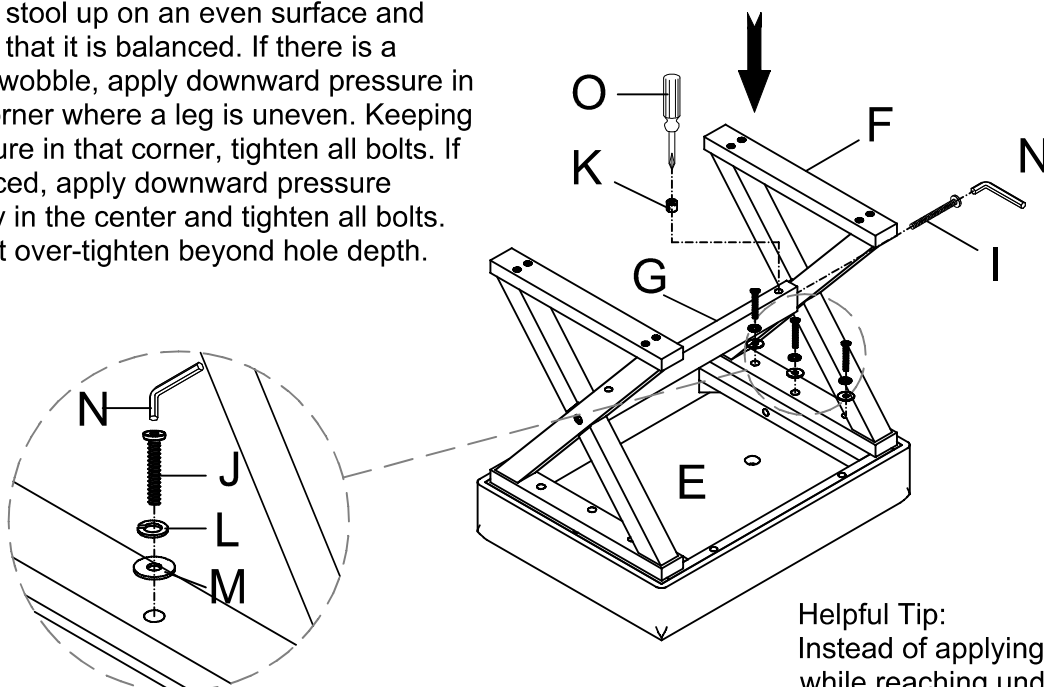

**Helpful Tip:**  
Instead of applying downward pressure while reaching under to tighten bolts, have someone sit in the stool while you tighten the bolts.

#### Cleaning & Care

Treat surface with care. Surface is resistant to scratches but is not scratch resistant. Clean surfaces with a dry or damp soft cloth. Do not use abrasive cleaners. Hardware may loosen over time. Periodically check that all connections are tight.