

NECK FINISH	BOTTLE WEIGHT ($\pm 2.0GR$)	OVERFLOW CAPACITY ($\pm 11.0CC$)	"T" DIA	"E" DIA	"H" DIM	"H2" DIM	"S" DIM	"T" DIA	MATERIAL
M28SP410	41.0	979.0	1.088 1.068	.994 .974	.723 .693	---	.061 .031	.614 MIN	PETE

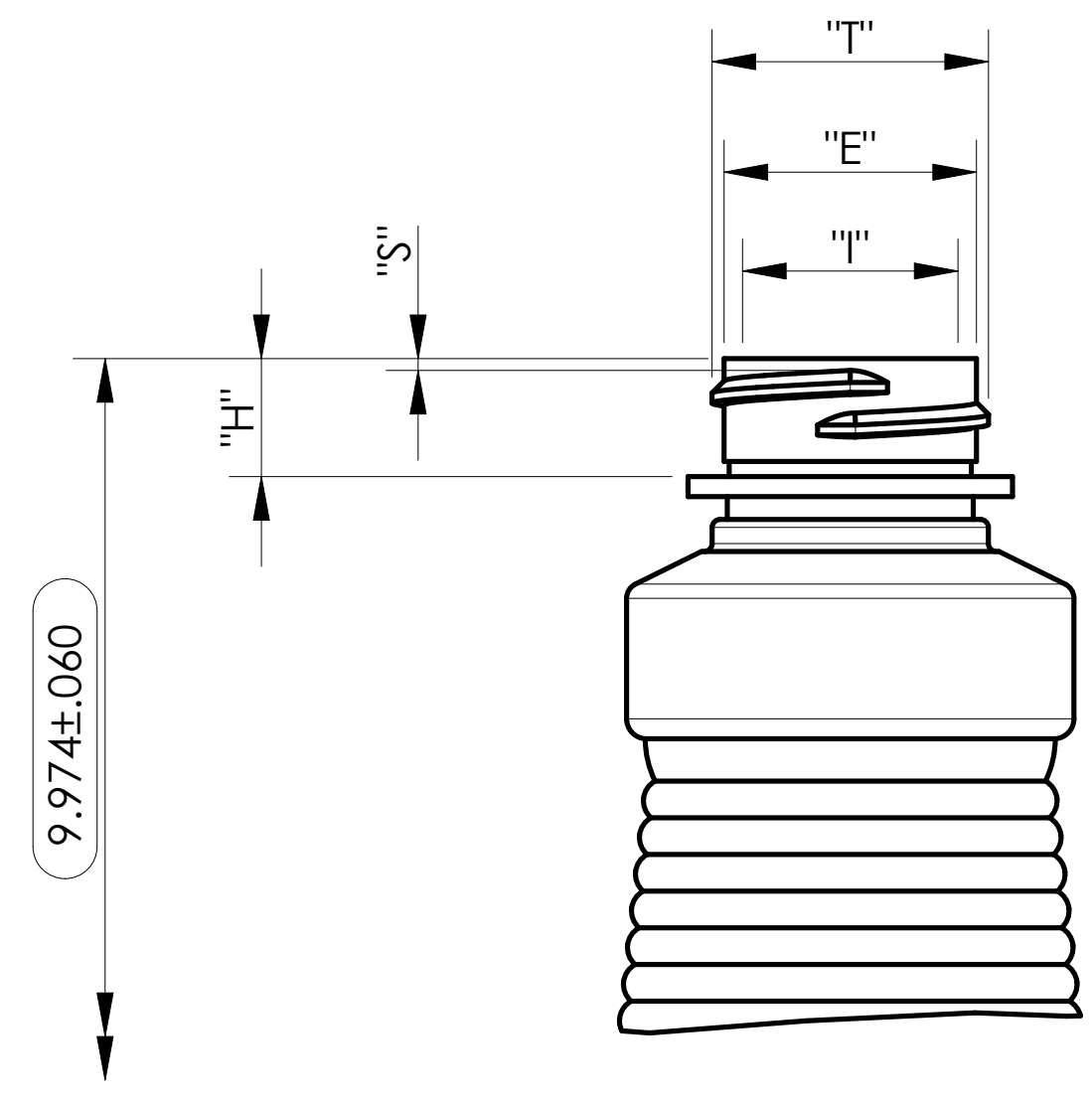

28-400SW NECK FINISH

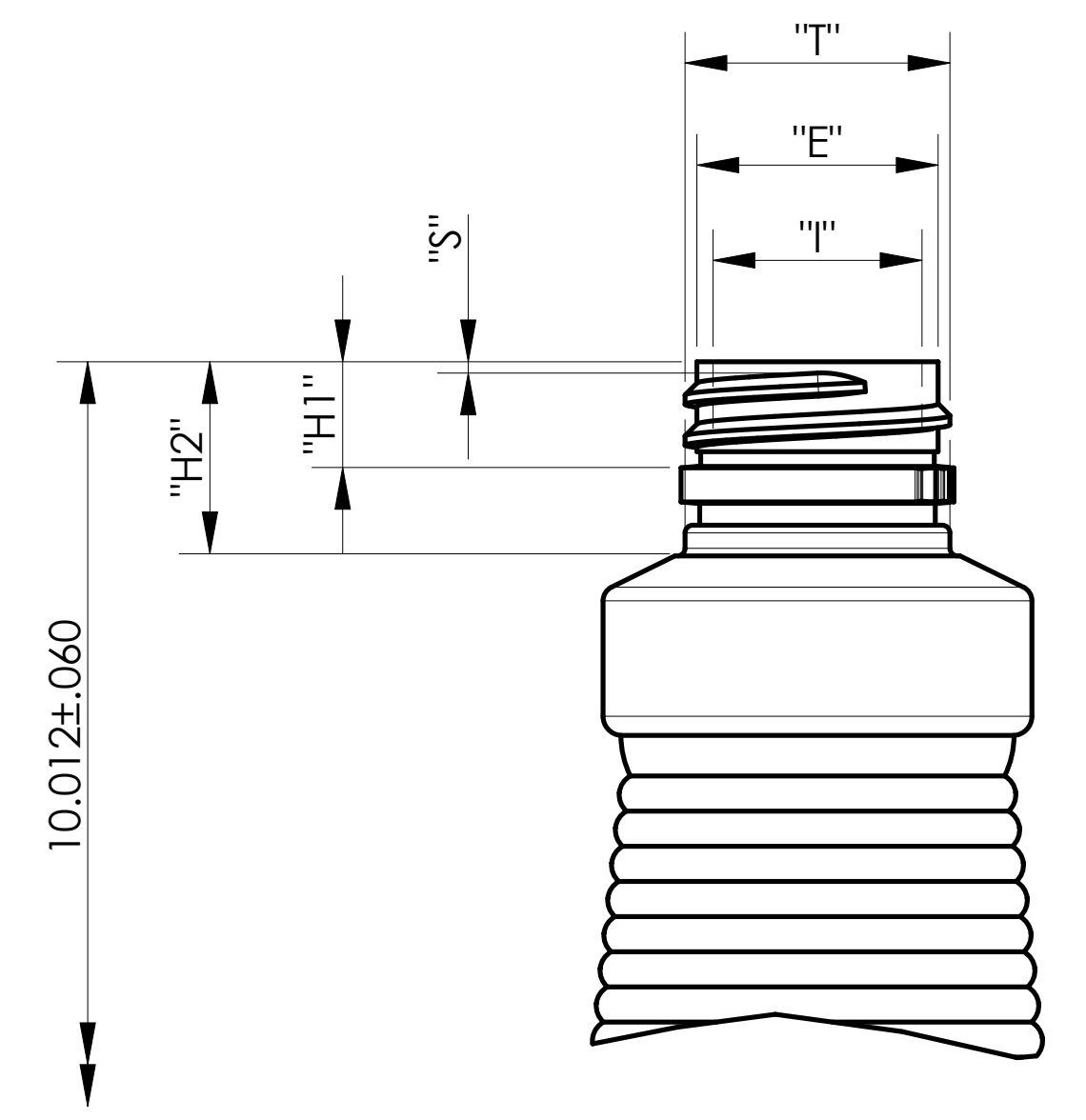
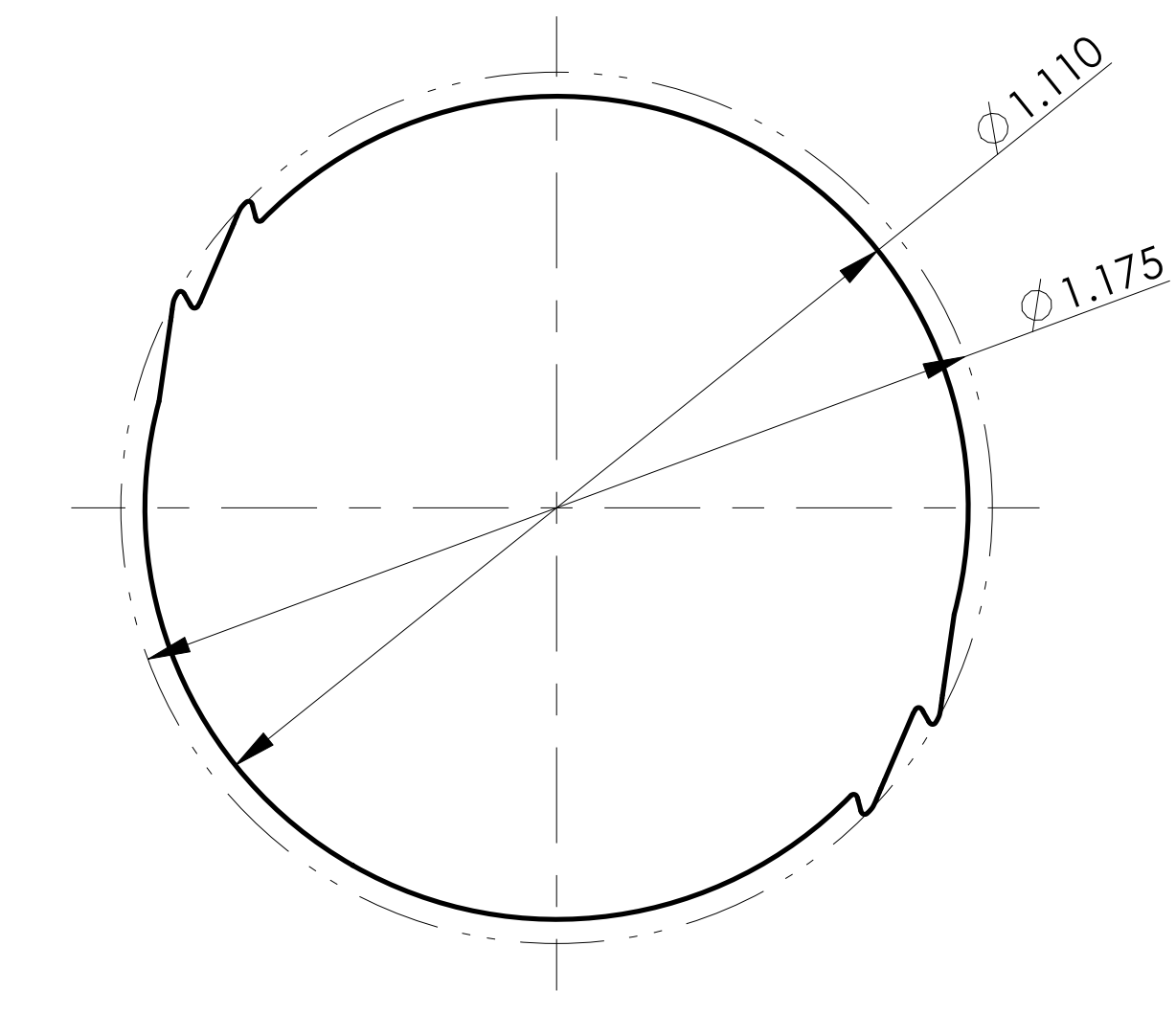
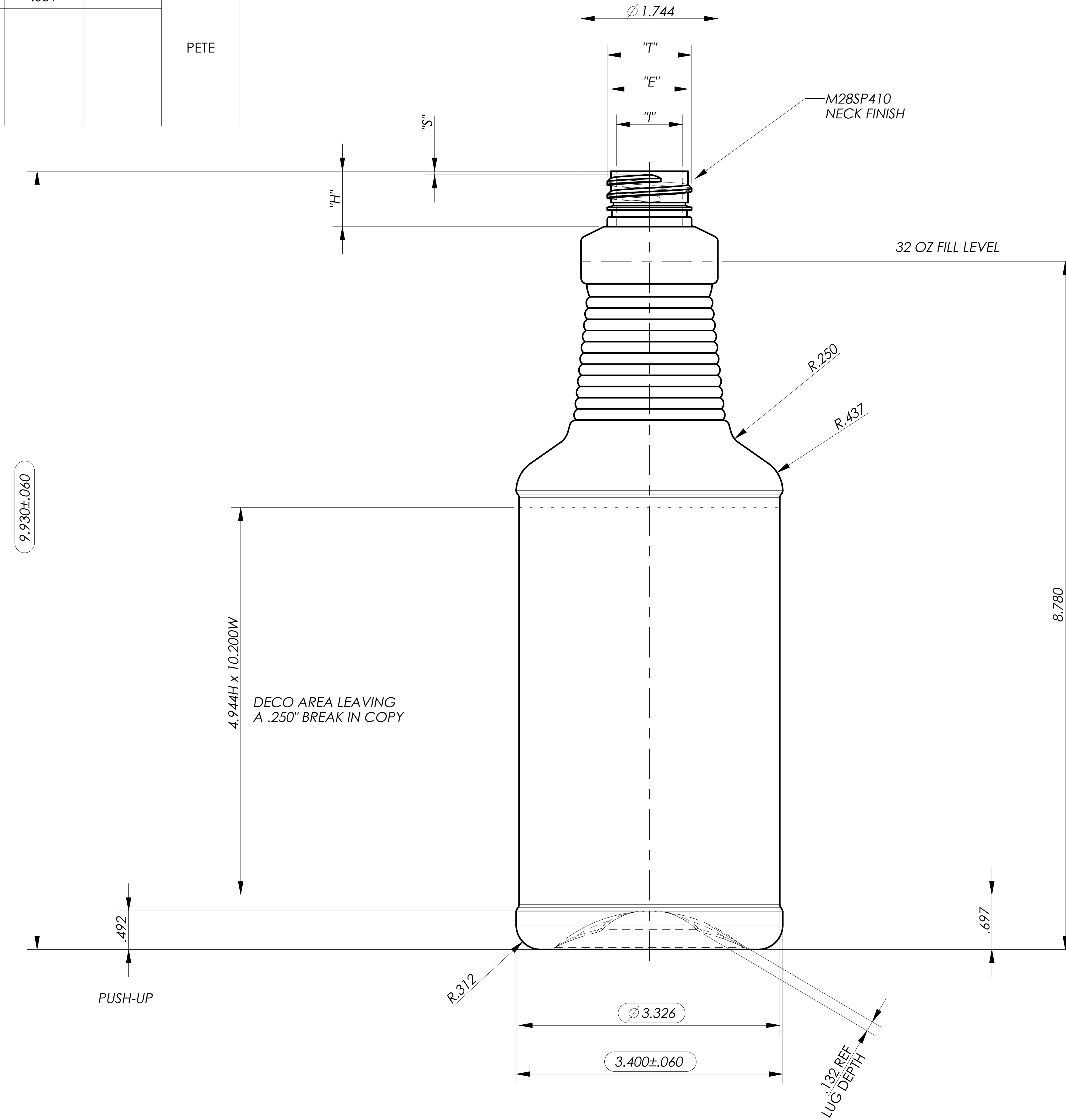

28MM RATCHET, 41.5 GR

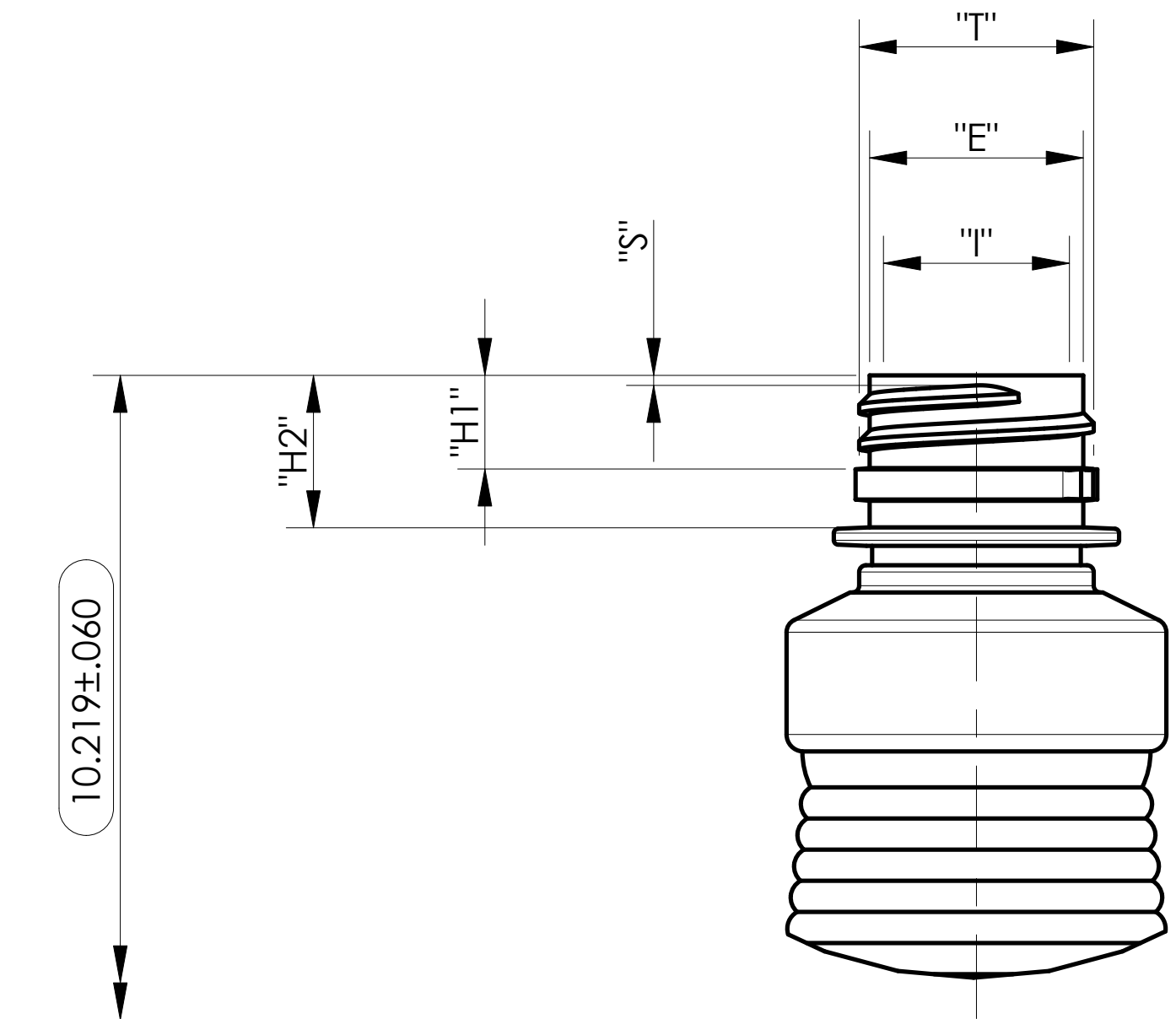

28MM RATCHET, 48.9GR

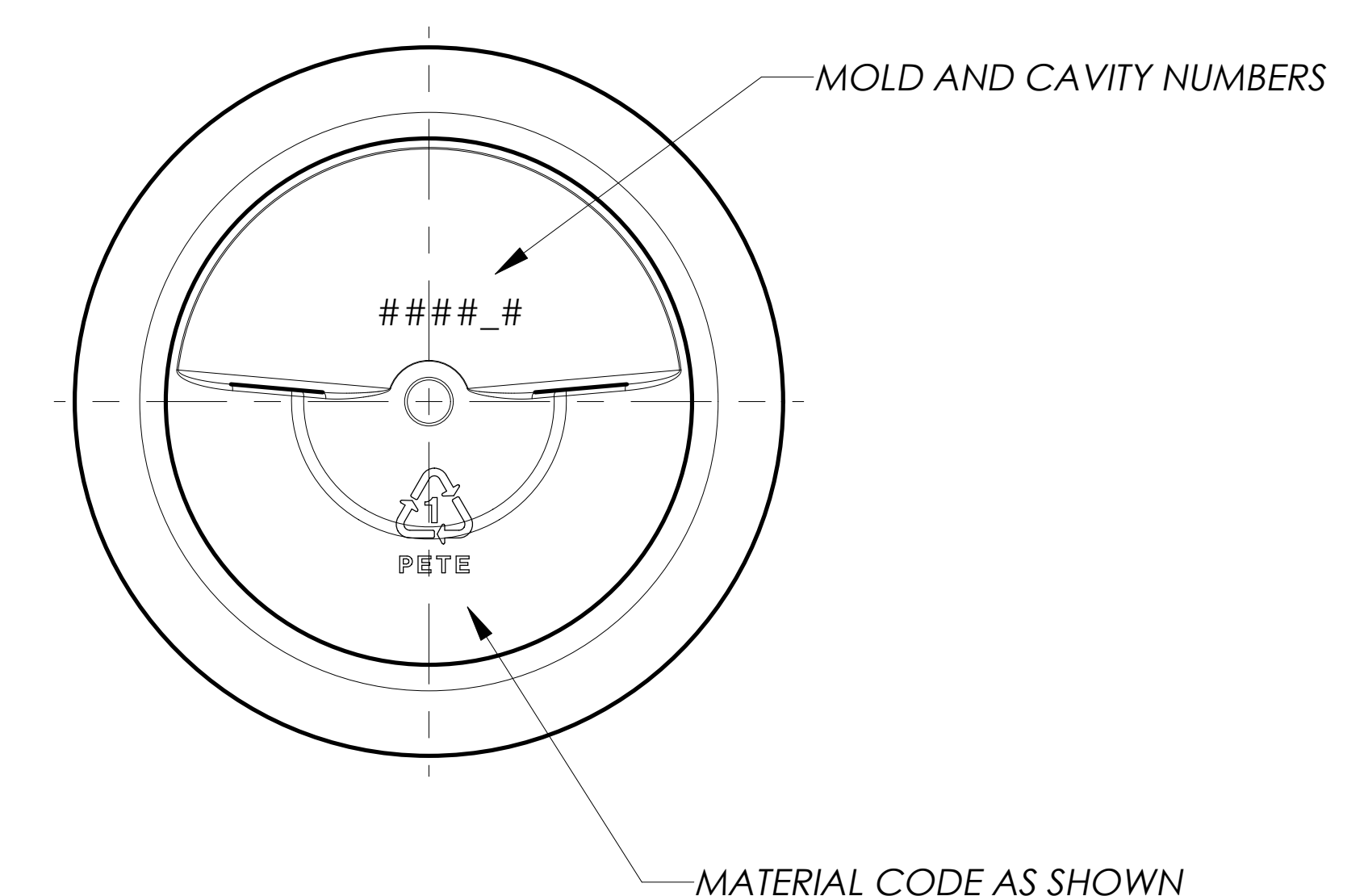

<p>DISCLAIMER</p> <p>THIS INFORMATION IS PROVIDED AS A GENERAL GUIDE, INCLUDING DIMENSIONS. IT IS THE CUSTOMER'S RESPONSIBILITIES TO SELECT THE PROPER CONTAINER FOR PRODUCT AND APPLICATION COMPATIBILITY.</p>	<p>DISTRIBUTED BY: </p>	<p>REF NO.: DWG31067</p>
	<p>DESCRIPTION:</p>	
	<p>32 oz Clear PET Plastic Ring Neck Carafe Bottle, 28-410, 41 Gram</p>	