



TESLACORE SERIES

RACK-MOUNT POWER DISTRIBUTION UNIT

USER MANUAL

WELCOME

Thank you for choosing AC Infinity. We are committed to product quality and friendly customer service. If you have any questions or suggestions, please don't hesitate to [contact](#) us. Visit www.acinfinity.com and click contact for our contact information.

EMAIL

support@acinfinity.com

WEB

www.acinfinity.com

LOCATION

Los Angeles, CA

MANUAL CODE TCA1711X1

PRODUCT

TESLACORE A1
TESLACORE A2

MODEL

AC-TCA1
AC-TCA2

UPC-A

819137020337
819137020344

MANUAL INDEX

Manual Index	Page 5
Key Features	Page 6
Product Contents	Page 7
Usage Requirements	Page 8
Mounting	Page 9
Light Indicators	Page 11
Other AC Infinity Products	Page 12
Warranty	Page 13

KEY FEATURES

CIRCUIT BREAKER

Contains a 15-amp circuit breaker that shuts off power when the equipment is drawing too much power, which can damage circuits.

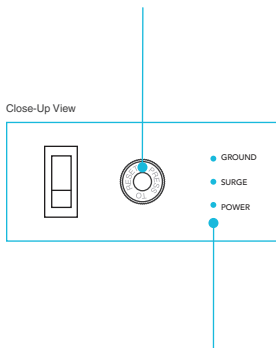

STATUS INDICATORS

The system proactively monitors the condition of the rack PDU's load. Actively displays the current ground, surge, and power status.

SURGE PROTECTOR

Features a 1800-joule surge suppression rating to absorb energy spikes caused by electrical power grid and overload issues.

ALUMINUM FRAME

Features an aluminum frame with a brushed black finish and CNC machined corners to match high end audio video components.

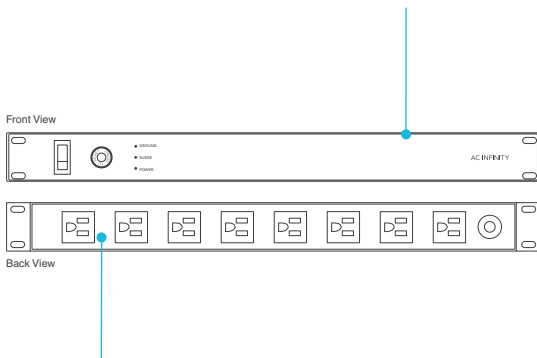

HEAVY-DUTY HOUSING

The unit is enclosed with heavy duty cold-rolled steel which protects it's components from harsh environments and shocks.

PLUG AND PLAY

This (PDU) features an extra long 15 feet power cord with a three-prong power plug. Includes rack screws and cage nuts for an easy install.

PRODUCT CONTENTS

TESLACORE A1 AC-TCA1

Front View



Back View



RACK PDU UNIT (x1)



MOUNTING SCREW (x4)

TESLACORE A2 AC-TCA2

Front View



Back View



RACK PDU UNIT (x1)



MOUNTING SCREW (x4)

USAGE REQUIREMENTS

MAXIMUM LOAD

Please calculate the total load that you will be placing on the PDU, before plugging in equipment. To determine your total load, add up the amp ratings of your devices. It is important not to exceed the PDU's maximum current load, as stated on the product's specifications.

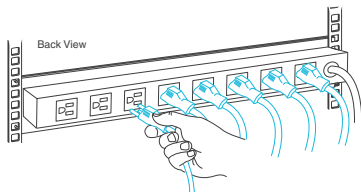

RECEPTACLE REQUIREMENT

The PDU must be plugged into a three-wire, grounded wall receptacle. The receptacle must also be connected to a branch main with fuse or circuit breaker protection. Connection to any other type of wall receptacle is dangerous and may result in a shock hazard.

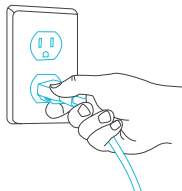

OPERATING ENVIRONMENT

The rack system has an operating temperature rating of -4° F to 140° F and a humidity rating of 0% RH to 90% RH, non-condensing. Storage temperature is between -22° F to 158° F. Please make sure that the system's environment does not exceed these parameters.



MOUNTING

STEP 1

Determine the position you wish to mount the PDU unit onto your rack.

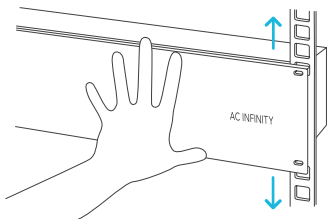

STEP 2

Use a screwdriver and the included screws to secure the PDU unit onto your rack. Depending on the rack rail type, you may need to install cage nuts first. Please note that some rack rails may come pre-threaded with another screw size.

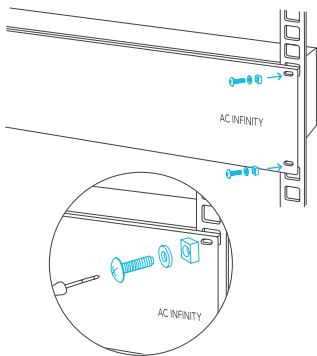

MOUNTING

STEP 3

Once all outlets are safely and securely plugged in, you are then able to plug in the Teslacore to the nearest wall outlet. **DO NOT** use extension cords or adapters that eliminate the connection to ground.

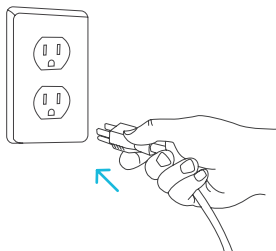

STEP 4

Organize and plug in other systems you would like to power using the Teslacore. Plug in power outlets through the back of the rack. If using Teslacore A2, you have the option of plugging in outlets from either side.

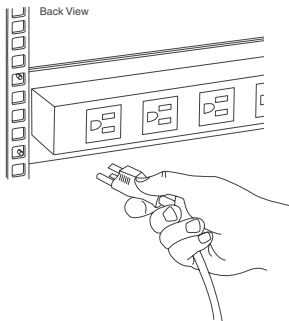

LIGHT INDICATORS

TESLACORE A1 A2

ACTIVE MONITORING

The indicator lights for GROUND, SURGE, and POWER will be on to show that the system is actively monitoring the listed conditions.



GROUND

When there is a bad connection to the ground then the orange light is off.

SURGE

When the light is red then the surge function is active. When the temperature is too high the red indicator will be off. If the surge function fails then the surge function will be off.

POWER

When the light is green then there is power going through all the devices and the PDU is on. When there is no light then the PDU is off.

CIRCUIT BREAKER

When the circuit breaker is activated, the reset button will protrude outwards. Once you have inspected all equipment to ensure that there are no defects and that the total amperage is not above the PDU's maximum load specifications. Press this button to reset the PDU.

ON/OFF

To power the on off switch simply click the left button. When all three indicator lights turn on the PDU is working normally.

AC INFINITY PRODUCTS

AIRPLATE SERIES

The AIRPLATE series is designed to cool home theater and audio video cabinets. The fans are powered by USB port or power outlets. Includes an inline speed controller and Boost Speed Adapter. The fans can also be temperature controlled with an Advance Thermal Controller (sold separately).

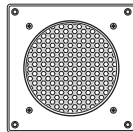

PRODUCT

AIRPLATE S1
AIRPLATE S3
AIRPLATE S5
AIRPLATE S7
AIRPLATE S9

MODEL

AI-CFS80BA
AI-CFS120BA
AI-CFD80BA
AI-CFD120BA
AI-APS9

DIMENSIONS

4.6 x 4.6 x 1.3 in.
6.3 x 6.3 x 1.3 in.
8.4 x 4.4 x 1.3 in.
11.7 x 6.1 x 1.3 in.
17.5 x 6.1 x 1.3 in.

MULTIFAN SERIES

The MULTIFAN series fans can be placed on top of AV components and electronics to exhaust hot air economically. It features an inline speed controller and can be powered by a USB port. The fans can also be powered through a power outlet with a Boost Speed Adapter (sold separately).

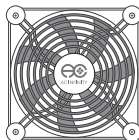

PRODUCT

MULTIFAN S1
MULTIFAN S3
MULTIFAN S4
MULTIFAN S5
MULTIFAN S7

MODEL

AI-MPF80A
AI-MPF120A
AI-MPF140A
AI-MPF80A2
AI-MPF120A2

DIMENSIONS

3.1 x 3.1 x 1 in.
4.7 x 4.7 x 1 in.
5.5 x 5.5 x 1 in.
3.1 x 3.1 x 1 in. /fan
4.7 x 4.7 x 1 in. /fan

WARRANTY

This warranty program is our commitment to you, the original purchaser, that each product sold by AC Infinity will be free from defects in manufacturing for a period of two years from the date of purchase. If a product is found to have a defect in material or workmanship, we will take the appropriate actions defined in this warranty to resolve any issues.

The warranty program applies to any order, purchase, receipt, or use of any products from AC Infinity. The program covers products that have become defective, malfunctioned, or expressively if the product becomes unusable. The warranty program goes into effect on the date of purchase. The program will expire two years from the date of purchase. If your product becomes defective during that period, AC Infinity will replace your product with a new one or issue you a full refund.

The warranty program does not cover abuse or misuse. This includes physical damage, submersion of the product in water, incorrect installation such as wrong voltage input, and misuse for any reason other than intended purposes. AC Infinity is not responsible for consequential loss or incidental damages of any nature caused by the product. We will not warrant damage from normal wear such as scratches and dings.



If you are not 100% satisfied with this product, we will be happy to replace it or issue you a full refund. Please contact us!

COPYRIGHT © 2018 AC INFINITY INC. ALL RIGHTS RESERVED

No part of the materials including graphics or logos available in this booklet may be copied, photocopied, reproduced, translated or reduced to any electronic medium or machine readable form, in whole or in part, without specific permission from AC Infinity Inc.

www.acinfinity.com