

RCB Floor Stand

ASSEMBLY INSTRUCTIONS

Kit Name	RCB Floor Stand
Kit Part Number	803000047
Compatible Rinnai Products	Rinnai Commercial Boiler Models: RCB301AN and RCB399AN



WARNING

Failure to correctly assemble the components according to these instructions may result in property damage, injury, or death.

Items Inside Product Box

Before you begin, please make sure all parts are located inside the product box.

Table 1: Items included in the packaging.

Item #	Item (Part Number)	Qty
1	Vertical Leg Assembly	1
2	Horizontal Leg Assembly	2
3	Wall and Floor Bracket	4
4	Support Bracket	4
5	Tube Cap	4
6	Hex Screw, M6 X 45 mm	10
7	Hex Screw, M6 X 50 mm	8
8	M6 Nut	18
9	M6 Washer	30
10	Wall Screws with dowels	12
11	Assembly Instructions (this document)	1

Additional parts included for multi-stands installation		
A	Hex Screw, M6 X 80 mm	6
B	Hex Screw, M6 X 16 mm	4
C	M6 Nut (same as item 8)	4
D	M6 Washer (same as item 9)	4

Figure 1

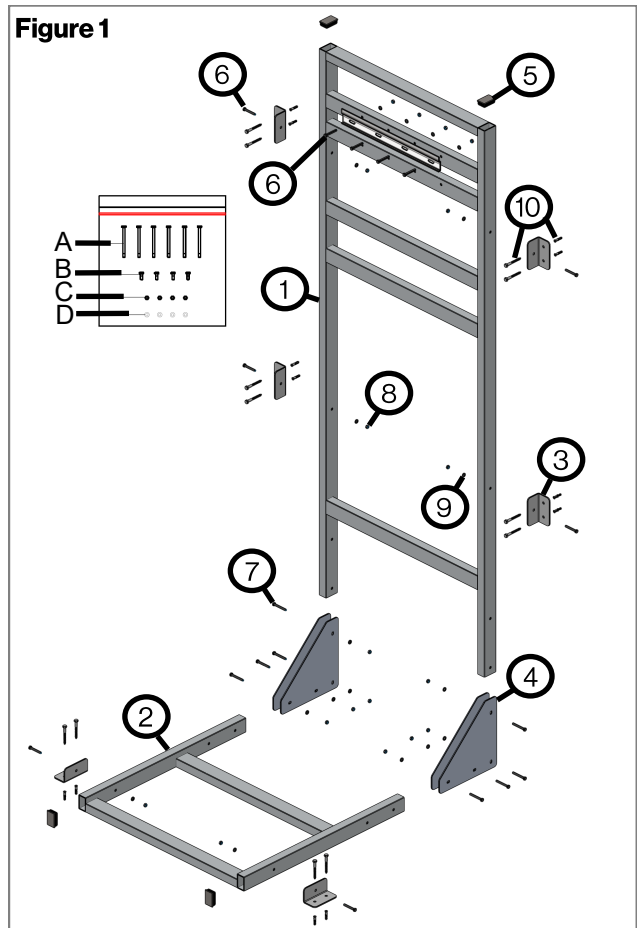

TOOLS/MATERIALS REQUIRED

- 10 MM Wrench
- 10 MM Socket Driver
- Adjustable Wrench

- Drill and Drill Bits
- Level

1. Open the floor stand packaging and confirm that all components are available for the installation.

NOTE: Do not lose these components. Spare components are not included in this kit.

2. Attach vertical leg assembly to the horizontal leg assembly using four (4) of the support brackets, two (2) for each leg, eight (8) Hex screw M6x50mm, eight (8) M6 washers, and eight (8) M6 nuts (Figure 2).

NOTE: Ensure the assembly is square and the vertical leg assembly is level.

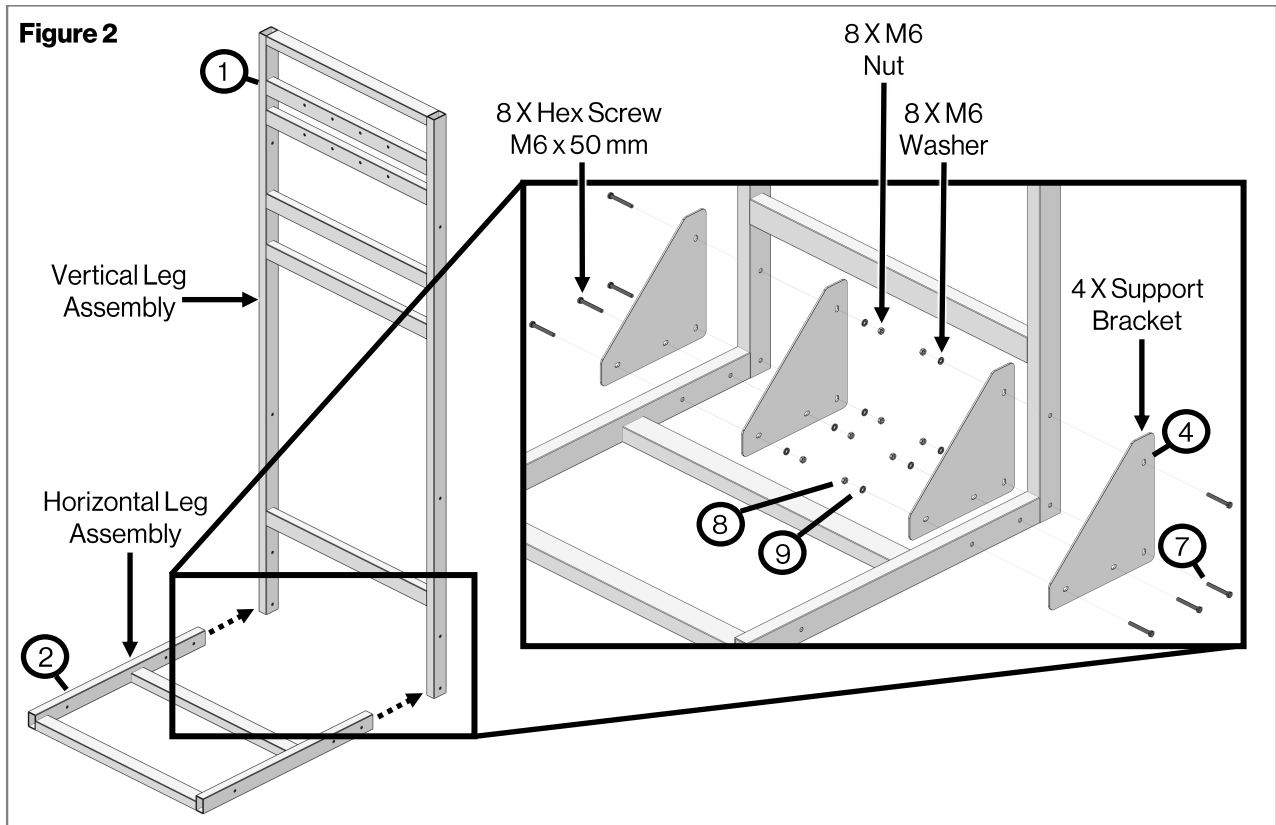

3. Attach six (6) Wall and Floor brackets using six (6) Hex screw M6x50mm, six (6) M6 washers, and six (6) M6 nuts (Figure 3).

4. If needed, use provided twelve (12) Dowels and screws to attach the stand to the wall and/or floor (Figure 4).

NOTE: Install the wall mounting bracket before attaching the stand to the wall and/or floor (see step 5)

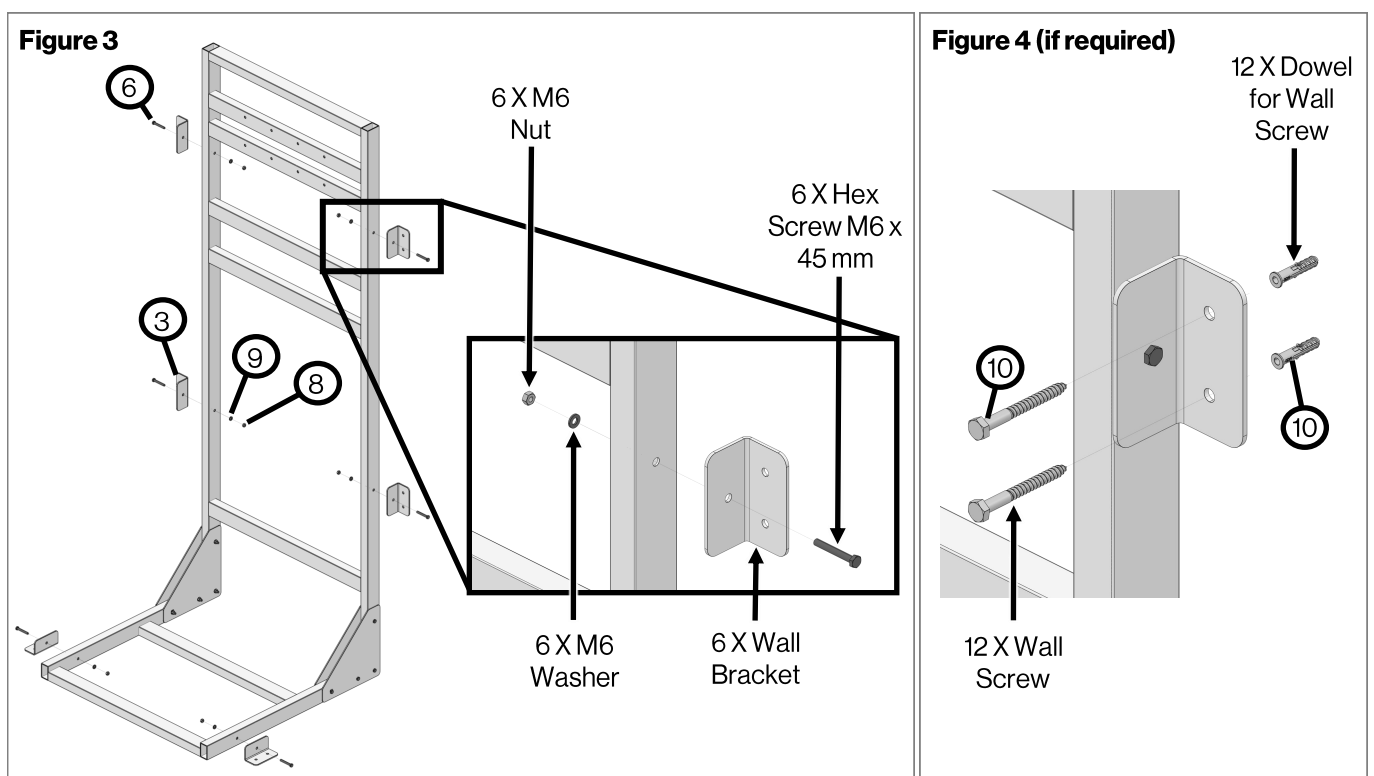

5. Install the wall mount bracket (provided with the boiler) using four (4) Hex Screws M6 x 45MM, four (4) M6 washers, and four (4) M6 nuts (Figure 5). Ensure the mounting bracket is level for proper boiler operation (Figure 6).

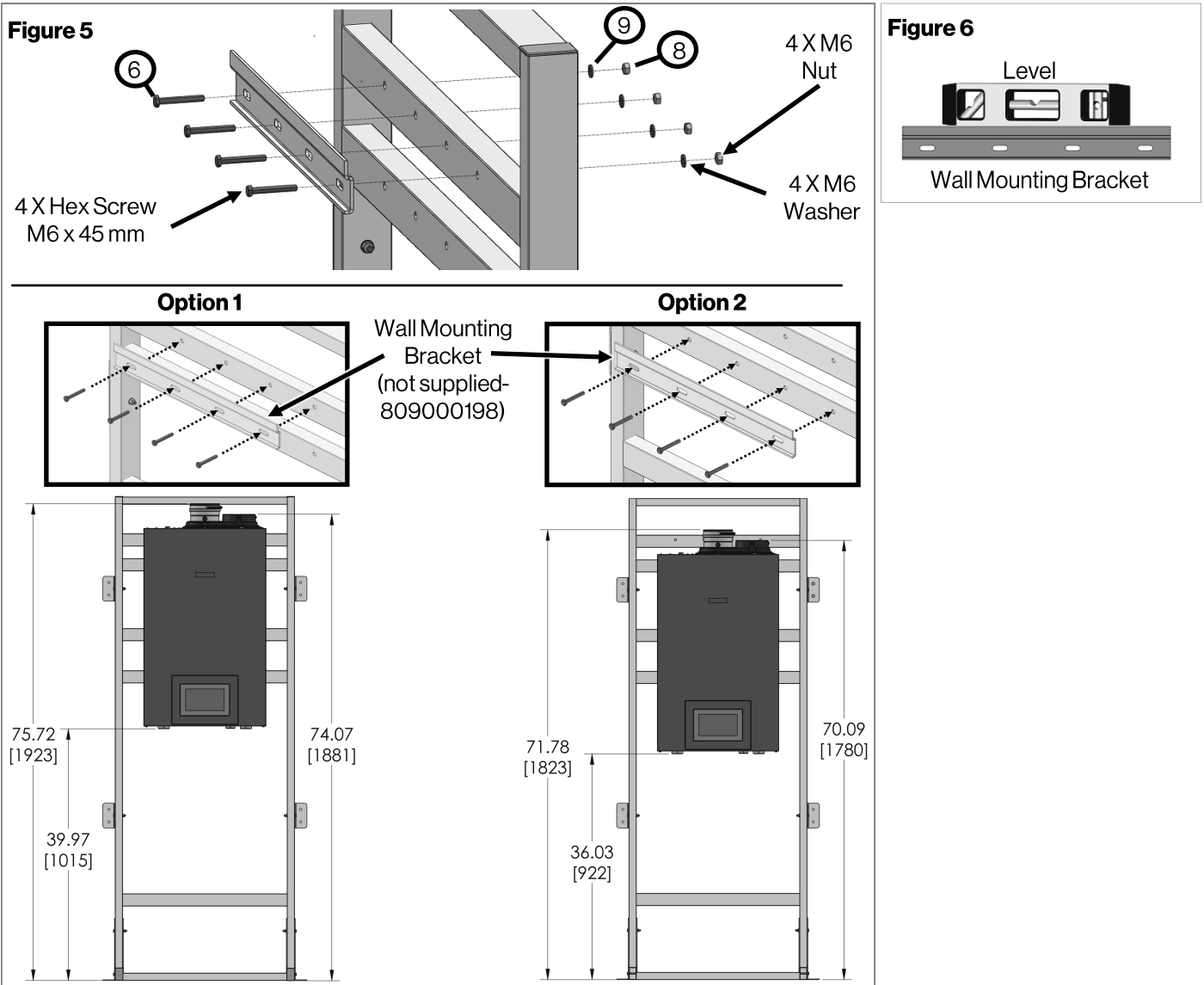

6. Use the four (4) supplied tube caps to cap the vertical and horizontal leg assemblies (Figure 7).
7. To mount wall hung boiler to the stand, install the top bracket into the wall mounting bracket (Figure 8).

IMPORTANT

The boiler must be installed in an upright and level position. Do not install the boiler upside down or on its side.

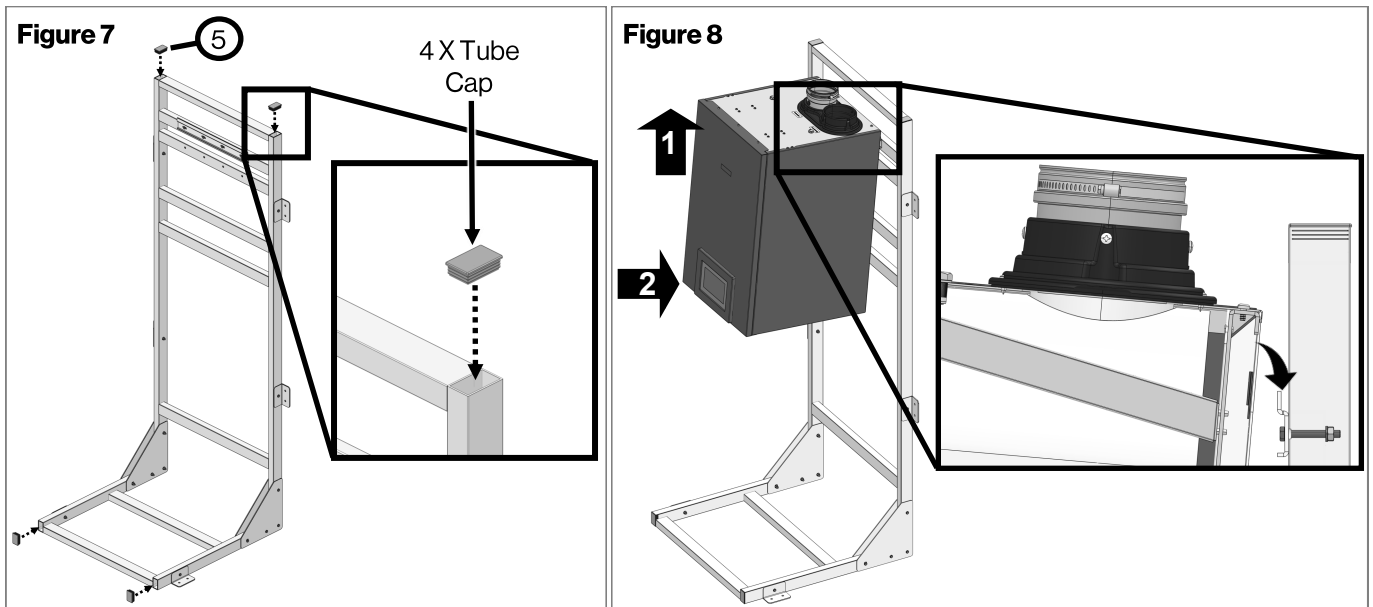

INSTRUCTIONS FOR MULTIPLE STAND INSTALLATION

SIDE-BY-SIDE:

8. Follow all previous steps to install the individual floor stands, except for the items exploded below (support brackets, and wall and floor brackets). Use six (6) of Hex Screw M6 x 80 mm, two (2) support brackets, two (2) wall and floor brackets, six (6) M6 nuts, and ten (10) M6 washers to attached floor stands to each other (side-by-side) [Figure 9]. **NOTE:** Spare screws B, C, and D are not needed for this configuration.

If needed, use provided twenty four (24) dowels and screws to attach the stand to the wall and/or floor (Figure 4).

Figure 9

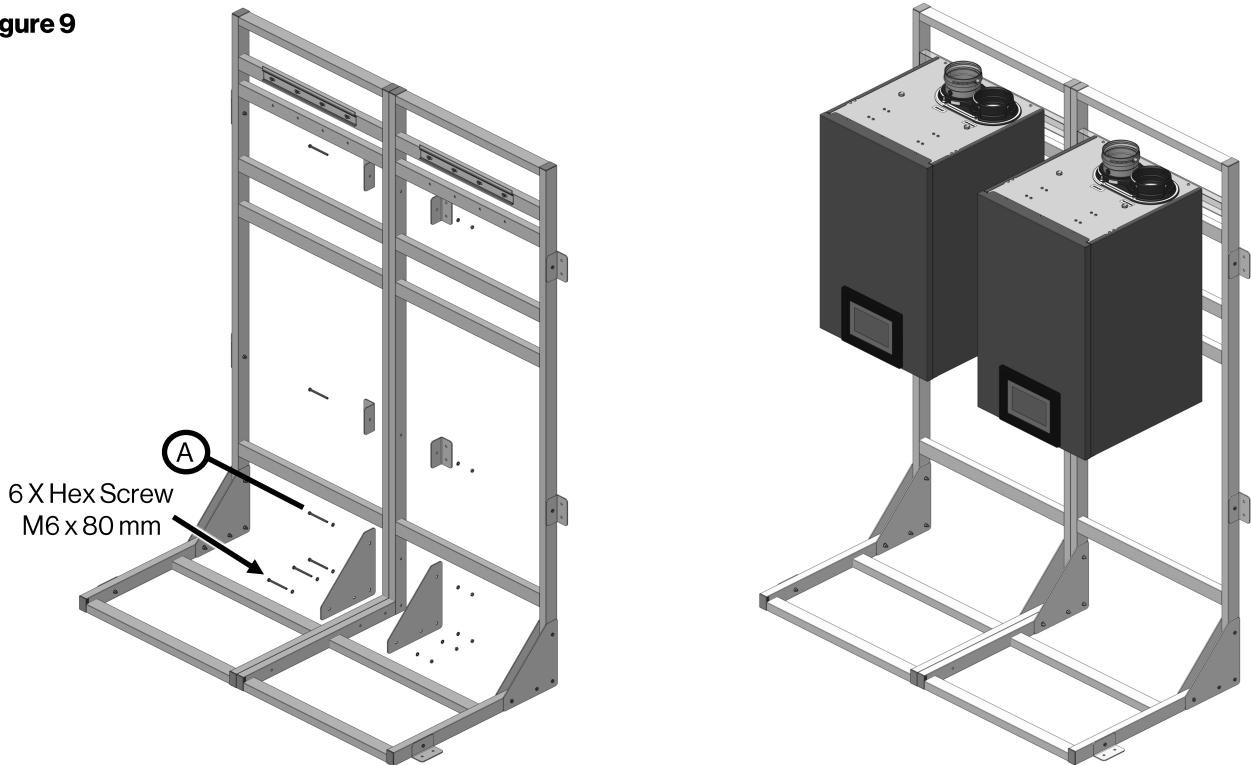

BACK-TO-BACK:

9. Follow all previous steps to install the individual floor stand. Use eight (8) of Hex Screw M6 x 16 mm, eight (8) M6 nuts, and eight (8) M6 washers to attach floor stands to each other (back-to-back). **NOTE:** Spare screws A are not needed for this configuration.

Figure 10

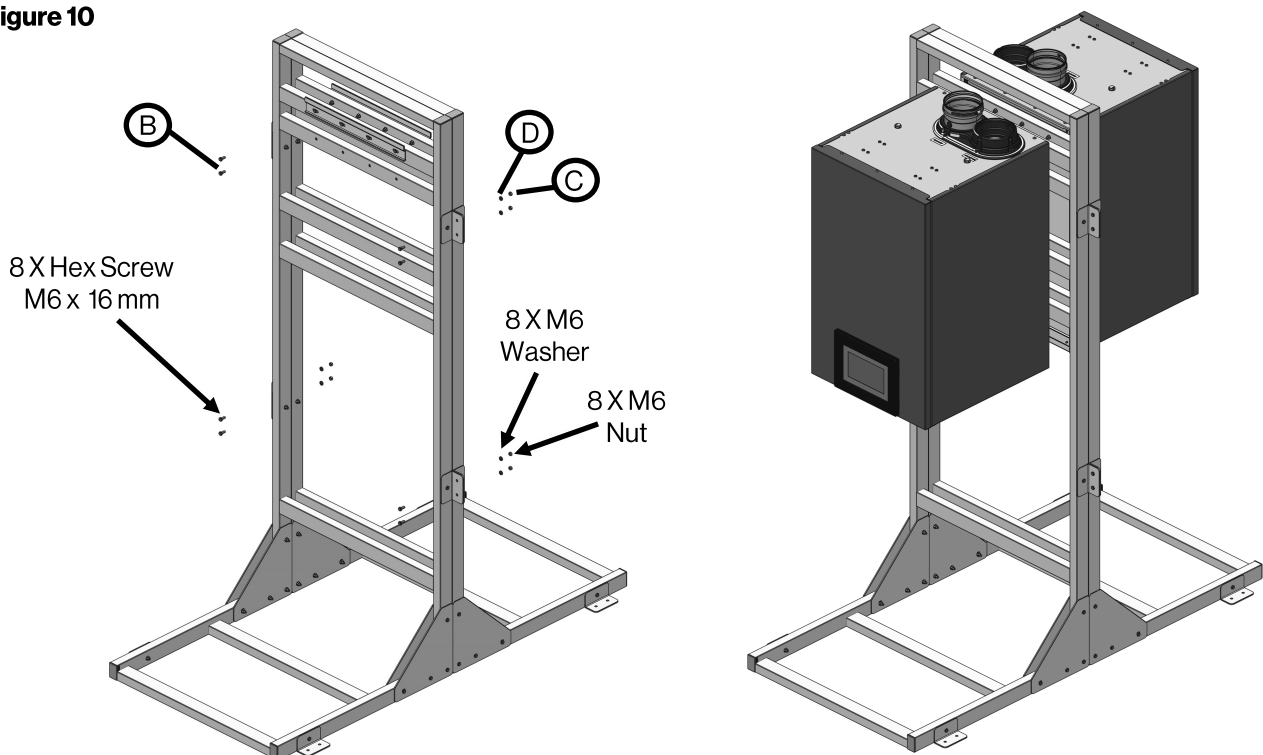

SIDE-BY-SIDE & BACK-TO-BACK:

10. Follow all previous steps to install the individual floor stand and the step to connect stands side-by-side. Use sixteen (16) of Hex Screw M6 x 16 mm, sixteen(16) M6 nuts, and sixteen(16) M6 washers to attached floor stands to each other (back-to-back).

Figure 11

