



## ORIGINAL VAXCEL CEILING FAN LIMITED LIFETIME WARRANTY\*

*\*for full limited lifetime warranty details please see final page of these instructions.*

Model No.: F0136 F0137

### Safety Instructions

READ ALL SAFETY INFORMATION AND INSTALLATION INSTRUCTIONS BEFORE YOU BEGIN TO INSTALL THE FAN AND SAVE INSTRUCTIONS.

- All set screws of the fan must be checked and retightened where necessary before installation.
- To reduce the risk of personal injury, do not bend the blade brackets when installing the brackets, balancing the blades or cleaning the fan. Do not insert foreign objects between rotating fan blades.
- Before changing the fan direction, turn off the fan and wait for the fan blades to stop completely.
- The safeguards provided by these safety instructions and by the separate installation instructions are not meant to cover all possible conditions and situations that may occur. It must be understood that common sense, caution and care are factors which can not be built into this product. These factors must be supplied by the person(s) installing, caring for and operating the fan.

#### **WARNING**

- TO AVOID RISK OF ELECTRIC SHOCK, BE SURE TO SHUT OFF POWER AT THE MAIN FUSE OR CIRCUIT BREAKER BOX BEFORE INSTALLING OR SERVICING THIS FIXTURE. TURNING OFF THE ELECTRICAL POWER BY USING THE LIGHT SWITCH IS NOT SUFFICIENT TO PREVENT ELECTRICAL SHOCK.
- TO REDUCE THE RISK OF INJURY, INSTALL THE FAN SO THAT THE BLADES ARE AT LEAST 7 FEET (2.1 METERS) ABOVE THE FLOOR AND AT LEAST 18 INCHES (0.5 METERS) FROM THE TIP OF THE BLADES TO THE WALL.
- TO REDUCE THE RISK OF FIRE, ELECTRIC SHOCK, OR PERSONAL INJURY, MOUNT TO OUTLET BOX MARKED "ACCEPTABLE FOR FAN SUPPORT" AND USE MOUNTING SCREWS PROVIDED WITH THE OUTLET BOX.
- THE INSTALLATION HAS TO BE IN ACCORDANCE WITH THE NATIONAL ELECTRICAL CODE, ANSI/NFPA 70-1999 AND LOCAL CODES. IF YOU ARE UNFAMILIAR WITH THE METHODS OF INSTALLING ELECTRICAL WIRING, SEEK THE SERVICES OF A QUALIFIED LICENSED ELECTRICIAN.

## Package Contents:

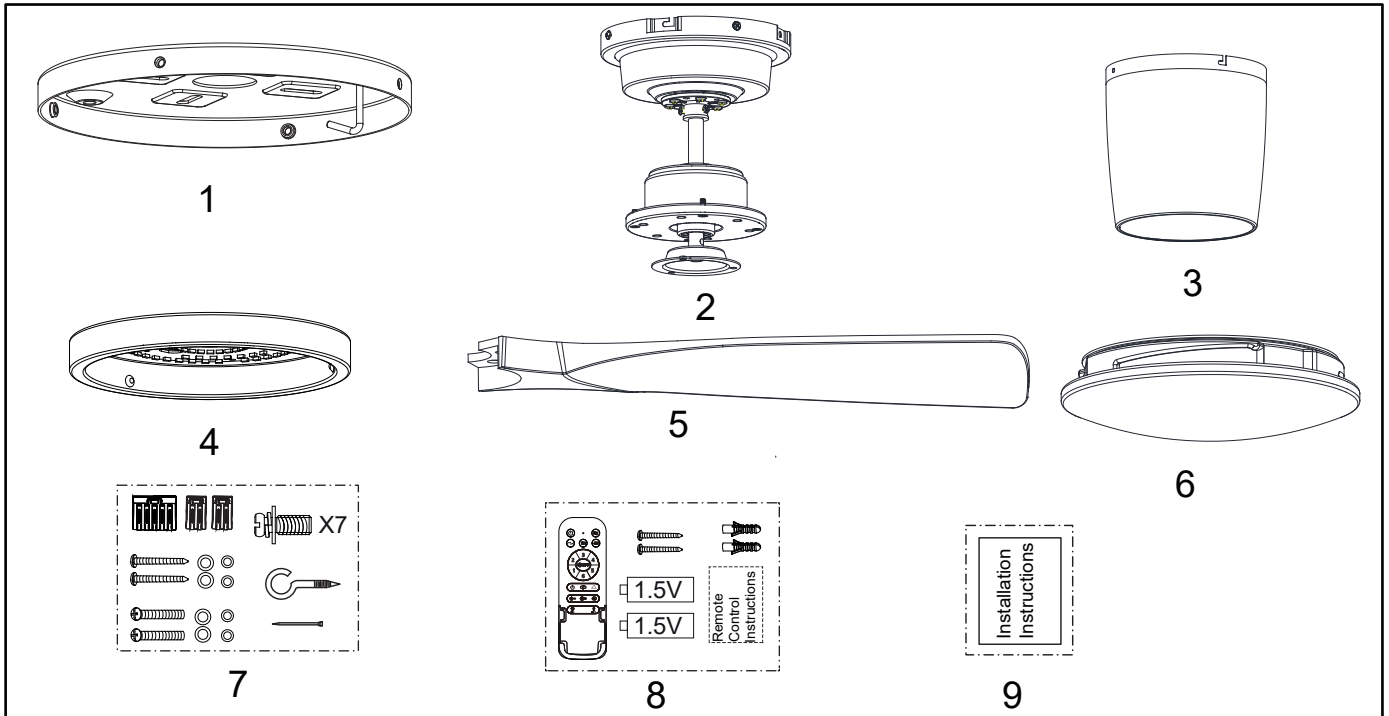

Unpack your fan and check the contents. You should have the following items.

- 1.) Mounting Plate
- 2.) Fan Motor Assembly
- 3.) Housing
- 4.) Light Kit Pan with LED Module
- 5.) Fan Blades (3 PCS)
- 6.) Acrylic Shade
- 7.) Assembly Kit
- 8.) Remote Control Set (Includes Remote Control & Batteries & Screws & Remote Control Instructions)
- 9.) Installation Instructions

## Dimension Reference:

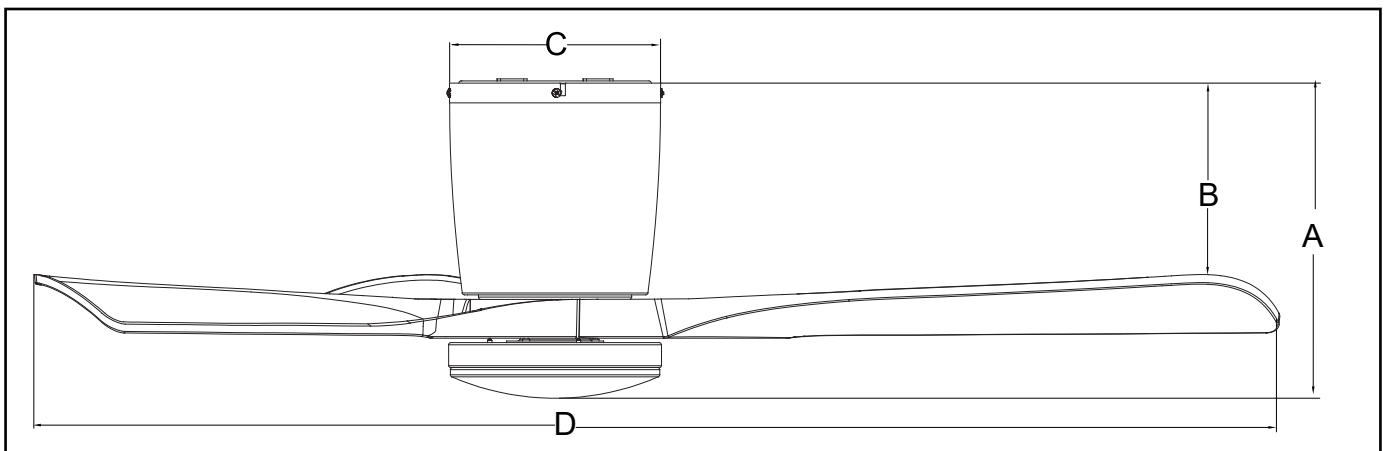

A. 11-1/4" B. 7-1/2" C. 7-1/2" D. 52"

# Exploded View Detail

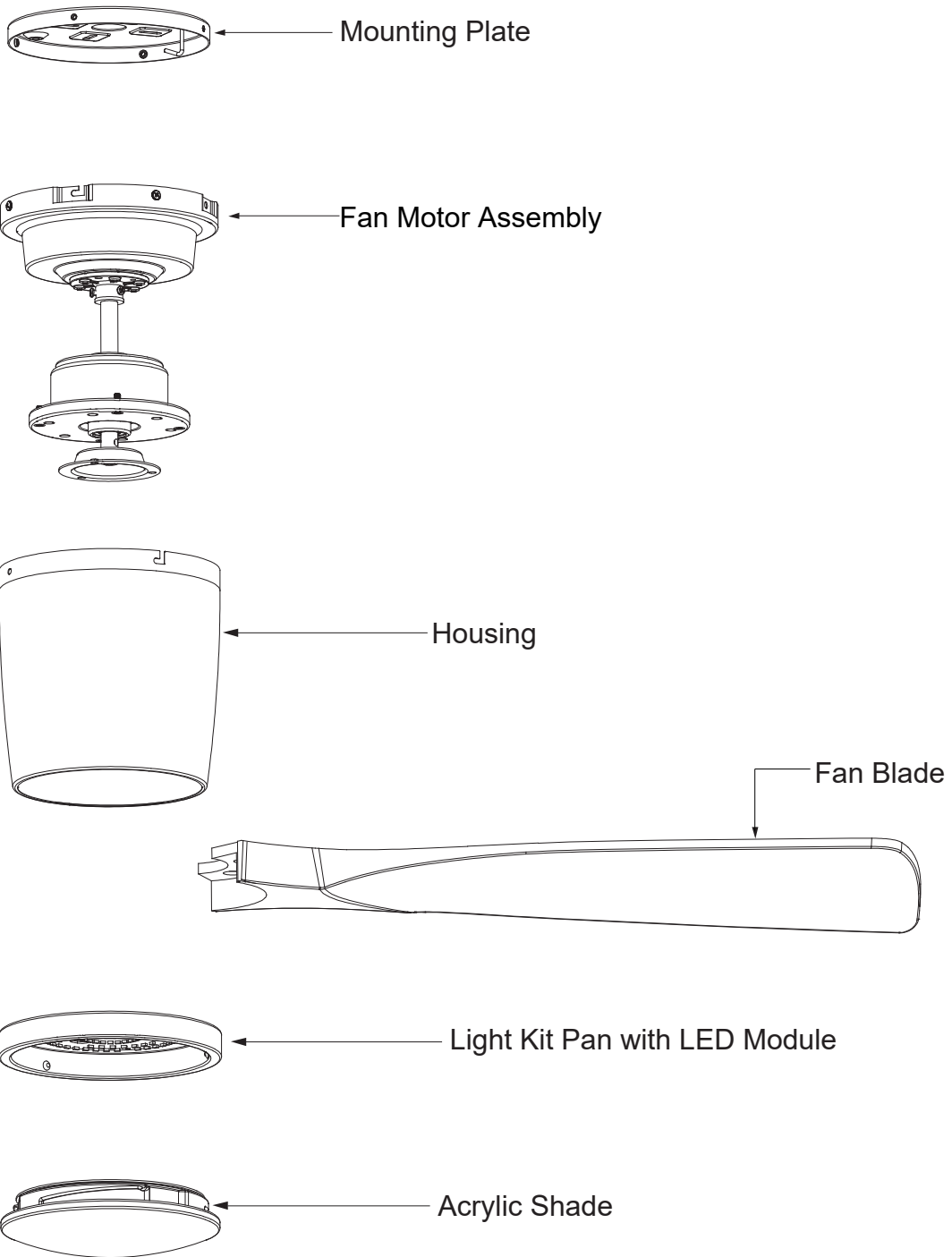

# INSTALLATION INSTRUCTIONS

## IMPORTANT:

- BEFORE YOU BEGIN INSTALLING THE FAN, CAREFULLY READ ALL INFORMATION IN THE SEPARATE SHEET PAGE 4 "SAFETY INSTRUCTIONS" AS WELL AS THE FOLLOWING "INSTALLATION INSTRUCTIONS". IF IN DOUBT, CONSULT A QUALIFIED ELECTRICIAN.
- SAVE ALL INSTRUCTIONS.

NOTE: The fan weight is 10.24 lbs (4.64 kg). Be sure the outlet box you are using is securely attached to the building structure and can support the full weight of the fan. Failure to do so can result in serious injury.

## Installation Steps:

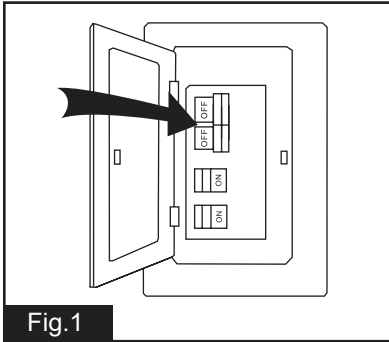

Turn OFF the electric power at the main fuse or circuit breaker box.

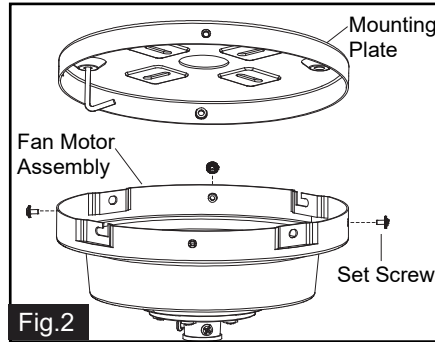

Unscrew the four set screws for later use, remove the mounting plate from the fan assembly.

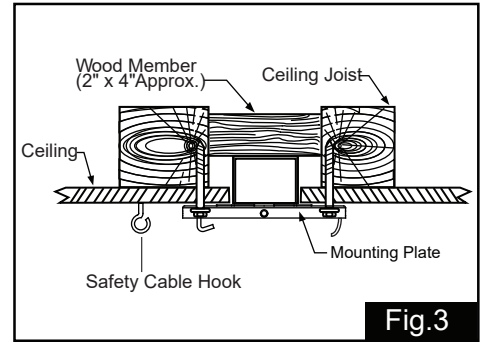

Tighten the mounting plate to the outlet box with two mounting screws. **(Make sure the outlet box is securely installed so that it will be able to support at least the fan weight.)** Attach the safety cable hook to the ceiling and make sure the safety cable hook is covered by the fan canopy. Pull the electrical wires from the outlet box through the center hole of the mounting plate for motor wiring installation. **WARNING: MOUNT ONLY TO AN OUTLET BOX MARKED "ACCEPTABLE FOR FAN SUPPORT"!**

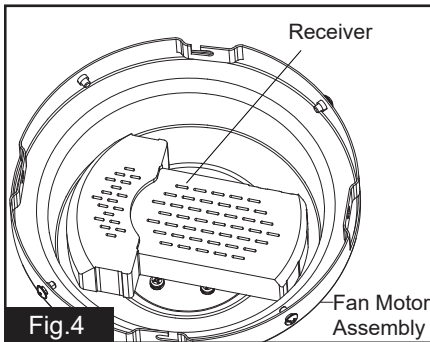

The receiver is already fixed in the housing.

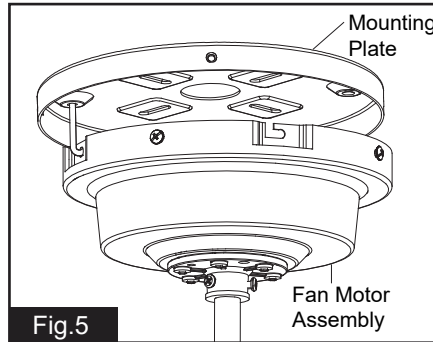

Carefully lift the fan motor assembly and hang the fan motor assembly on the hook of the mounting plate by utilizing one of the holes at the outer rim of the motor assembly so that it is securely suspended. Then connect the wiring to your fan according to step 6 "Making the Electrical Connections".

## Making the Electrical Connections:

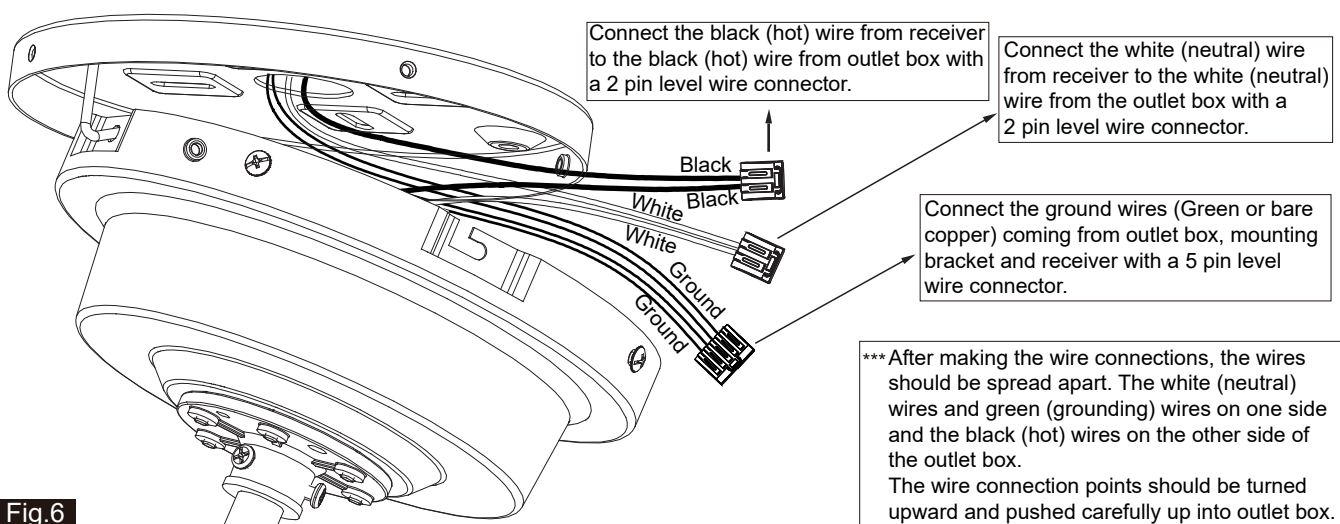

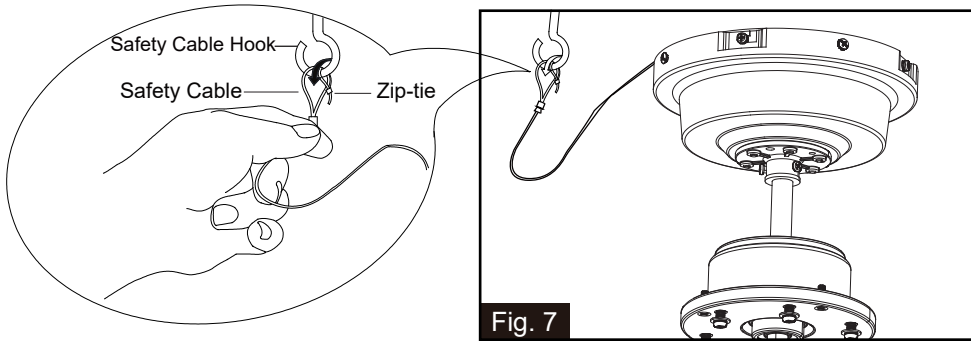

Hang the safety cable into the safety cable hook, tighten the safety cable to the safety cable hook by using the zip-tie.

Fig. 7

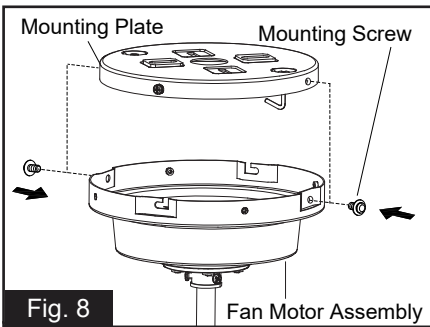

Fig. 8

- 1) There are four mounting screws. Remove two screws from the mounting plate (one from each side) and loosen the other two remaining screws.
- 2) Remove the fan motor assembly from the hook of the mounting plate then align the "L shaped" slots of the fan motor assembly with the two remaining screws on the mounting plate and push the fan motor assembly upwards to engage the slots and turn clockwise to lock in place.
- 3) Tighten the screws and install the other two mounting plate screws into the remaining holes of the fan motor assembly and tighten.

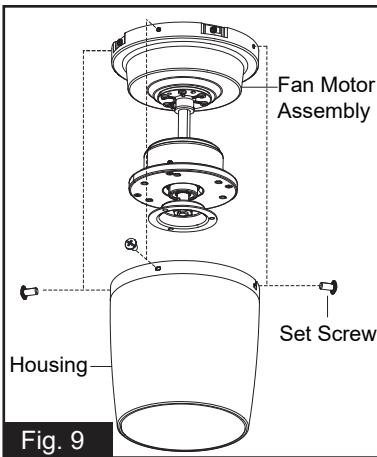

Fig. 9

The housing has two mating slots and two mating holes. Position both slots on the housing directly under and in line with two screws in the mounting bracket. Lift the housing, allowing the two screws to slide into the mating slots. Rotate the housing counterclockwise until both screws from the fan motor assembly drop into the slot recesses. Tighten screws securely. Install the other two screws into the mating holes of the fan motor assembly and tighten to secure the housing to the fan motor assembly.

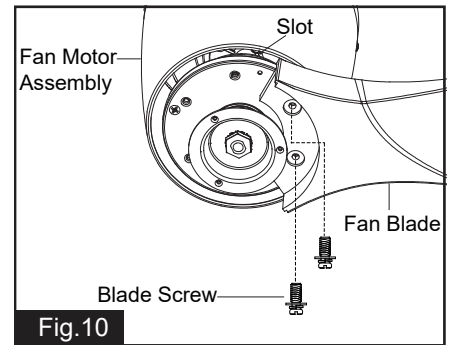

Fig. 10

Mount each fan blade using two blade screws.

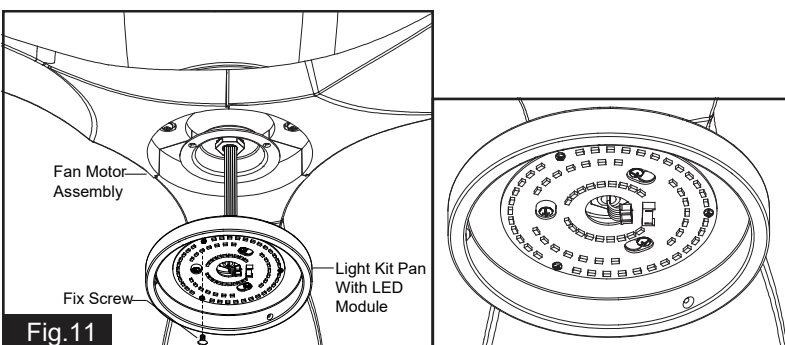

Fig. 11

Remove one screw (for later use) and loosen the other two screws from light kit pan with LED module first, then connect the pin connector from fan motor assembly to the pin connector from the LED module assembly.

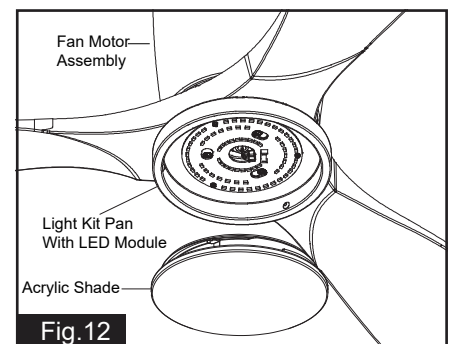
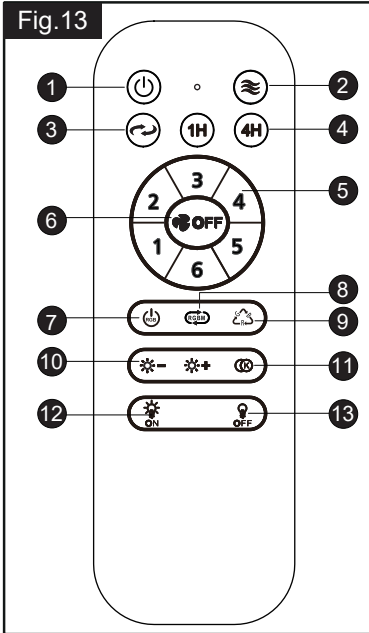

Fig. 12

Attach the acrylic shade to the light kit pan with LED module by aligning studs and slots, and then turn it clockwise until it is locked in place.

Fig.13



### Remote Control

Install two 1.5 volt batteries (type AAA, included) into the remote control.

Remote Control functions:

1. "⏻" Button:  
Press this button to turn the fan and the light off.
2. "🌀" Breeze button:  
Press the breeze button to cycle the fan speed. The fan will cycle through all 6 speeds in 20 seconds. If the fan is off the cycle will start at minimum "1" speed and increase until high speed "6" is reached, then cycle slowly back down to minimum speed "1". Again, then repeat. If the fan is on then the breeze cycle will start at that speed. To stop this function press any other fan speed or fan off button.
3. "↺" Reverse button:  
Press this button to control fan direction.  
Please wait, as the reverse function takes time to adjust.
4. Timer Control:  
Press "1H", "4H" timer button to turn off the fan and light for the selected duration.  
Press any other button, or turn off the electric circuit at the main fuse or circuit breaker box can stop this function.

#### 5. Fan speed:

- |                   |                       |                      |
|-------------------|-----------------------|----------------------|
| 1 = minimum speed | 2 = low speed         | 3 = medium low speed |
| 4 = medium speed  | 5 = medium high speed | 6 = high speed       |

#### 6. "OFF" Button:

Press this button to turn the fan off.

#### 7. "RGB" Button:

Press this button to turn RGB mode off.

#### 8. "RGBM" Button:

Press this button to change RGB party mode, there are a total 11 RGB party modes to choose from.

#### 9. "RGB" Button:

Press this button to change to a single solid RGB color. There are a total 7 colors to choose from.

#### 10. Dimmer Function:

Press and hold the "☀️ - " button to decrease brightness to the desired level.

Press and hold the "☀️ + " button to increase brightness to the desired level.

#### 11. "K" button:

Press and hold the button to infinitely switch the color temperature, then release when the desired color temperature is reached.

#### 12. "ON" Button:

Press this button to turn the CCT (Correlated Color Temperature) light on.

#### 13. "OFF" Button:

Press this button to turn the CCT (Correlated Color Temperature) light off.

### Note:

**This remote control has a memory function setting. The fan will operate at the same speed and the fan light will stay at the same brightness-level as the last time the power supply was turned off.**

### Set the code:

Within the 10 second time frame after the main power is turned on, press and hold FAN OFF button for more than 3 seconds. The LED light will begin to flash. Once the code is set successfully, the fan will turn off and the light will turn on.

**Note: The included remote control was paired with the receiver at the factory with default settings, so you should not need to pair the remote unless the connection with the fan is lost.**

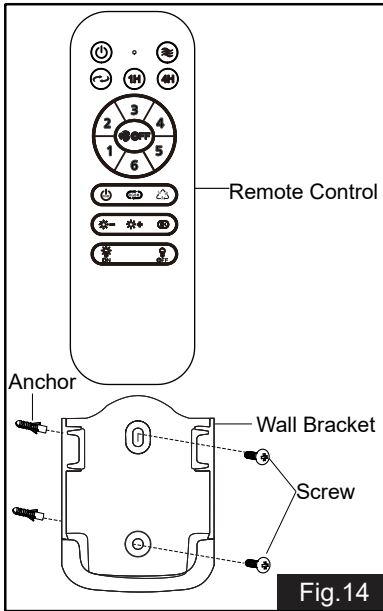

Install the remote control wall bracket on the wall with two anchors and two screws and place remote control in it carefully.

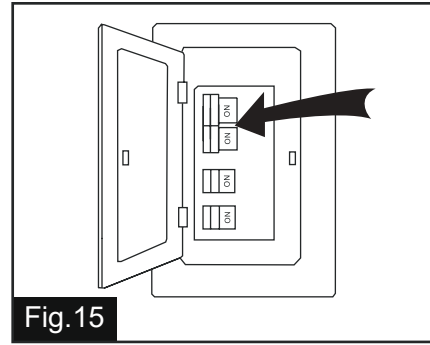

Turn ON the electric circuit at the main fuse or circuit breaker box.

## Troubleshooting Guide

If you have difficulty operating your new ceiling fan, it may be the result of incorrect assembly, installation or wiring. In some cases, these installation errors may be mistaken for defects. If you experience any faults, please check this Troubleshooting Guide. If a problem cannot be remedied or you are experiencing difficulty in installation, please call our Customer Service Department (1-800-482-9235).

PROBLEM	SUGGESTED REMEDY
1. If fan does not start:	<ol style="list-style-type: none"><li>1. Check main and branch circuit fuses or circuit breakers.</li><li>2. Check line wire connections to fan and switch wire connections in switch housing. <b>CAUTION: Make sure main power is turned off.</b></li><li>3. Make sure that the wall control is turned "ON".</li></ol>
2. If fan sounds noisy:	<ol style="list-style-type: none"><li>1. Make sure all screws in motor housing are snug. (not too tight)</li><li>2. Make sure the screws which attach the fan blade to the motor are tight.</li><li>3. Make sure wire connectors in switch housing are not rattling against each other or against the interior wall of the switch housing. <b>CAUTION: Make sure main power is turned off before accessing switch housing.</b></li><li>4. Some fan motors are sensitive to signals from Solid State variable speed controls. DO NOT USE a Solid State variable speed control.</li><li>5. Allow "break-in" period of 24 hours. Most noises associated with a new fan will disappear after this period.</li></ol>
3. If fan wobbles:	<p>All blades are weighed and grouped by weight. The following procedures should eliminate most of the wobble. Check for wobble after each step.</p> <ol style="list-style-type: none"><li>1. Check that all blades are screwed firmly into fan motor assembly.</li><li>2. Make sure that mounting plate is tightened securely to ceiling junction box and junction box is mounted firmly to ceiling joist.</li><li>3. If blade wobble is still noticeable, interchanging two adjacent (side by side) blades can redistribute the weight and possibly result in smoother operation.</li></ol>
4. If light does not work:	<ol style="list-style-type: none"><li>1. Check black wire from fan to make sure it is connected to hot wire from supply wire coming out of the ceiling.</li><li>2. Check for loose or disconnected wires in fan switch housing.</li><li>3. Check for loose or disconnected wires in light kit.</li><li>4. Check for faulty the LED module. <b>CAUTION: Make sure main power is turned off before accessing switch housing.</b></li></ol>
5. If fan and light kit do not work:	<ol style="list-style-type: none"><li>1. Replace the batteries of remote control.</li><li>2. Re-pair the remote control and receiver by holding the "  OFF " button on the remote control according to the manual.</li></ol>

# ORIGINAL VAXCEL CEILING FAN LIMITED LIFETIME WARRANTY\*

The limited lifetime warranty covers this fan, for residential use by the original purchaser, against defects in material or workmanship as follows:

If your fan motor fails at any time during the lifetime of the original purchaser due to defects in material or workmanship, we will provide a replacement part free of charge.

If your fan motor fails at any time within one year after the original date of sale to the original purchaser due to defects in material or workmanship, we will provide labor to repair the defect, with the exception of take down/reinstallation, free of charge. The original purchaser will be responsible for all labor costs after this one year period.

If no replacement parts are provided for any part of your fan motor that fails at any time during your lifetime due to defects in material or workmanship, we will refund the original purchase price of your fan.

If your fan includes any integrated LED modules, the LED functionality is covered by a 5-year warranty.

If your fan blades, or any accessory, except glass globes and light bulbs, fails at any time within one year after the original date of purchase due to a defect in material and workmanship, we will repair or replace the defective blades, switch, or accessory free of charge, with the exception of take down/reinstallation services.

If the original purchaser ceases to own the fan, this warranty and any implied warranty, including but not limited to any implied warranty of merchantability or fitness for a particular purpose, become void. This warranty and any implied warranty, including but not limited to any implied warranty of merchantability or fitness for a particular purpose, does not cover glass globes, light bulbs, or finish on any metal portions of the fan.

This warranty is in lieu of express warranties. The duration of any implied warranty of merchantability or fitness for a particular purpose, with respect to any fan motor, blades, switch, or accessories, is expressly limited to the period of the express warranty set forth above for such motor, LED modules, blades, switch, or accessories.

This warranty excludes defects, malfunctions, or failures of any fan that are caused by repairs by persons not authorized by us, use of parts or accessories not authorized by us, mishandling, improper installation, modifications or damage to the fan while in your possession, or unreasonable use, including failure to provide necessary maintenance. This warranty does not include the failure of products from extreme acts of nature; environmental conditions not suited for the products intended use; operation in temperatures outside of the range specified in the instruction manual; usage with improper power supply, power surges or dips. For coastal locations, some corrosion is considered normal for the environment.

In no event shall VAXCEL be liable for consequential or incidental damages.

Some states do not allow the exclusion or limitation of consequential or incidental damages, in which case the above limitation or exclusion may not apply. This warranty gives you specific legal rights and you may also have other rights which vary from state to state.

Vaxcel reserves the right to repair, replace or issue a credit for any properly installed product, provided it is returned per RMA instruction. This warranty is limited to the cost of the product only and does not extend to transportation, installation or replacement costs.

How can warranty service be obtained for your ceiling fan?

[info@vaxcel.com](mailto:info@vaxcel.com)

1-800-482-9235