

Cautions:

1. Do not use an electric generator to test the LED luminaire.
2. Make all electrical and grounded connections in accordance with the National Electric Code and any applicable local code requirements.
3. Turn off the power before installation or maintenance.
4. Proper earth grounding is required to ensure safety.







Notice:

1. To avoid possibility of electrical shock or fire, installation, service and maintenance of luminaires should be performed by a qualified licensed electrician.
2. Wear gloves and safety glasses at all times when installing, servicing or performing maintenance.
3. If any smoking or sparking of wiring is seen, turn off the power immediately and notify relevant personnel.

Attention:

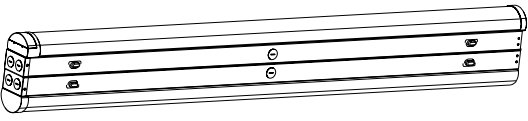
1. Check for any damage that may have occurred during shipping. If seen, contact manufacturer.
2. Read the installation instruction carefully to ensure all parts and accessories are complete. After confirmation, install the fixture according to installation steps.

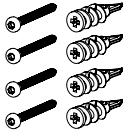
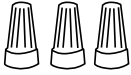
What's In The Box

 <p>LSC28F80SUS8</p>	 <p>Cover Plate</p>	 <p>Four (4) Mounting Screws with Anchors</p>	 <p>Three (3) Wire Nuts</p>	 <p>Two (2) bolts and nuts</p>
--	--	---	--	---

Tools Needed

The LSC2 requires very few tools for installation. A screwdriver, a pair of wire strippers, and a drill will help to install the fixture.



! Make sure all power is turned off before beginning installation

1 Carefully unpack the fixture from its packaging. Inspect product for defects due to shipping.

2 Locate desired positioning for the fixture on the mounting surface.

3 Turn off power to appropriate circuit at the breaker box.

Surface Mounting

4 Drill holes in the mounting surface at the corresponding positions and drive the screw anchors into the holes.

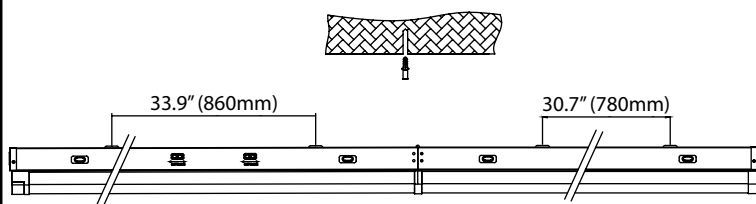

5 Unfold the luminaire as shown below. Be careful to not pinch hands between sections.

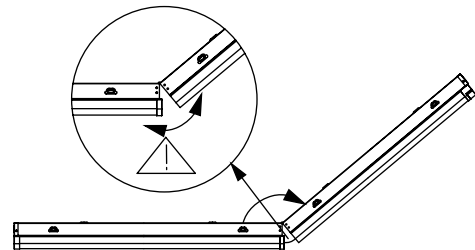

6 Install the cover plate onto the fixture as shown. (This step can be omitted if the fixture completely covers the junction box.)

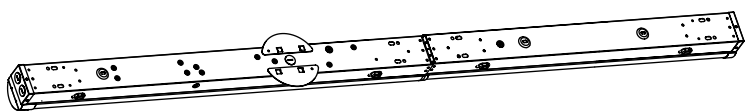

7 Remove the fixture lens by pressing the buttons on each side of the fixture. Use included screws to lock the hinge brackets together.

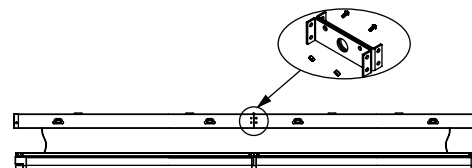

- 8 Lead the wire into the lamp and install the lamp chassis by using the screws in the accessory kit.

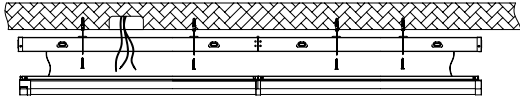

- 8a Connect the wires according to safety requirements

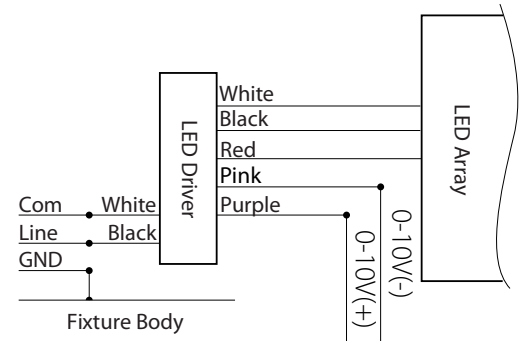

- 9 Install the luminaire lens back to the body. Pressing up will snap lock the buttons back into place. If there is a slight gap between the lens and body, the lens can be slid to close the gap. Adjust CCT and Wattage as necessary via switches on side of fixture.

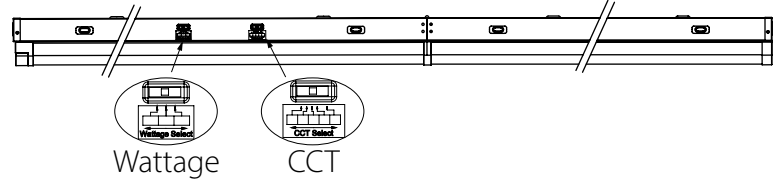
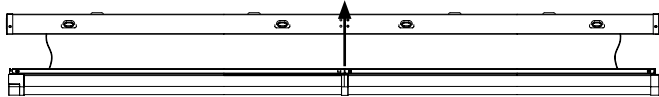

Suspended Mounting

- 4 Hang the cable on the ceiling strut (Paddle style sold separately. Other styles must be purchased elsewhere).

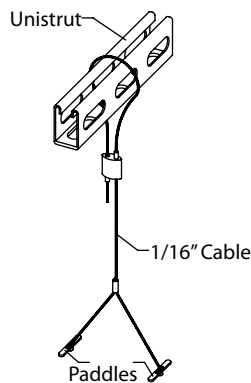

- 5 Unfold the luminaire as shown below. Be careful to not pinch hands between sections.

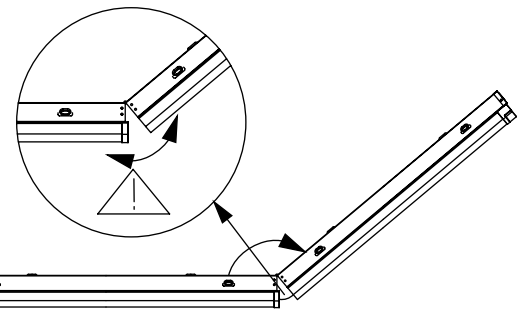

- 6 Remove the fixture lens by pressing the buttons on each side of the fixture. Use included screws to lock the hinge brackets together.

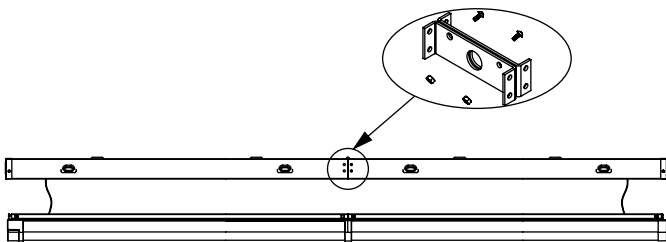

- 7 Install the luminaire onto the cables. Connect the wires per step 8a above. Install the lens back on to the body (step 9 above).

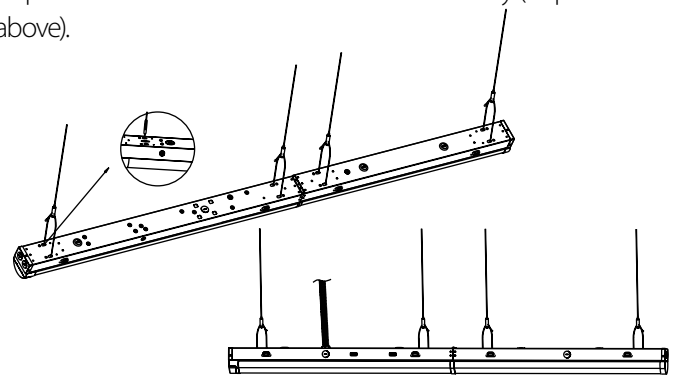

Continuous Run

- 1 Use the screws in the accessory kit to lock the continuous run bracket on to one luminaire.

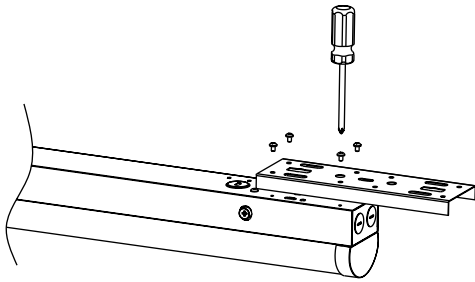

- 2 Align the other luminaire to the bracket and lock the screws.

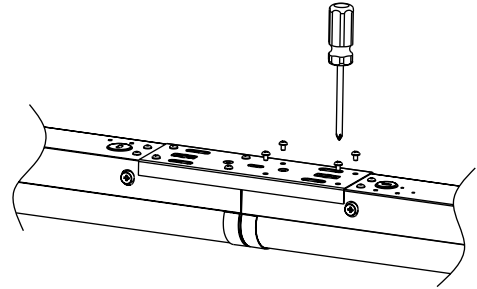

Connect to maximum 6pcs

3.5mm Jack Microwave Sensor Installation

- 1 Press the outside of the empty sensor cover by hand to take it off.

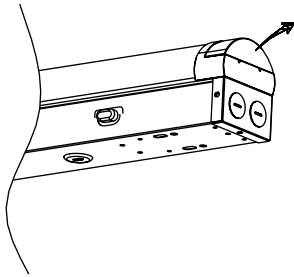

- 2 Plug the DC sensor into the corresponding hole on the lamp. (Make sure the sensor sign facing outward).

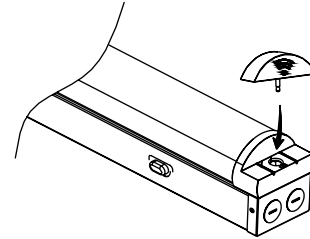

Behind lens, Snap-in Microwave Sensor Installation

- 1 Press the buttons on both sides of the luminaire to release the lens.

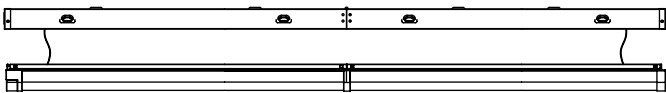

- 2 Remove sticker or knock out socket on back of lens.



- 3 Snap in the microwave sensor.

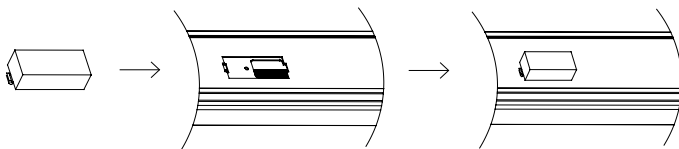

- 4 Connect the sensor wires according to the diagram. Harness wires connect to driver wires. Harness connector snaps into back of sensor. Reinstall lens when complete.

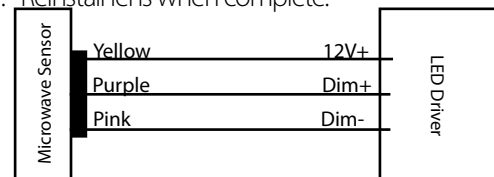

NLC Compatible Microwave Sensor Installation

- 1** Press the buttons on both sides of the luminaire to release the lens.



- 2** Remove sticker or knock out socket on back of lens.



- 3** Using the double sided tape, adhere the sensor to the mounting bracket. Then adhere the bracket to the fixture such that the sensor is seeing out through the opening in the fixture.

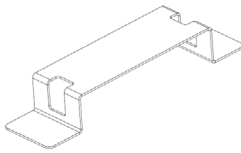

- 4** Identify the location for the bluetooth module. This module must be mounted as far from the sensor as is allowed by the wiring harness and fixture design. A minimum distance of 1 foot (305mm) is required.

- 5** Wire per wiring diagram. Reinstall lens when complete.

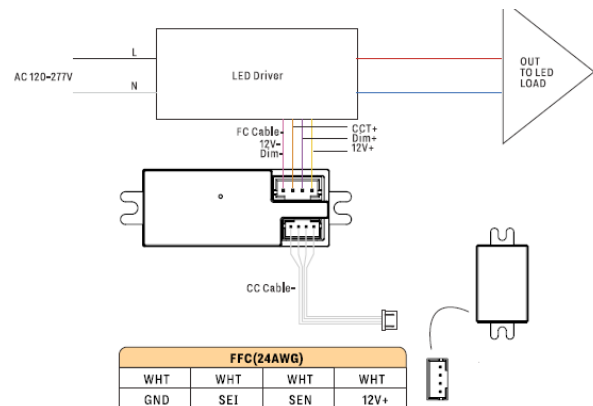

This device complies with part 15 of the FCC Rules. Operation is subject to the following two conditions: (1) This device may not cause harmful interference, and (2) this device must accept any interference received, including interference that may cause undesired operation.

NOTE: This equipment has been tested and found to comply with the limits for a Class A digital device, pursuant to part 15 of the FCC Rules. These limits are designed to provide reasonable protection against harmful interference when the equipment is operated in a commercial environment. This equipment generates, uses, and can radiate radio frequency energy and, if not installed and used in accordance with the instruction manual, may cause harmful interference to radio communications. Operation of this equipment in a residential area is likely to cause harmful interference in which case the user will be required to correct the interference at his own expense.

LED EXPRESS LIMITED WARRANTY

Subject to the exclusions below, each NICOR LED product, including the LED electronics and components of a property installed NICOR LED product, will be free from defect in materials and workmanship for a period of five (5) years from the original date of purchase. The product shall be considered defective only if 10% or more of the product's LED components fail. NICOR LED product warranty covers the following performance criteria: LED Light Output will be maintained above 70% of initial output; LED color temperature will not shift more than 200K in CCT; LED driver will operate within NICOR specifications; and the fixture finish, excluding natural aluminum or brass products, will not exhibit cracking, peeling, excessive fading, or corrosion during the warranty period. Exceptions apply as defined in NICOR's product specification sheets, which are incorporated by reference herein.

This limited warranty is provided to you, the purchaser of the product identified on Seller's invoice, as your exclusive remedy and applies only to NICOR products that have been purchased from an authorized NICOR Distributor; the product was new and in an unopened NICOR package at the time of installation; and the NICOR product was installed by a licensed electrician or under the supervision of a licensed electrician and used by consumers in the United States or Canada when accompanied with this warranty. This warranty extends only to the first consumer purchaser and is not transferable. A consumer wishing to invoke the terms of this limited warranty must first obtain a RGA number within 30 days of discovery of the defect, and return the product to NICOR for inspection. Once verified to be covered by this limited warranty, NICOR will, at its sole discretion, repair, replace, or refund the purchase price of any product that does not conform to this limited warranty. If NICOR, at its sole discretion, determines that the product should be repaired or replaced, this warranty is limited to the reasonable, customary, and necessary costs and expenses associated with the repair/replacement. This warranty requires that all repair/replacement estimates and costs, including but not limited to equipment rental (if any), and any other cost or expense to be incurred in the repair/replacement of the product, be approved in advance and in writing by NICOR.

FAILURE TO OBTAIN NICOR'S ADVANCE WRITTEN APPROVAL OF ALL REPAIR/REPLACEMENT COSTS AND EXPENSES IN WRITING SHALL VOID THIS LIMITED WARRANTY.

THIS LIMITED WARRANTY DOES NOT COVER THE FOLLOWING:

- Defects or damages resulting from improper installation, operation, storage, misuse or abuse, accident, or neglect;
- Defects or damages resulting from improper service, testing, adjustment, installation, maintenance, alteration, connection to out-of-specification electrical service, corrosive or damp environments, or connection to incompatible equipment or devices (e.g., connecting non-dimmable lighting products to dimmers);
- Damage which occurs in transit;
- Power surges or overheating due to external conditions
- Acts of nature including but not limited to lightning strikes

ANY IMPLIED WARRANTIES, INCLUDING WITHOUT LIMITATION, THE IMPLIED WARRANTIES OF MERCHANTABILITY AND FITNESS FOR A PARTICULAR PURPOSE SHALL BE LIMITED TO THE DURATION OF THIS LIMITED WARRANTY, OTHERWISE THE REPAIR, REPLACEMENT, OR REFUND AS PROVIDED UNDER THIS EXPRESS LIMITED WARRANTY IS THE EXCLUSIVE REMEDY OF THE CONSUMER, AND IS PROVIDED IN LIEU OF ALL OTHER WARRANTIES, EXPRESS OR IMPLIED. IN NO EVENT SHALL NICOR BE LIABLE, WHETHER IN CONTRACT OR IN TORT (INCLUDING NEGLIGENCE) FOR DAMAGES IN EXCESS OF THE PURCHASE PRICE OF THE PRODUCT, OR FOR ANY INDIRECT, INCIDENTAL, SPECIAL OR CONSEQUENTIAL DAMAGES OF ANY KIND, OR LOSS OF REVENUE OR PROFITS, LOSS OF BUSINESS OR OTHER FINANCIAL LOSS ARISING OUT OF OR IN CONNECTION WITH THE ABILITY OR INABILITY TO USE THE PRODUCT TO THE FULL EXTENT THESE DAMAGES MAY BE DISCLAIMED BY LAW.