

# NLCW

## NLC Wireless Control Switch

### Product Description

The NLC Bluetooth Wireless Wall Switch Series offers two unique switch designs in 3-button and 5-button configurations. Both provide wireless remote control of NLC enabled luminaires as a handheld device or wall-mounted switch. Setup and commissioning requires the NICOR NLC mobile app (iOS and Android). For wall mounting, add the NLCWP wall switch base with faceplate.

#### Construction

- Housing material is made of UL 94 V-0
- IP20

#### Network Technology

- Bluetooth Low Energy (BLE) 4.2 / 5.0 with mesh networking
- Bluetooth range: up to 100ft (line of sight)
- Commissioned via NICOR NLC app (iOS and Android compatible)
- UL1376 Cyber Security Certification

#### Electrical

- Input voltage: 3VDC
- Powered by two CR2032 3 Volts batteries
- Low Power Warning: 2.6V
- Operating temperature rating: -14°F to 113°F (-10°C to 45°C)
- Operating humidity: 0 - 90% RH

#### Listings

- DLC Listed
- RoHS

#### Warranty

- 5-year limited system warranty standard

Project

Catalog

Type

Date

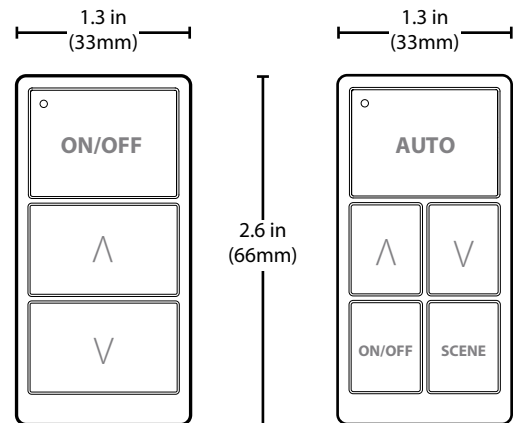

### Ordering Information

Example: NLCW31WH

Series	Product Type	No. Buttons	Version	Finish
NLC	W (Wireless Switch)	3 (12 volts Supply)	1	WH (White)
		5 (12 volts Supply)		

Specifications and dimensions subject to change without notice.

## Button Configurations

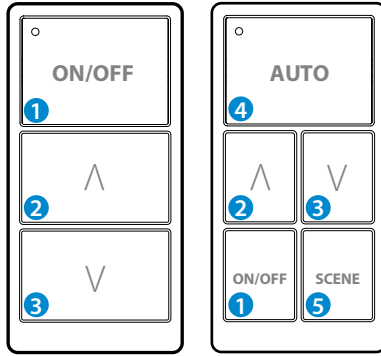

- 1 On / Off
- 2 Dimming switch - Up
- 3 Dimming switch - Down
- 4 Sensor Switch: On / Off
- 5 Scene Switch:  
Up to three scenes set up via App Configurations.