

READ ALL INSTRUCTIONS BEFORE INSTALLING SYSTEM.

Before beginning installation, ensure that the power is OFF or unplugged.

PowerSync power supplies have centralized control features. You can connect up to a maximum of 10 PowerSync power supplies to be connected for higher wattage applications and can be controlled by 1 controller in a wired application or 1 receiver and up to 8 controllers in a wireless application

Central Control with Wireless Receiver

1. Plug in the Central Control Wireless Receiver **L-PSWLS-RCW-1** to the pink central control port.
2. Then pair a wireless controller for control of the 5 power ports and 1 amp port of the power supply for the 60W or 96W models. Or pair a wireless controller to control all 6 ports of the 36W models.
3. Plug in the lights.
4. Turn the power ON or plug in the power supply.
5. Add up to 10 power supplies with a **L-PSLINK-79-1** central control link cord.

Caution:

Loading power of all output ports should not exceed power of the individual LED driver, Maximum current for a single port is 3A.

The overload Indicator light turns completely red when the wattage exceeds 60W for a 12V power supply and 96W for a 24V power supply. Warning the risk of possible damage to the LED driver with high temperature and shortened product life.

**** WARNING:** Using more than 1 receiver on the pink central control ports of a power supply will damage the units and void the manufacturer's warranty. The pink central control ports intended use is for one control component and a linking cord or 2 linking cords.

PowerSync Wireless Controllers

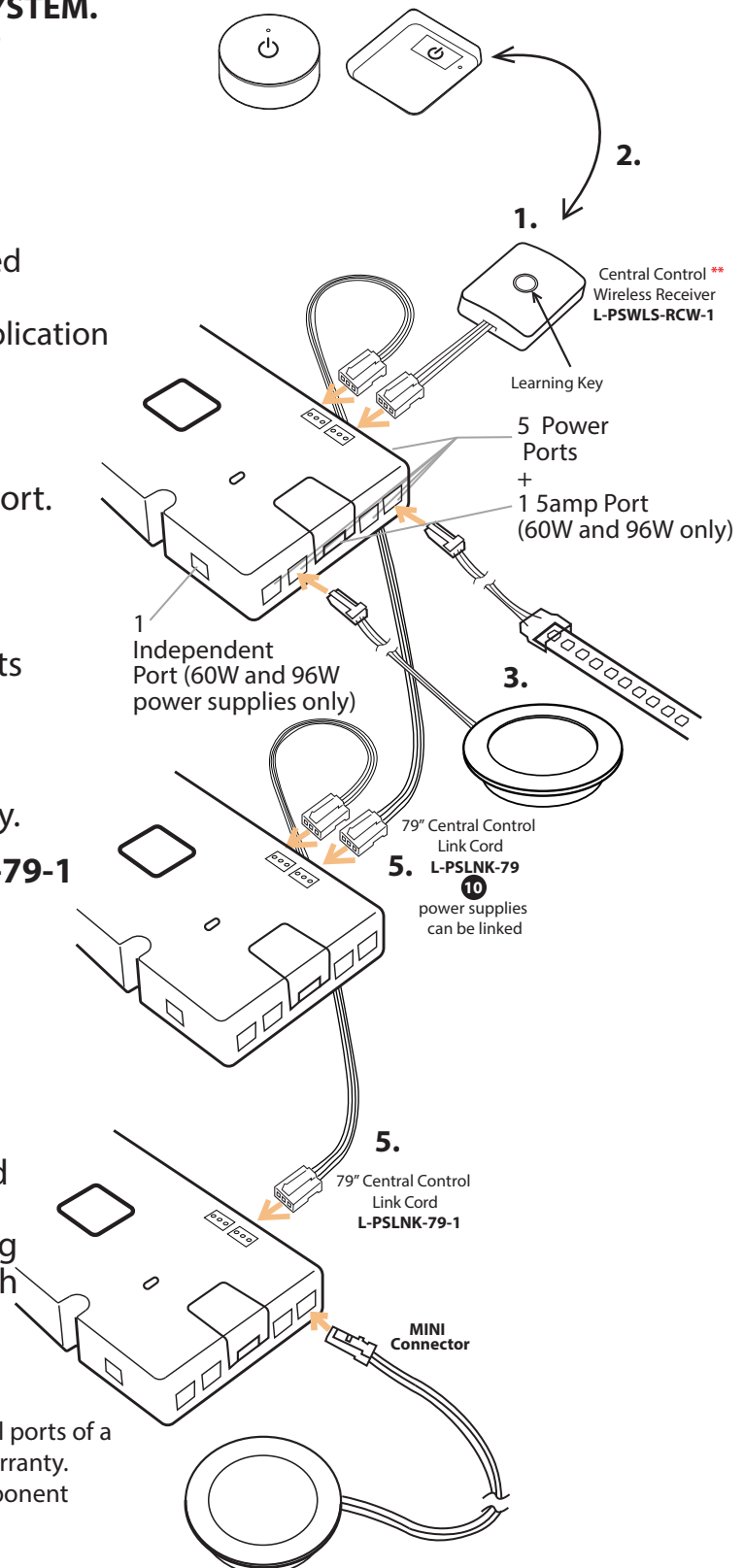

Central Control for Wired Controllers

1. Plug in the **L-PSCTL-CVT-1** to the pink central control port.
2. Then plug in a wired controller to the converter to control the 5 power ports and 1 amp port of the power supply for the 60W or 96W models. Plug in a wired controller to the converter to control all 6 ports of the 36W models.
3. Plug in the lights.
4. Turn the power ON or plug in the power supply.
5. Add up to 10 power supplies with a **L-PSLINK-79-1** the central control link cord.

PowerSync Controllers (Wired)

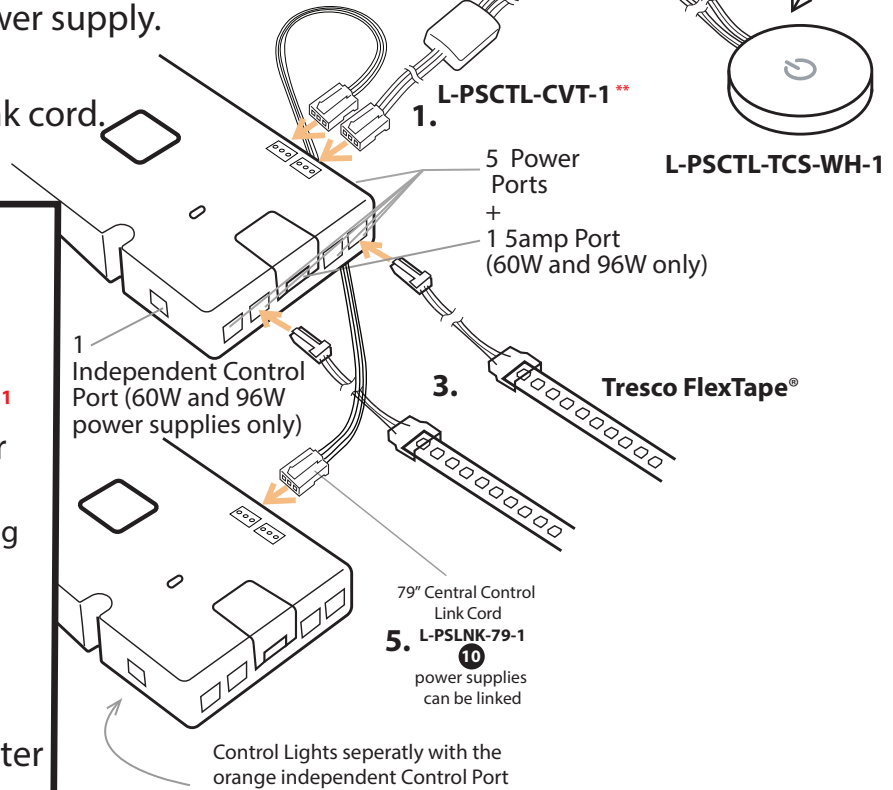
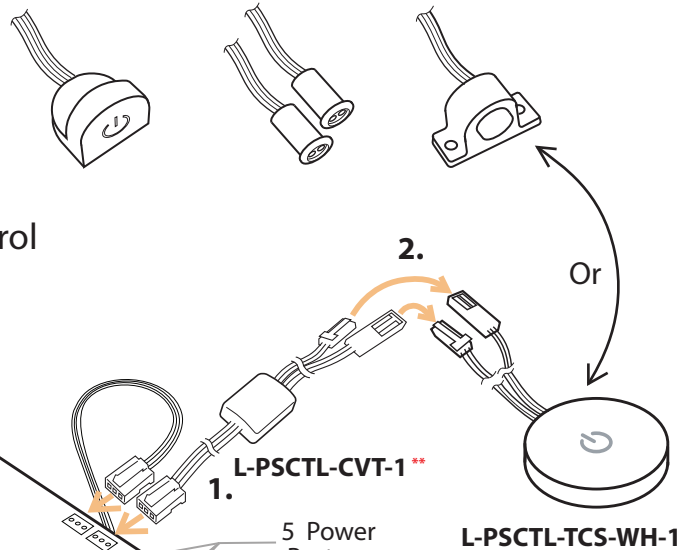

PowerSync Central Control Components

L-PSWLS-RCW-1** see page 1

Wireless Sensor Receiver
12V/24VDC
1 3/8" w X 3/8" h X 3 3/8" long

L-PSCTL-CVT-1**

Wired Controller Converter for wired controllers
12/24VDC
5/8" w X 5/16" h X 6 1/4" long

L-PSLINK-79-1

79" Central Control Link Cord
12/24VDC

**** WARNING:** Using more than 1 convertor on the pink central control ports of a power supply will damage the units and void the manufacturer's warranty.

The pink central control ports intended use is for one control component and a linking cord or 2 linking cords.

Important Safety Instructions

CAUTION:

To reduce the risk of fire, electric shock, or injury

- For dry locations only.
- Secure cords properly; avoid pinching/damage.
- Use only insulated staples or plastic ties to secure cords.
- Use Class 2 or LPS, 12VDC or 24VDC Power Supply.
- Controller outputs: 12VDC (36W max) or 24VDC (72W max).
- Not intended for enclosed installation into ceilings/soffits.
- Licensed electrician required for installation through ceilings/walls.
- Follow all NEC wiring regulations.