

Closet Pole Installation Instructions

(DO NOT DISCARD PLASTIC SLEEVE)

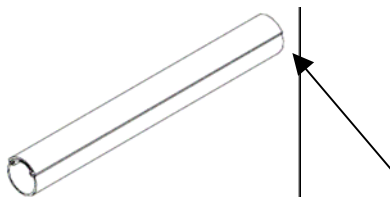

1. First install the pole cups into partitions by snapping and/or screwing in at desired heights.



2. Cut desired inside length of rod.

3. Slide plastic sleeve out 1/2" and cut the 1/2" overhang off.

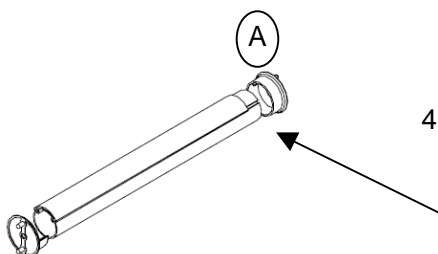

4. Take the end with the 1/2" exposed rod and insert into full circle pole cup. See figure A.

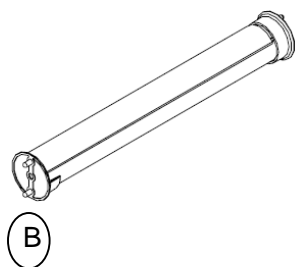

5. After inserting rod into full circle pole cup, simply finish by placing the opposite end of the pole onto half round pole cup. See figure B.



12400 Earl Jones Way Louisville,
KY 40299
rev-a-shelf.com
Customer Service: 800-626-1126