



|                |      |
|----------------|------|
| Customer Name  | Date |
| Project Name   |      |
| Catalog Number |      |



## MONTAGE SERIES

### Recessed Multiples | 1x2

The **Montage Series** of luminaires is the ideal recessed counterpart to Tela Mini, sharing the same performance, features and family aesthetic. Available in flange and flange-free configurations, the Montage Series is designed for new construction and retrofit in both T-Grid and hard ceilings.

### CONSTRUCTION

|                          |  |
|--------------------------|--|
| <b>Housing:</b>          | Die-cast and precision machined head                           |
| <b>Lens:</b>             | Custom designed spot optical system optimizes CBCP             |
| <b>Optical Assembly:</b> | Silicone optic with high thermal resistance prevents yellowing |
| <b>Paint:</b>            | Textured powder coat finish                                    |
| <b>Weight:</b>           | 8.2 lbs. (3.7kg.)  |

### CONTROLS

|                          |                  |
|--------------------------|------------------|
| <b>Standard Dimming:</b> | 0–10VDC, Dimming |
|--------------------------|------------------|

### AMBIENT TEMPERATURE

| TYPE                          | TEMPERATURE RATE           |
|-------------------------------|----------------------------|
| <b>Operating Temperature:</b> | -20C to +30C (-4F to +86F) |

### OPTICAL SYSTEM

|                     |   |
|---------------------|---|
| <b>Lumens:</b>      | Up to 2640 lumens   |
| <b>Distribution</b> | Spot (15°), Narrow Flood (18°), Flood (25°), Wide Flood (35°) |
| <b>Efficacy:</b>    | Up to 70 LPW  |
| <b>Wattage:</b>     | Up to 38 watts  |
| <b>CCT:</b>         | 2700K, 3000K, 3500K, 4000K                                    |
| <b>CRI:</b>         | 80 CRI, 90 CRI  |

### LUMEN MAINTENANCE

|                         |
|-------------------------|
| <b>LXX(10K) @ HOURS</b> |
| <b>50,000 HR</b>        |
| L85                     |

### MOUNTING

- Standalone rough-in kit for installation in finished and t-grid ceilings.

### ELECTRICAL

|   |                |
|---|----------------|
| <b>Input Voltage:</b>                   | 120–277V       |
| <b>Input Frequency:</b>                 | 50/60Hz        |
| <b>Standard Dimming Control:</b>        | 0–10V, Dimming |
| <b>Power Factor (PF):</b>               | >0.9*          |
| <b>Total Harmonic Distortion (THD):</b> | <20%*          |

\*PF and THD may vary with options

### DESIGN LIFE & WARRANTY

- UL Listed and Energy Star rated.
- **Current's Limited 5-year Warranty:** Please refer to [IND599](#) in the Product Downloads section.



# MONTAGE SERIES

Recessed Multiples | 1x2



|                |      |
|----------------|------|
| Customer Name  | Date |
| Project Name   |      |
| Catalog Number |      |

## Ordering Information

Important: Must order LMM Fixture + LMM Rough-in Kit, Both parts required for complete installation.

**LMM 2 A 0 9 V Q D**

| FAMILY                                   | FIXTURE TYPE                                      | GENERATION                     | VOLTAGE      | NOMINAL LUMENS  | DISTRIBUTION  | CRI                       | CCT  | DIMMING           | CONTROLS | MOUNTING                   | FINISH   | DIFFUSER   | OPTIONS  |
|--|---|--------------------------------|--------------|---|---|---------------------------|--|-------------------|----------|----------------------------|--|--|--|
| LMM = Lumination Recessed Mini Multiples | S2 = Semi-Recessed 2 Head<br>R2 = Recessed 2 Head | A = 1 <sup>st</sup> Generation | 0 = 120-277V | 09 = 950 Lumens<br>11 = 1150 Lumens<br>13 = 1375 Lumens | SP = Spot (15°)<br>NF = Narrow Flood (18°)<br>FL = Flood (25°)<br>WF = Wide Flood (35°) | 8 = 80 CRI<br>9 = 90+ CRI | 27 = 2700K<br>30 = 3000K<br>35 = 3500K<br>40 = 4000K | V = 0-10V Dimming | Q = None | TR = Trim<br>XT = Trimless | WHITE = White<br>BLCK = Black<br>SLVR = Silver | DXX = None<br>D03 = 3.5° Diffuser<br>D05 = 5° Diffuser<br>D07 = 7.5° Diffuser<br>D10 = 10° Diffuser<br>D20 = 20° Diffuser<br>DL6 = 60° X 10° Diffuser<br>DL3 = 30° X 3° Diffuser | (blank) = None<br>HX = Hexcel<br>SN = Snoot<br>HS = Snoot + Hexcel |

### CLAIMS - BASED ON 3000K

| CONFIGURATION             | FIXTURE LUMENS | FIXTURE WATTS | FIXTURE LPW | LUMENS PER HEAD |
|---------------------------|----------------|---------------|-------------|-----------------|
| 2-Head, Standard White 09 | 1900           | 22            | 85          | 950             |
| 2-Head, Standard White 11 | 2300           | 29            | 80          | 1150            |
| 2-Head, Standard White 13 | 2640           | 38            | 70          | 1320            |

### LMM ROUGH-IN KIT

| MATERIAL | MATERIAL DESCRIPTION | PRODUCT DESCRIPTION            |
|----------|----------------------|--------------------------------|
| 93039497 | LMMRK2A1             | LMM Rough-In Kit, 2 Head, 120V |
| 93039502 | LMMRK2A4             | LMM Rough-In Kit, 2 Head, 277V |

### FIELD-INSTALLABLE OPTICAL ACCESSORIES

| MATERIAL | MATERIAL DESCRIPTION | PRODUCT DESCRIPTION         |
|----------|----------------------|-----------------------------|
| 93026378 | LT MDF035            | LTM 3.5° Diffuser           |
| 93026529 | LT MDF05             | LTM 5° Diffuser             |
| 93026530 | LT MDF075            | LTM 7.5° Diffuser           |
| 93026901 | LT MDF10             | LTM 10° Diffuser            |
| 93026902 | LT MDF20             | LTM 20° Diffuser            |
| 93026903 | LT MDF30             | LTM 30° Diffuser            |
| 93026904 | LT MDF6010           | LTM 60°x10° Linear Spreader |
| 93026905 | LT MDF303            | LTM 30°x3° Linear Spreader  |
| 93026697 | LTMSNWHITE           | LTM White Snoot             |
| 93026906 | LTMSNBLCK            | LTM Black Snoot             |
| 95019410 | LTMSNSLVR            | LTM Silver Snoot            |
| 93026696 | LTMHX                | LTM Hexcel Louver           |

# MONTAGE SERIES

Recessed Multiples | 1x2



|                |      |
|----------------|------|
| Customer Name  | Date |
| Project Name   |      |
| Catalog Number |      |

## Dimensions

### TRIM

#### SEMI-RECESSED

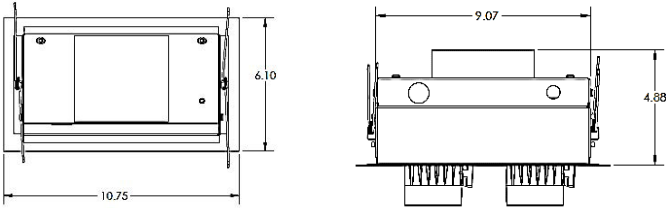

### TRIMLESS

#### SEMI-RECESSED

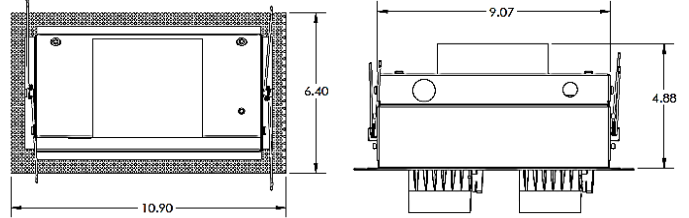

#### FULLY-RECESSED

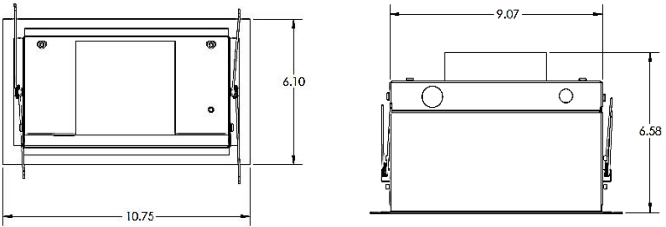

#### FULLY-RECESSED

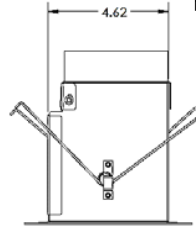
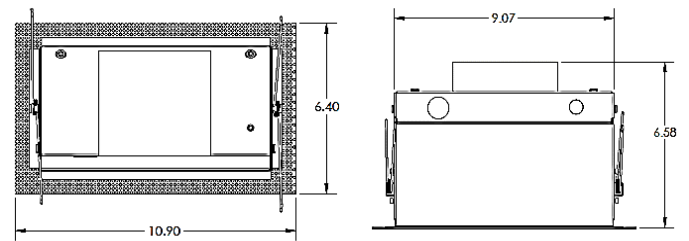

Width is same for both Semi-Recessed and Fully-Recessed

## ROUGH IN KIT INFORMATION

| MATERIAL | MATERIAL DESCRIPTION | PRODUCT DESCRIPTION            |
|----------|----------------------|--------------------------------|
| 93039497 | LMMRK2A1             | LMM Rough-In Kit, 2 Head, 120V |
| 93039502 | LMMRK2A4             | LMM Rough-In Kit, 2 Head, 277V |

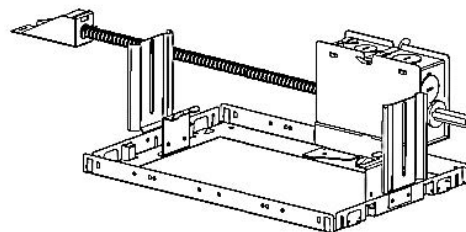
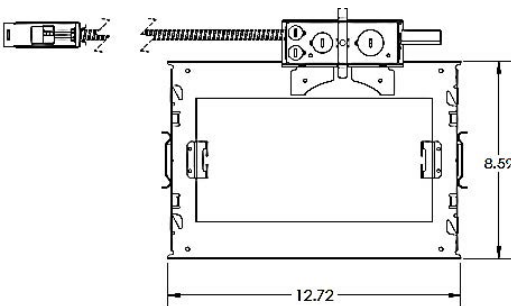
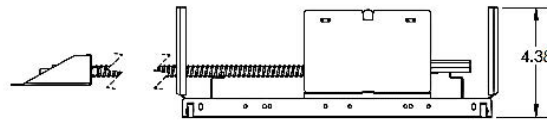

# MONTAGE SERIES

Recessed Multiples | 1x2



|                |      |
|----------------|------|
| Customer Name  | Date |
| Project Name   |      |
| Catalog Number |      |

## Photometrics

**20 Watt**  
1320 Lumens per head

Spot Flood Distribution  
15° Beam

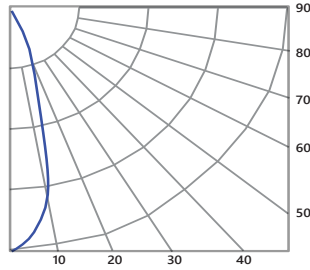

| CANDLEPOWER SUMMARY |         |
|---------------------|---------|
| Angle               | Candela |
| 0                   | 12243   |
| 5                   | 9730    |
| 15                  | 1059    |
| 25                  | 102     |
| 35                  | 62      |
| 45                  | 26      |
| 55                  | 15      |

| CONE OF LIGHT |     |           |
|---------------|-----|-----------|
| Height        | fc  | Dia. (ft) |
| 6             | 340 | 1.7       |
| 8             | 191 | 2.3       |
| 10            | 123 | 2.9       |
| 12            | 85  | 3.5       |
| 14            | 62  | 4.1       |
| 16            | 48  | 4.6       |

**20 Watt**  
1320 Lumens per head

Narrow Flood Distribution  
18° Beam

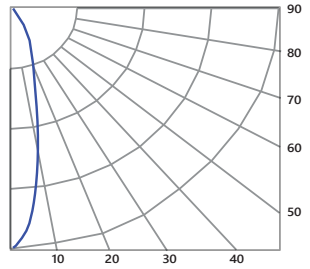

| CANDLEPOWER SUMMARY |         |
|---------------------|---------|
| Angle               | Candela |
| 0                   | 8919    |
| 5                   | 7045    |
| 15                  | 1478    |
| 25                  | 188     |
| 35                  | 77      |
| 45                  | 39      |
| 55                  | 21      |

| CONE OF LIGHT |     |           |
|---------------|-----|-----------|
| Height        | fc  | Dia. (ft) |
| 6             | 248 | 2.0       |
| 8             | 139 | 2.7       |
| 10            | 89  | 3.4       |
| 12            | 62  | 4.0       |
| 14            | 45  | 4.7       |
| 16            | 35  | 5.4       |

**20 Watt**  
1320 Lumens per head

Flood Distribution  
25° Beam

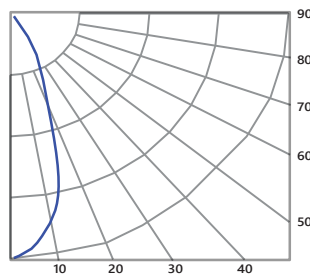

| CANDLEPOWER SUMMARY |         |
|---------------------|---------|
| Angle               | Candela |
| 0                   | 4893    |
| 5                   | 4638    |
| 15                  | 2291    |
| 25                  | 439     |
| 35                  | 135     |
| 45                  | 60      |
| 55                  | 30      |

| CONE OF LIGHT |     |           |
|---------------|-----|-----------|
| Height        | fc  | Dia. (ft) |
| 6             | 136 | 2.8       |
| 8             | 77  | 3.8       |
| 10            | 49  | 4.7       |
| 12            | 34  | 5.7       |
| 14            | 25  | 6.6       |
| 16            | 19  | 7.6       |

## STANDARD LED CONVERSION TABLE

Lumen and CBCP output varies based on Wattage, CCT and CRI. Table below is based on 3000K, 80 CRI fixture. To estimate lumen and CBCP output of other combinations, multiply photometric data by factors below.

| 827  | 830 | 835  | 840  | 927 | 930  | 935  | 940  |
|------|-----|------|------|-----|------|------|------|
| 0.95 | 1   | 1.03 | 1.05 | 0.8 | 0.83 | 0.85 | 0.87 |

For Product or Technical Questions:

E: [lightingproinfo@gecurrent.com](mailto:lightingproinfo@gecurrent.com)  
T: +1 888 694 3533, OPTION 2