

# Lumination® LMM Series

LED Track Light Recessed Multiples  
3 Head Trim & Trimless



CUSTOMER NAME \_\_\_\_\_

Project Name \_\_\_\_\_

Date \_\_\_\_\_ Type \_\_\_\_\_

Catalog Number \_\_\_\_\_

The Lumination® LMM Series - 3 Head LED Luminaire is a match in a recessed multiple format to the LTM Track Light with the same high performance and depth of product offering. The Lumination® LMM LED platform offers long life and high efficiency to minimize operating and maintenance costs.

## CONSTRUCTION

- Housing:** Die-cast and precision machined head
- Lens:** Custom designed spot optical system optimizes CBCP
- Paint:** Textured powder coat finish
- Weight:** 10.6 lbs. (4.8kg.)
- Optical Assembly:** Silicone optic with high thermal resistance prevents yellowing

## OPTICAL SYSTEM

- Lumens:** Up to 3960 lumens
- Distribution:** Spot (15°), Narrow Flood (18°), Flood (25°)
- Wattage:** Up to 54 watts
- Efficacy:** Up to 86 LPW
- CCT:** 2700K, 3000K, 3500K, 4000K
- CRI:** 80 CRI , 90 CRI

## ELECTRICAL

- Input Voltage:** 120-277V
- Input Frequency:** 50/60 Hz
- Standard Dimming Control:** 0-10V, Dimming
- Power Factor (PF)\*:** > 0.9%
- Total Harmonic Distortion (THD)\*:** < 20%

\* PF and THD may vary with options

## CONTROLS

**Dimming:** 0-10V, Dimming

## LUMEN AMBIENT TEMPERATURE

TYPE	TEMPERATURE RATE
OPERATING TEMPERATURE	-20C to +30C (-4F to +86F)

## LUMEN MAINTENANCE

LXX(10K) @ Hours 50,000 HR
L85

## MOUNTING

- Standalone rough-in kit for installation in finished and t-grid ceilings

## DESIGN LIFE & WARRANTY

- UL Listed and Energy Star rated
- Current's Limited 5-year Warranty:  
Please refer to document **IND599** for more information.



# Lumination® LMM Series

LED Track Light Recessed Multiples  
3 Head Trim & Trimless

## Ordering Information

### CUSTOMER NAME

Project Name \_\_\_\_\_

Date \_\_\_\_\_ Type \_\_\_\_\_

Catalog Number \_\_\_\_\_

**Ordering Information** (Important: Must order LMM Fixture + LMM Rough-in Kit, Both parts required for complete installation.):

**LMM 3 A 0 V Q D**

FAMILY	FIXTURE TYPE	GENERATION	VOLTAGE	NOMINAL LUMENS	DISTRIBUTION	CRI	CCT	DIMMING	CONTROLS	MOUNTING	FINISH	DIFFUSER	OPTIONS
<b>LMM=</b> Lumination Recessed Mini Multiples	<b>S3=</b> Semi- Recessed 3 Head <b>R3=</b> Recessed 3 Head	<b>A=</b> 1 <sup>st</sup> Generation	<b>0=</b> 120- 277V	<b>09=</b> 950 lm <b>11=</b> 1150 lm <b>13=</b> 1375 lm	<b>SP=</b> Spot (15°) <b>NF=</b> Narrow Flood (18°) <b>FL=</b> Flood (25°)	<b>8=</b> 80 <b>9=</b> 90	<b>27=</b> 2700K <b>30=</b> 3000K <b>35=</b> 3500K <b>40=</b> 4000K	<b>V=</b> 0-10V Dimming	<b>Q=</b> None	<b>TR=</b> Trim <b>XT=</b> Trimless	<b>WHITE=</b> White <b>BLCK=</b> Black <b>SLVR=</b> Silver	<b>DXX=</b> None <b>D03=</b> 3.5°Diffuser <b>D05=</b> 5°Diffuser <b>D07=</b> 7.5°Diffuser <b>D10=</b> 10°Diffuser <b>D20=</b> 20°Diffuser <b>DL6=</b> 60°x10° Diffuser <b>DL3=</b> 30°x3° Diffuser	<b>(blank)=</b> None <b>HX=</b> Hexcel <b>SN=</b> Snoot <b>HS=</b> Snoot + Hexcel

### Claims - based on 3000K

CONFIGURATION	FIXTURE LUMENS	FIXTURE WATTS	FIXTURE LPW	LUMENS PER HEAD
3-Head, Standard White 09	2850	33	86	950
3-Head, Standard White 11	3450	43	80	1150
3-Head, Standard White 13	3960	54	73	1320

### LMM Rough-In Kit

MATERIAL	MATERIAL DESCRIPTION	PRODUCT DESCRIPTION
93039498	LMMRK3A1	LMM Rough-In Kit, 3 Head, 120V
93039503	LMMRK3A4	LMM Rough-In Kit, 3 Head, 277V

### Field-installable Optical Accessories

MATERIAL	MATERIAL DESCRIPTION	PRODUCT DESCRIPTION
93026378	LT MDF035	LTM 3.5°Diffuser
93026529	LT MDF05	LTM 5°Diffuser
93026530	LT MDF075	LTM 7.5°Diffuser
93026901	LT MDF10	LTM 10°Diffuser
93026902	LT MDF20	LTM 20°Diffuser
93026903	LT MDF30	LTM 30°Diffuser
93026904	LT MDF6010	LTM 60°x10°Linear Spreader
93026905	LT MDF303	LTM 30°x3°Linear Spreader
93026697	LTMSNWHITE	LTM White Snoot
93026906	LTMSNBLCK	LTM Black Snoot
95019410	LTMSNSLVR	LTM Silver Snoot
93026696	LTMHX	LTM Hexcel Louver

# Lumination® LMM Series

LED Track Light Recessed Multiples  
3 Head Trim & Trimless

## Photometric Data

### CUSTOMER NAME

Project Name \_\_\_\_\_

Date \_\_\_\_\_ Type \_\_\_\_\_

Catalog Number \_\_\_\_\_

### STANDARD LED CONVERSION TABLE

Lumen and CBCP output varies based on Wattage, CCT and CRI. Table below is based on 3000K, 80 CRI fixture. To estimate lumen and CBCP output of other combinations, multiply photometric data by factors below.

827	830	835	840	927	930	935	940
0.95	1	1.03	1.05	0.8	0.83	0.85	0.87

### PHOTOMETRIC DATA

20 Watt -1320 Lumens per head  
Spot Flood Distribution -15°Beam

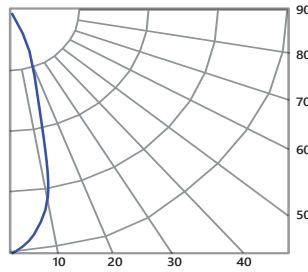

CANDLEPOWER SUMMARY	
Angle	Candela
0	12243
5	9730
15	1059
25	102
35	62
45	26
55	15

CONE OF LIGHT		
Height	fc	Dia. (ft)
6	340	1.7
8	191	2.3
10	123	2.9
12	85	3.5
14	62	4.1
16	48	4.6

20 Watt -1320 Lumens per head  
Narrow Flood Distribution -18°Beam

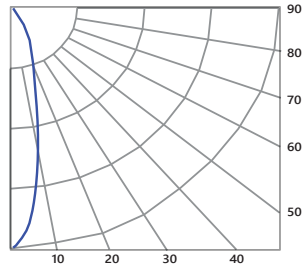

CANDLEPOWER SUMMARY	
Angle	Candela
0	8919
5	7045
15	1478
25	188
35	77
45	39
55	21

CONE OF LIGHT		
Height	fc	Dia. (ft)
6	248	2.0
8	139	2.7
10	89	3.4
12	62	4.0
14	45	4.7
16	35	5.4

20 Watt -1320 Lumens per head  
Flood Distribution -25°Beam

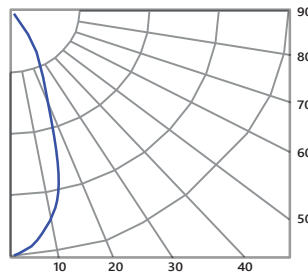

CANDLEPOWER SUMMARY	
Angle	Candela
0	4893
5	4638
15	2291
25	439
35	135
45	60
55	30

CONE OF LIGHT		
Height	fc	Dia. (ft)
6	136	2.8
8	77	3.8
10	49	4.7
12	34	5.7
14	25	6.6
16	19	7.6

# Lumination® LMM Series

LED Track Light Recessed Multiples  
3 Head Trim & Trimless

## Dimensions

### CUSTOMER NAME

Project Name \_\_\_\_\_

Date \_\_\_\_\_ Type \_\_\_\_\_

Catalog Number \_\_\_\_\_

### TRIM

#### Semi-Recessed

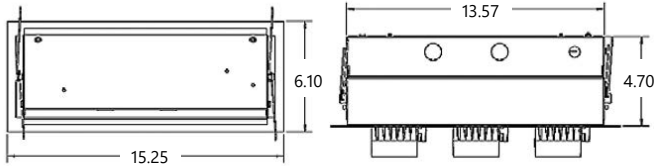

#### Fully-Recessed

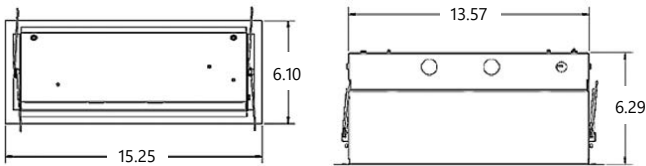

### TRIMLESS

#### Semi-Recessed

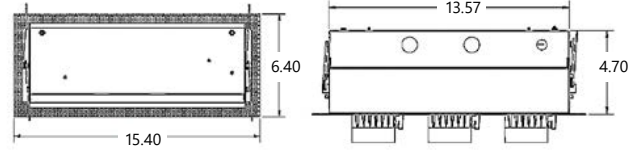

#### Fully-Recessed

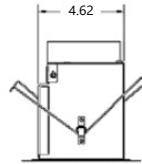
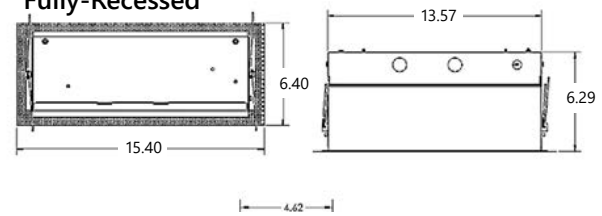

Width is same for both Semi-Recessed and Fully-Recessed

### ROUGH IN KIT INFORMATION

MATERIAL	MATERIAL DESCRIPTION	PRODUCT DESCRIPTION
93039498	LMMRK3A1	LMM Rough-In Kit, 3 Head, 120V
93039503	LMMRK3A4	LMM Rough-In Kit, 3 Head, 277V

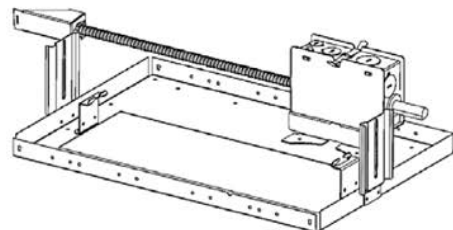
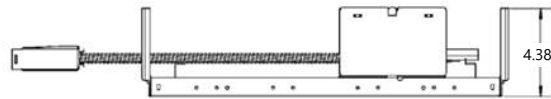
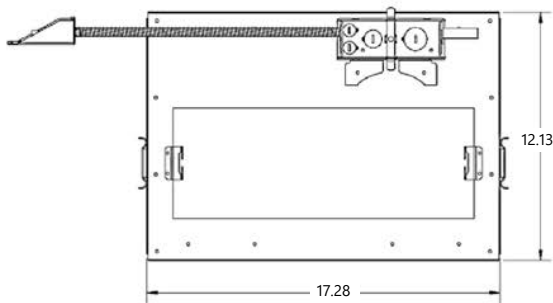

### For Product or Technical Questions:

Email: [lightingprodinfo@gecurrent.com](mailto:lightingprodinfo@gecurrent.com)

Phone: +1 888 694 3533, option 2