

19014A-LED 4" Shallow New Construction Housing

The 19014A-LED is a compact and efficient shallow recessed housing, boasting a slim profile of just 3.5 inches, specifically designed for 4" shallow insulated ceilings. This ultra-thin construction is ideal for tight plenum spaces where depth is limited, ensuring easy installation without compromising on performance. With an insulated ceiling rating and an air-tight design, this housing guarantees optimal performance and energy efficiency. Constructed from durable galvanized steel, it offers long-lasting quality. The 19014A-LED features quick-connect wiring for easy installation of LED downlights, along with a pre-installed real nail for straightforward installation on standard wood lumber or engineered wood lumber. Its adjustable bar hangers, ranging from 13-5/8" up to 25", can be repositioned 90 degrees on the plaster frame, providing versatility for various installation needs.

19014AR-LED 4" Shallow Remodel Housing

The 19014AR-LED is a compact and efficient shallow recessed housing designed specifically for 4" aperture sizes in shallow insulated ceilings, making it ideal for remodeling construction projects. With a shallow housing of just 3.5", it's perfect for accommodating tight plenum spaces. This insulation contact rated housing features an air-tight design to help maintain energy efficiency, while the quick-connect wiring enables easy installations. Additionally, the housing includes four remodel clips to secure it and can adjust from 5/8" to 1-3/8" to accommodate practical choice for your lighting needs.

Compact Design

Both models measure just under 3.5" in overall height to fit where other housings can't.



Quick-Connect

Attaches directly to modern LED downlights to make installation a breeze.

IC-Rated & Airtight

Both models are insulation contact rated & airtight to keep spaces insulated & efficient.

Fully Extendable Brackets

Hanger bars adjust from 13.6" to 25"



Unique Brackets

Each bracket can swivel up to 90° making installation a one-person job.

Pre-Set Nails

Just hammer & move on

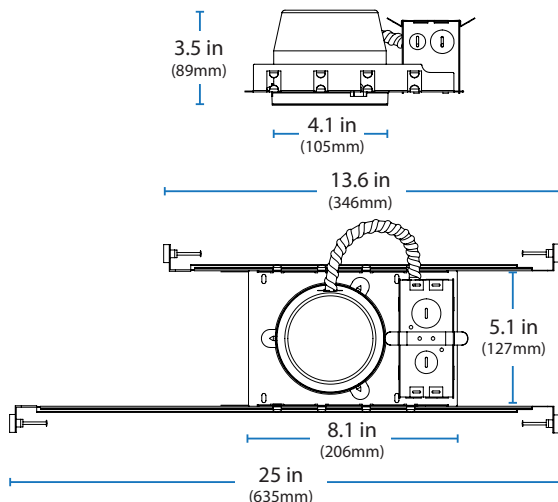

Versatile & Practical

4 remodel clips secure the housing tightly against the ceiling. Accommodates ceilings between 0.5" and 0.625" thick.

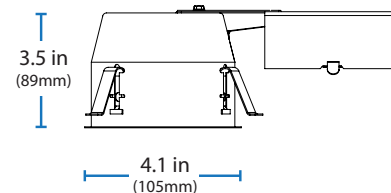
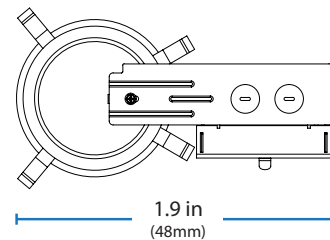
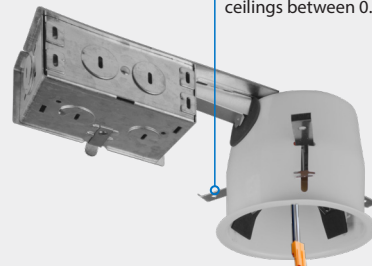

Ordering Information

Example: 19014A-LED

Series	Product Description
19014A-LED	4" IC-Rated, Airtight, Line Voltage New Construction Housing



Ordering Information

Example: 19014AR-LED

Series	Product Description
19014AR-LED	4" IC-Rated, Airtight, Line Voltage Remodel Housing